

Notes:

DO NOT SCALE FROM DRAWING.

ALL DIMENSIONS TO BE CONFIRMED ON SITE.

The intention is to divide 14, 16 and 18 Monmouth Street back into three separate units, as they originally were. The basement of 16 is to be accessed via a new staircase to the front of the unit.

All works will be performed carefully to retain the existing appearance of the property, which has little to none of the original interior.

rev c	staircase amended	09/05/07
rev b	to also show proposal at no. 14	03/04/07
rev a	to include section BB	

Basement and Ground Floor Plans and Section BB as Proposed

14 & 16 Monmouth St London WC2

Listed Building Application

Feb 2007

1:100 @ A3

Shaftesbury Covent Garden Ltd

FRESSON & TEE
CHARTERED SURVEYORS

1 SANDWICH STREET
LONDON WC1H 9PF

Tel: (020) 7391 7100 Fax: (020) 7391 7121

18706-12c

Section BB

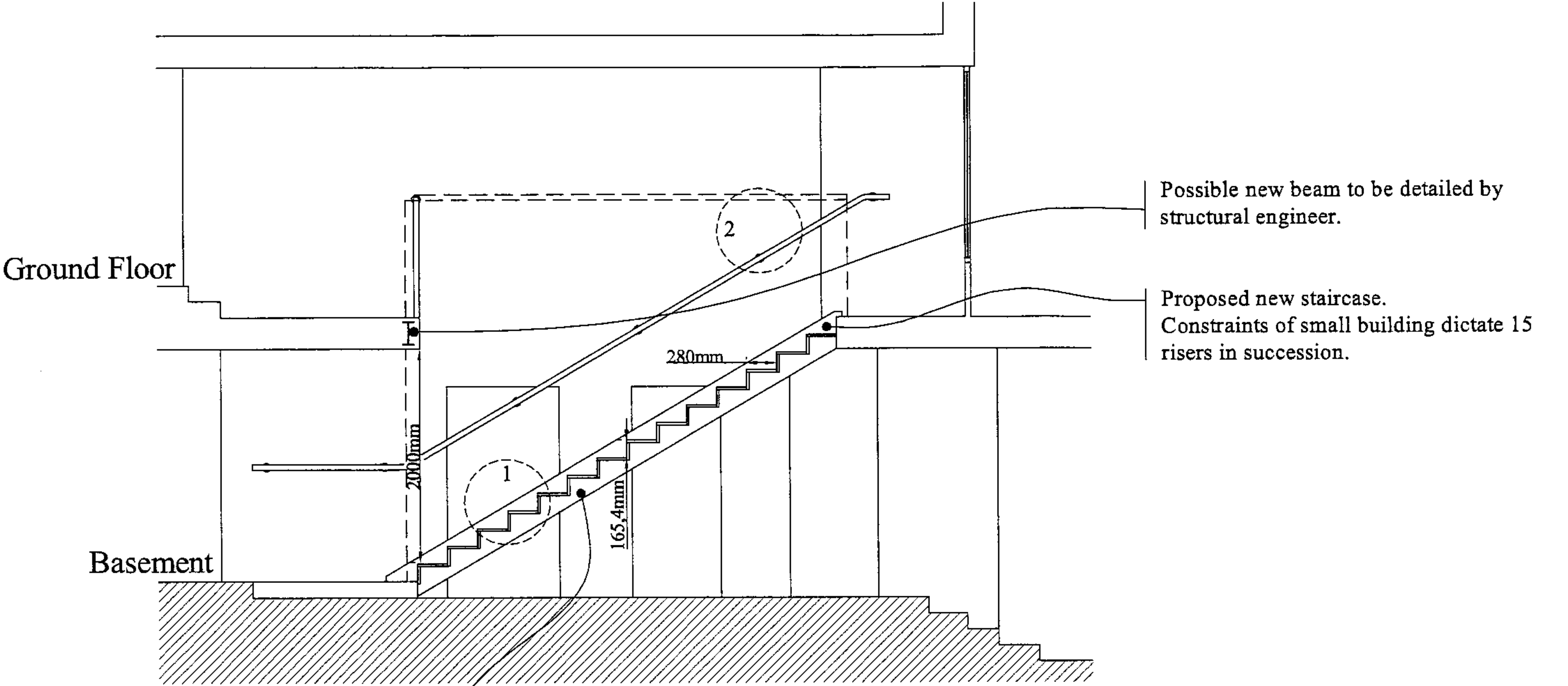

Notes:

DO NOT SCALE FROM DRAWING.

ALL DIMENSIONS TO BE CONFIRMED ON SITE.

The intention is to divide 14, 16 and 18 Monmouth Street back into three separate units, as they originally were.

The basement of 16 is to be accessed via a new staircase to the front of the unit.

All works will be performed carefully to retain the existing appearance of the property, which has little to none of the original interior.

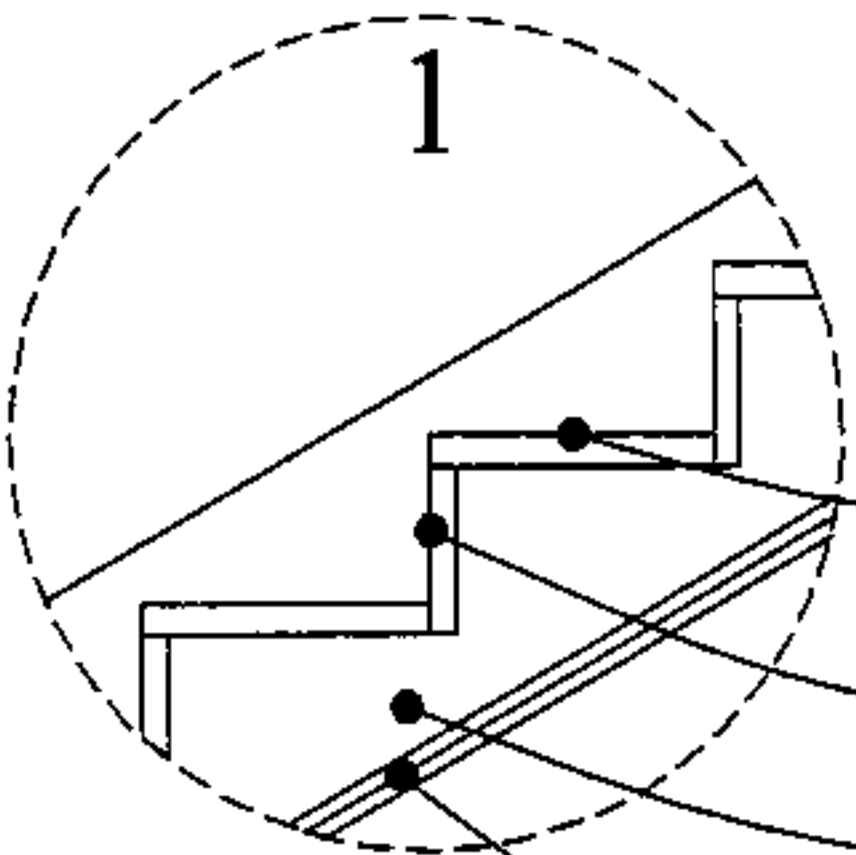

1:20 DETAILS

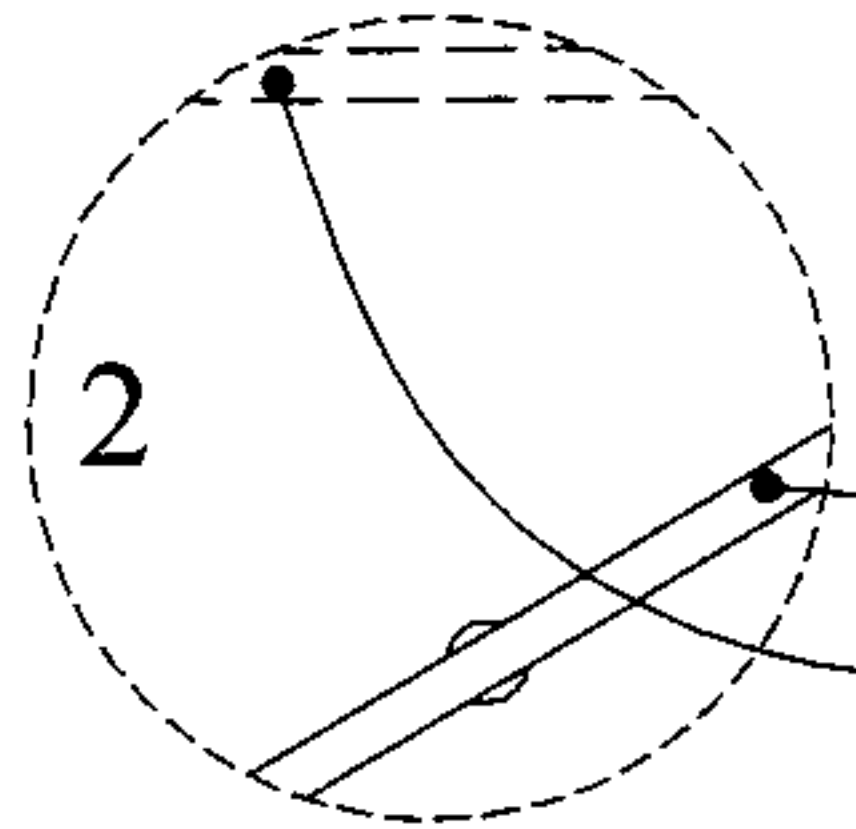

- The new staircase at no.16 will be of softwood timber construction, 1000mm wide, with minimum 2000mm headroom above pitch.
- Treads are to be minimum 280mm going in 32mm thick softwood.
- Risers are to be maximum 170mm high in 25mm thick softwood.
- Strings are to be formed from 38mm thick softwood.
- 2no. layers of 15mm fireline boarding are to be fixed to the underside of the staircase to provide 1.5h fire protection. The joints are to be staggered, scrimmed and with a set coat applied.
- The stair is then to be left unpainted in readiness for the incoming tenant.
- A 50mm diameter timber handrail is to be fixed 1000mm above the pitch of the stair and 1100mm above the top landing to a newly formed partition from the staircase to 1100mm above the top landing.
- This partition is to consist of 12.5mm fireline board fitted to both sides of 75 x 50mm softwood timber studwork with scrimmed joints and noggings at maximum 1000mm centres.
- All wood work is to be primed, sealed and painted with eggshell to match the existing surrounding surfaces.
- Any other areas disturbed by the works are to be made good.

DRAWING TITLE	
Enlarged Section BB as Proposed	
ADDRESS	
14 & 16 Monmouth St London WC2	
PROJECT NAME	DATE
Listed Building Application	May 2007
SCALE	DRAWN BY
1:50 @ A3	
CLIENT	DRAWING NO.
Shaftesbury Covent Garden Ltd	
18706-14	
FRESSON & TEE CHARTERED SURVEYORS 1 SANDWICH STREET LONDON WC1H 9PF Tel: (020) 7391 7100 Fax: (020) 7391 7121	