

South elevation (a-a) as proposed  
showing whole building 1:200

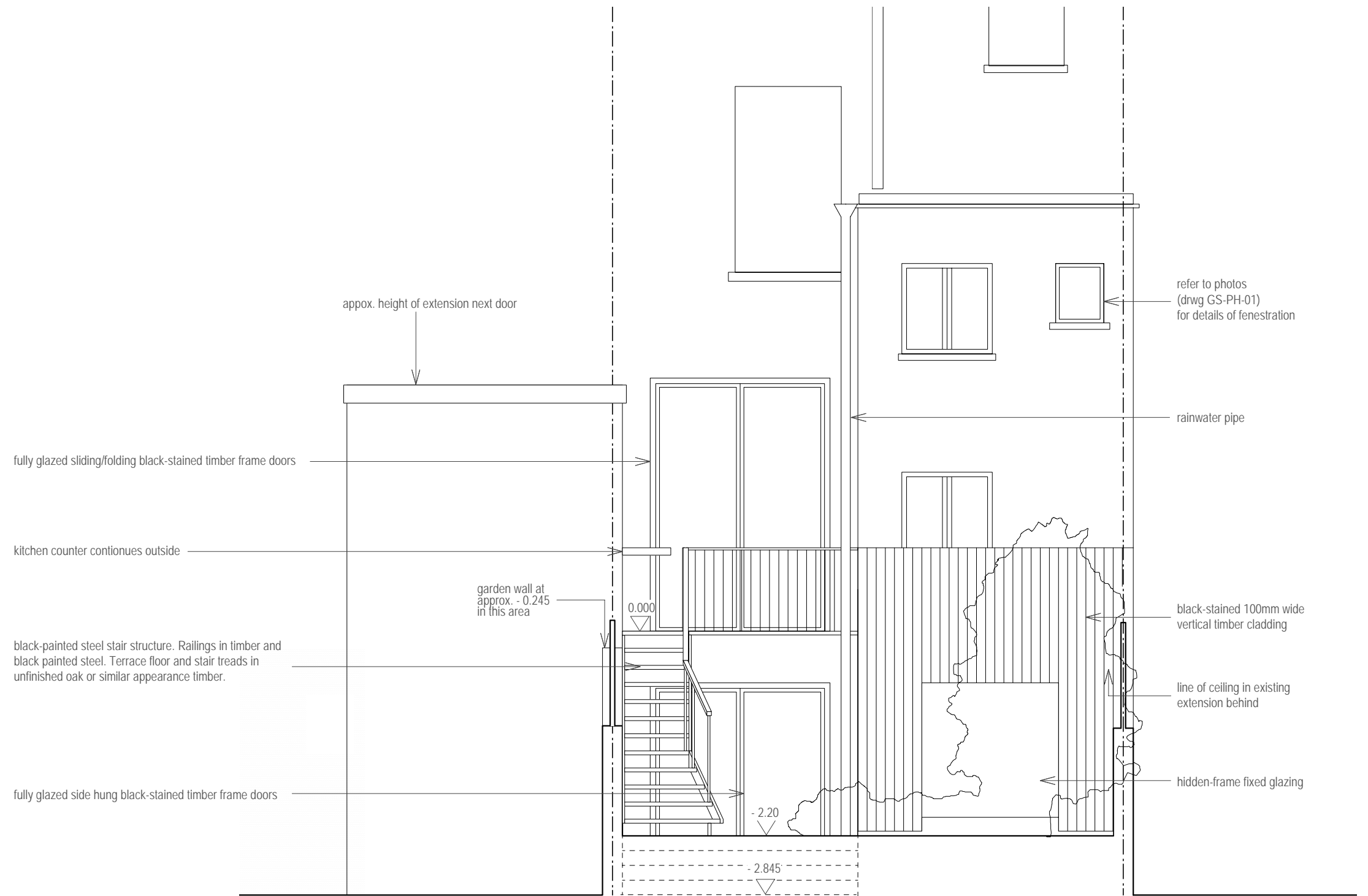

South elevation (a-a) as proposed 1:50

transient  
crabstudio  
50a rosebery avenue  
london ec1r 4rp  
t +44 (0)20 7837 8399

— · — site boundary

NOTE:  
This drawing is for information only. Do not scale from this drawing.

job: 97a Gaisford Street, NW5 2EG  
client: Joanna Parker & Dan Travers  
drg no: GS-PP-03  
title: south elevation (a-a) as proposed  
scale: 1:200+1:50 @ A3  
date: 24.07.07