

1st Floor Bathroom Window Elevations and Section

Note

The window arrangements currently shown is for the first floor bathroom. The window sizes and reveal details vary throughout the property.

Window Elevations (1:20 Scale)

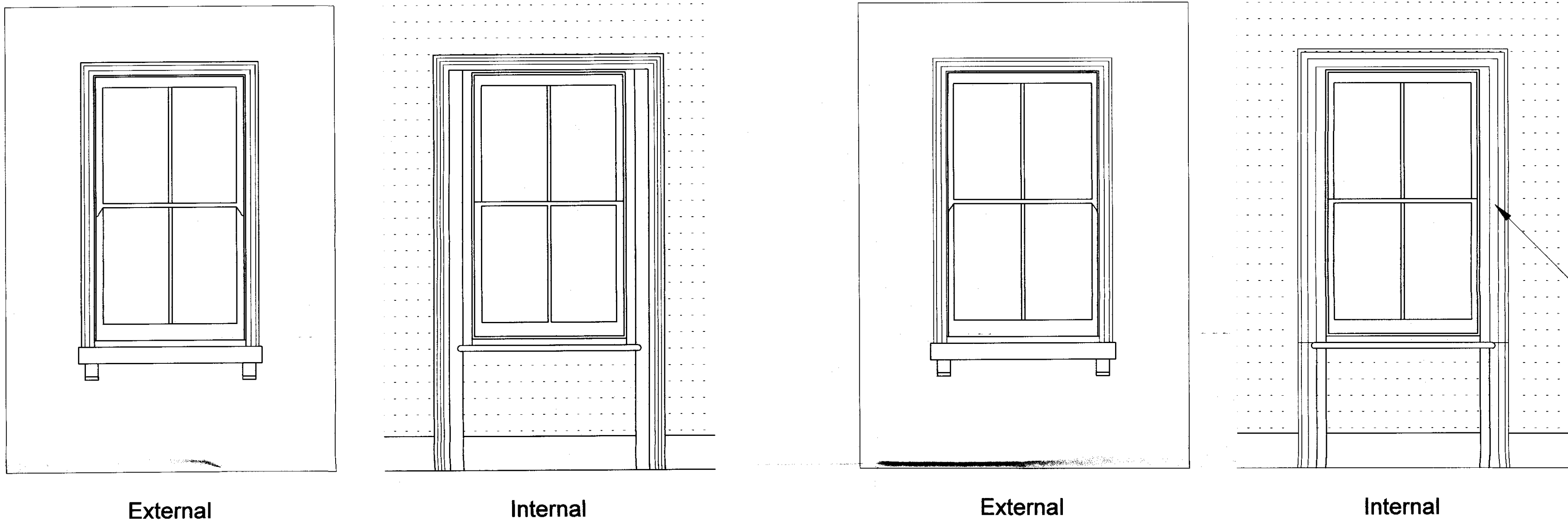

External

Internal

External

Internal

EXISTING

PROPOSED
(MH Joinery 'Kensington' double glazed
timber sash window)

Typical Window Sections (1:10 Scale)

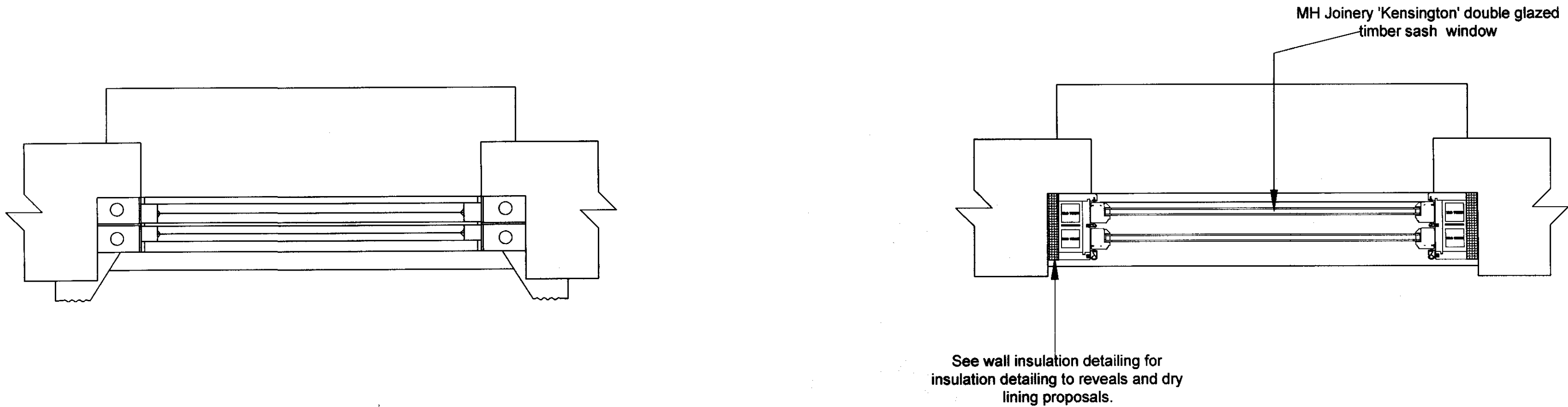

EXISTING

PROPOSED

REVISION A - AMENDMENTS 7/07

CONTRACTORS TO VERIFY ALL DIMENSIONS ON SITE BEFORE COMMENCING ANY WORKS OR PREPARING SHOP DRAWINGS. ALL WORK MUST COMPLY WITH RELEVANT AUTHORITIES REQUIREMENTS. DIMENSIONS MUST NOT BE SCALED FROM THIS PRINT

LANDERS
AND ASSOCIATES

Architecture, Building Surveying, Interior Design, Building Defects and
Project Co-ordination
RAPIER HOUSE, 40-46 LAMBS CONDUIT STREET
LONDON WC1N 3LJ
TEL: 020 7831 6311 FAX: 020 7831 1826

Client THE LONDON BOROUGH OF CAMDEN

Job 17 ST AUGUSTINE'S ROAD, LONDON NW1

Drawing WINDOW SECTIONS & ELEVATIONS

Scale AS SHOWN | Date APRIL 07 | Drawn RG | Checked RS

Drawing No. C06199/07 (REV A)