

DETAIL THROUGH MOULDINGS AT 1:1

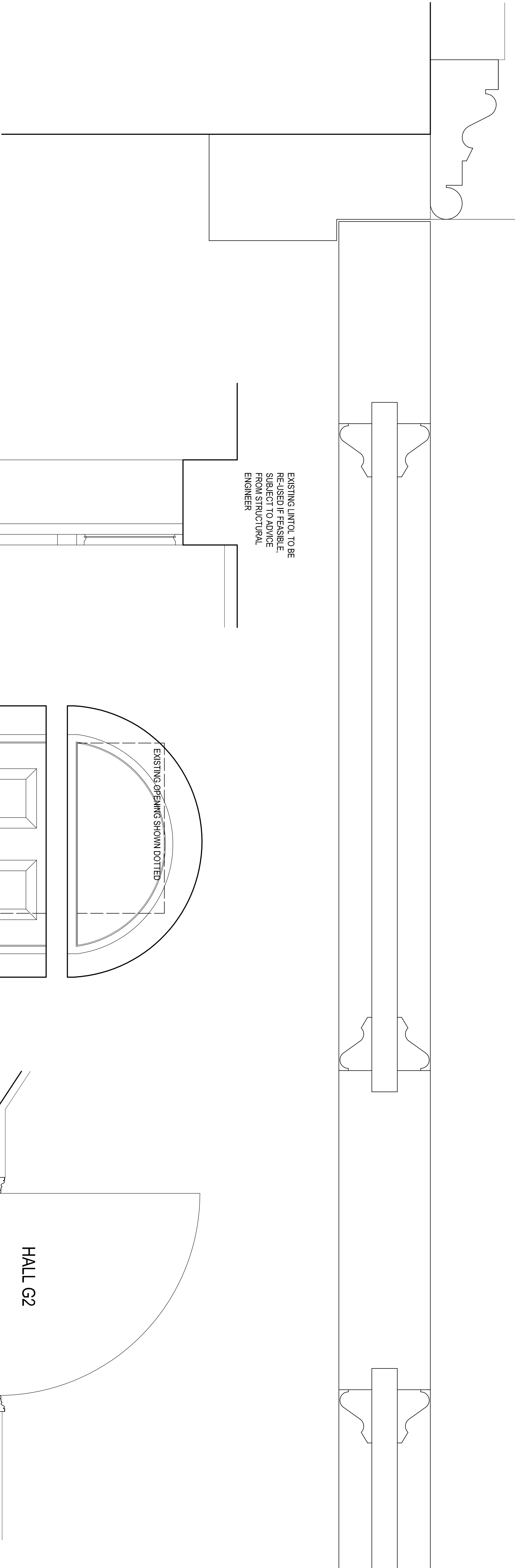

EXISTING LINTOL TO BE
RE-USED IF FEASIBLE,
SUBJECT TO ADVICE
FROM STRUCTURAL
ENGINEER

EXISTING OPENING SHOWN DOTTED

CROSS SECTION AT 1:20

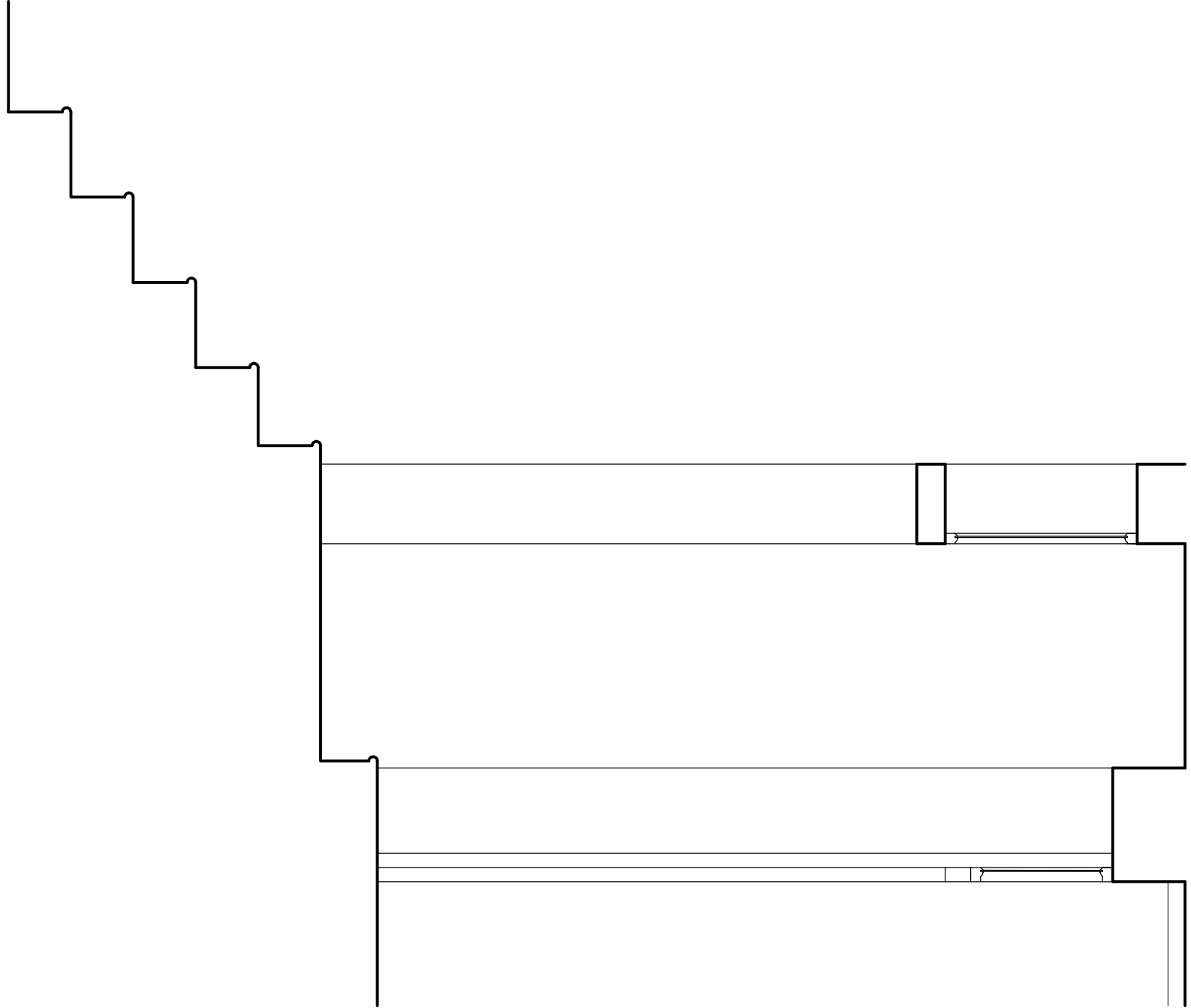

CROSS SECTION AT 1:10



ELEVATION AT 1:10

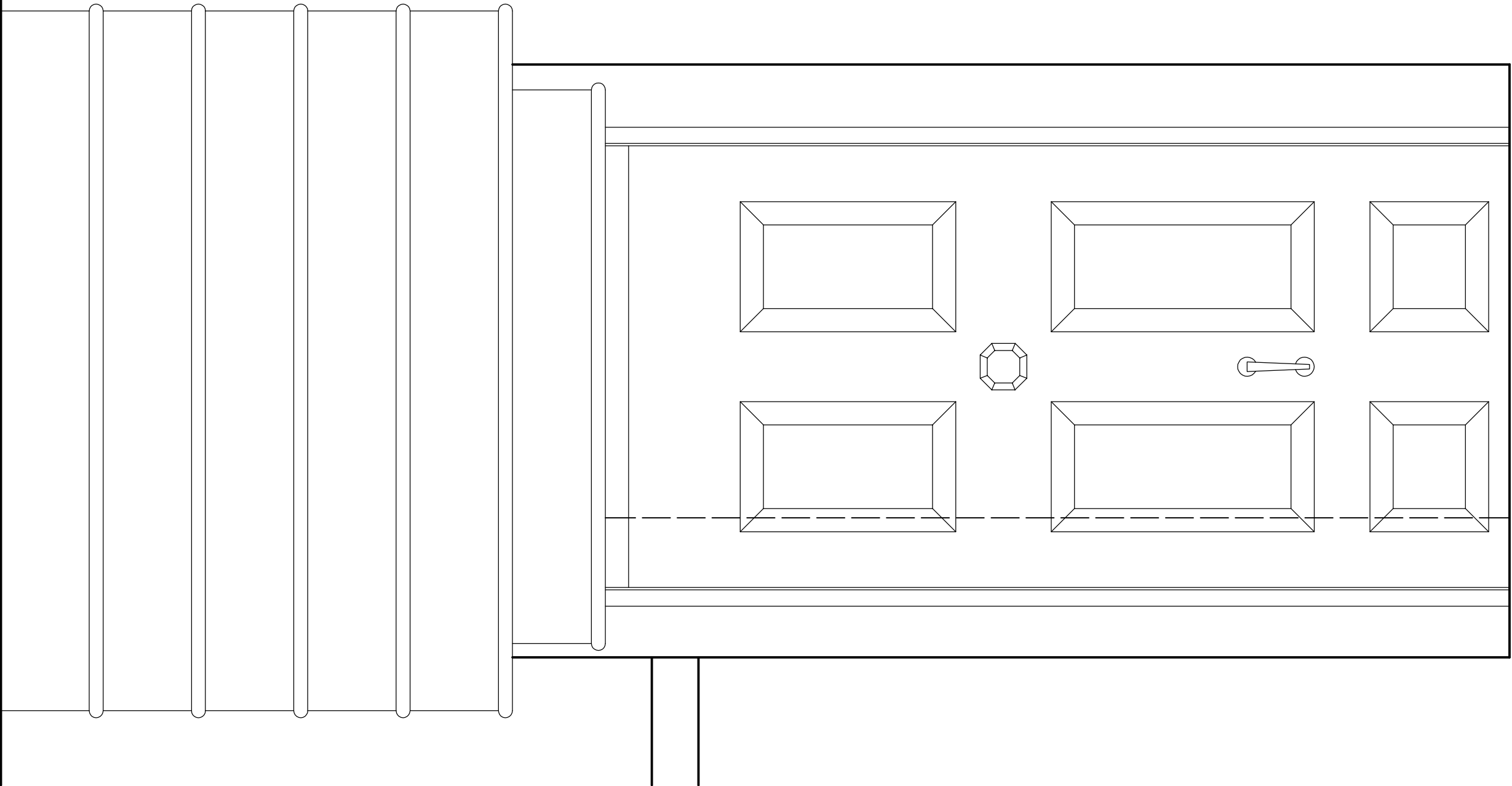

PLAN AT 1:10

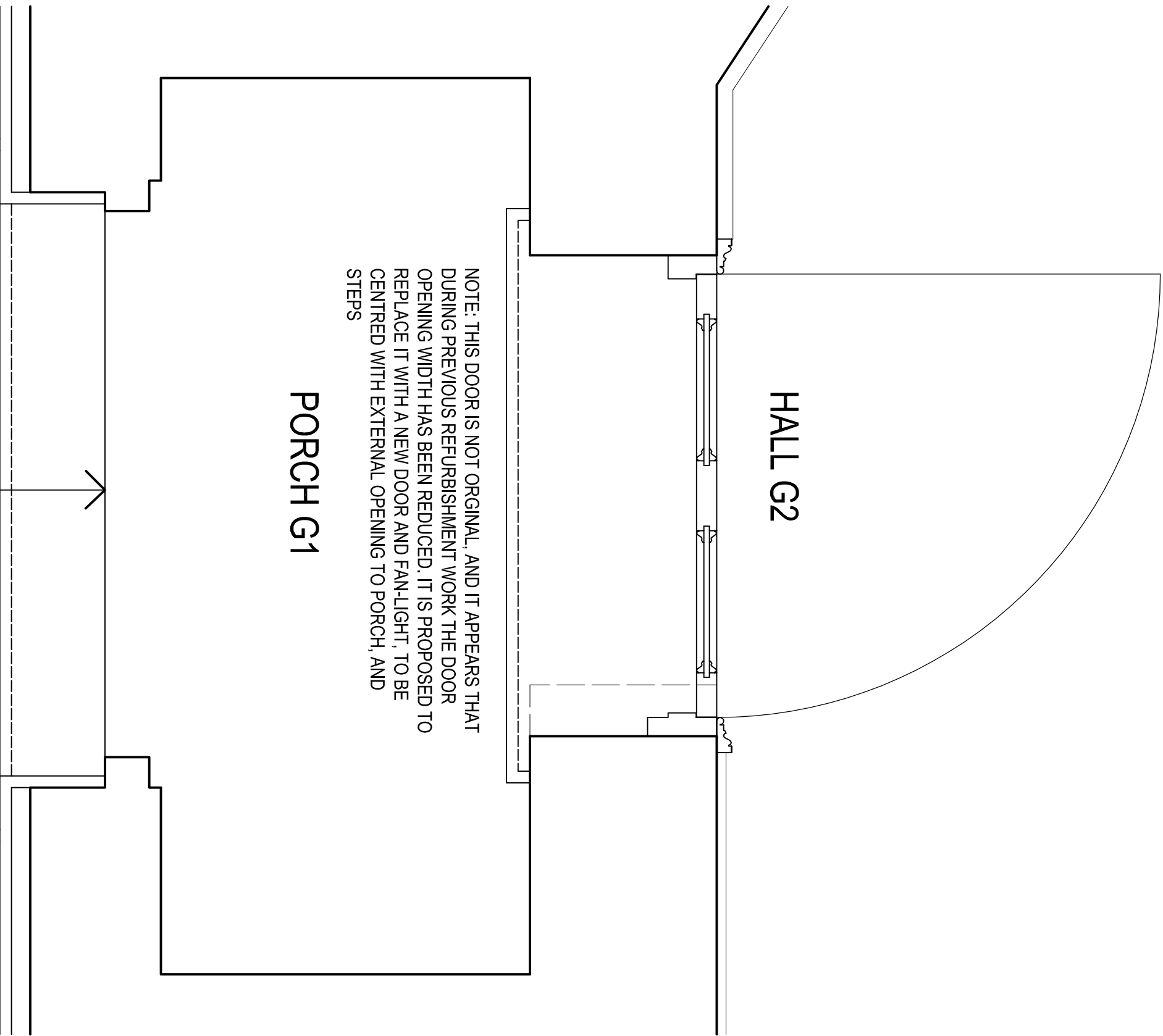

NOTE: THIS DOOR IS NOT ORIGINAL, AND IT APPEARS THAT
DURING PREVIOUS REFURBISHMENT WORK THE DOOR
OPENING WIDTH HAS BEEN REDUCED. IT IS PROPOSED TO
REPLACE IT WITH A NEW DOOR AND FANLIGHT, TO BE
CENTRED WITH EXTERNAL OPENING TO PORCH, AND
STEPS

PORCH G1

HALL G2

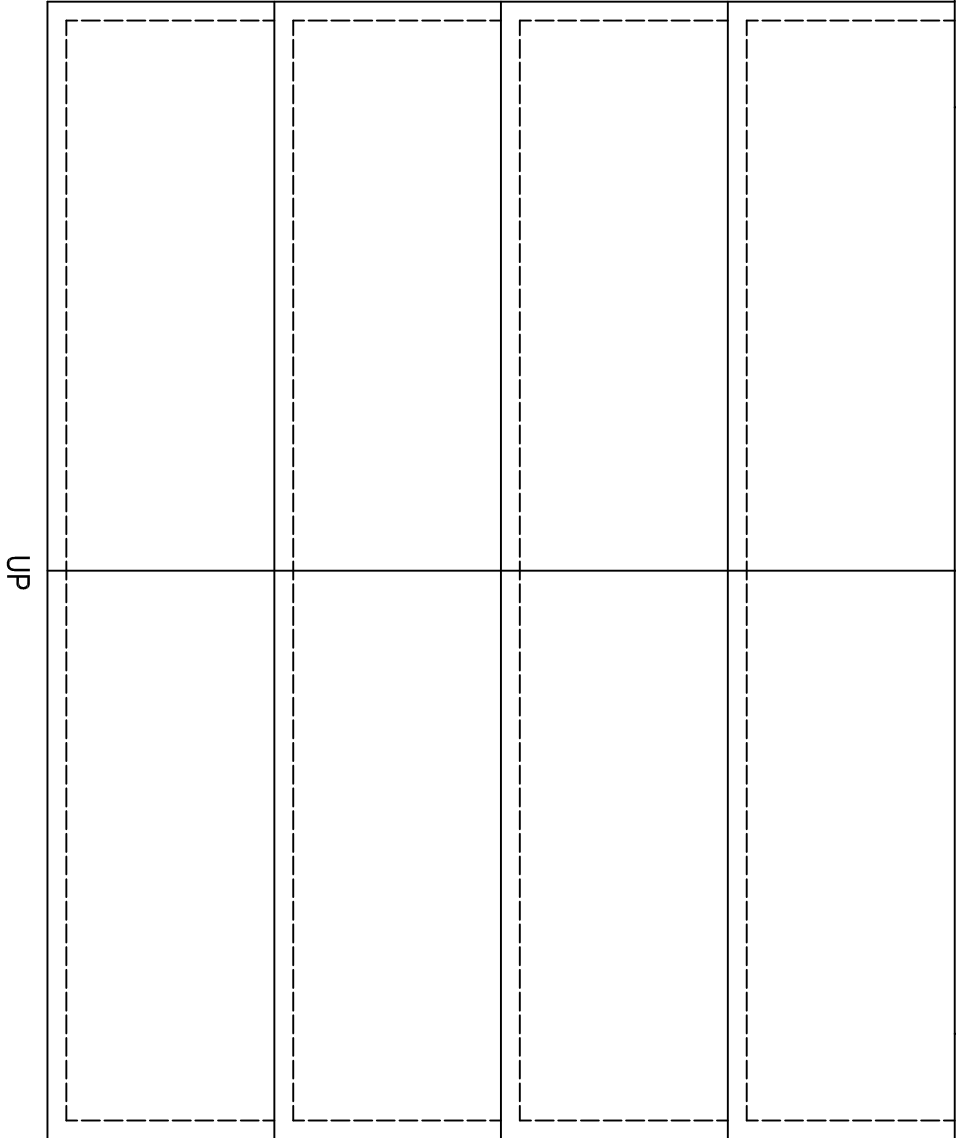

UP

THE PROPOSAL IS TO REPLACE THE EXISTING
CONCRETE TREADS AND RISERS WITH YORK
STONE TO EXISTING SIZES, THICKNESSES
AND PROFILES

Rev.				Reason For Issue		Check
Key Plan		Date				
UNIT 10/11, 44 GERRARD STREET LONDON E7 1H 8SH P 020 7025 3800 info@urbanexchange.com						
Client MR & MRS R ROBINOW						
Project 28 PARK VILLAGE EAST LONDON NW1 7PZ						
Title NEW FRONT DOOR AS PROPOSED						
Job No. 2000	Original 1:1, 1:10 2:1, 2:10	Scale 1:1, 1:10 2:1, 2:10	Number 6	Revision		
Date 10-12-2017	Location	Drawn by				