

APPLICATION REF: 2008/0342/INVALID  
**3.7 Existing railings**

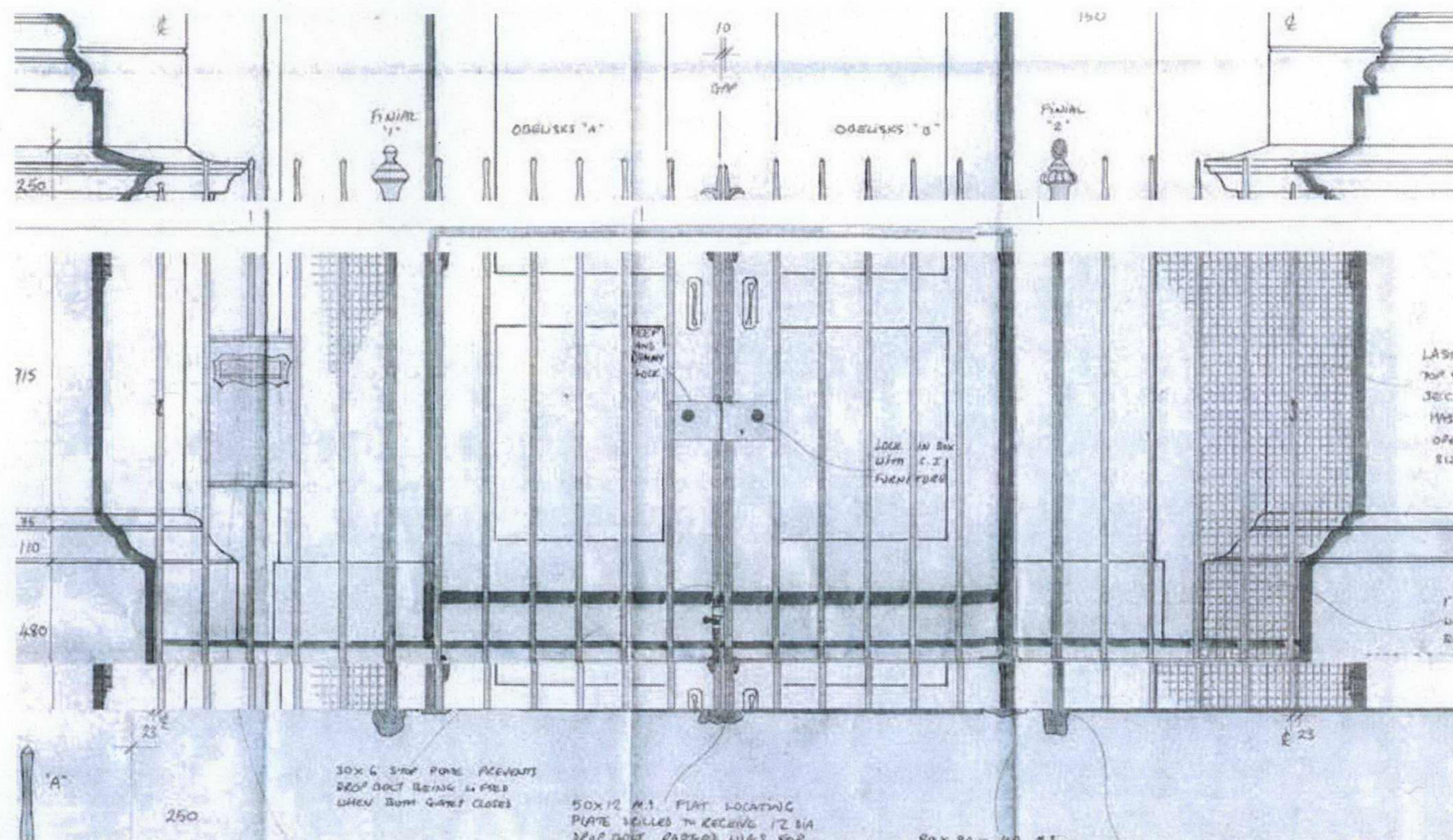

Elevation of front door railings 1:20

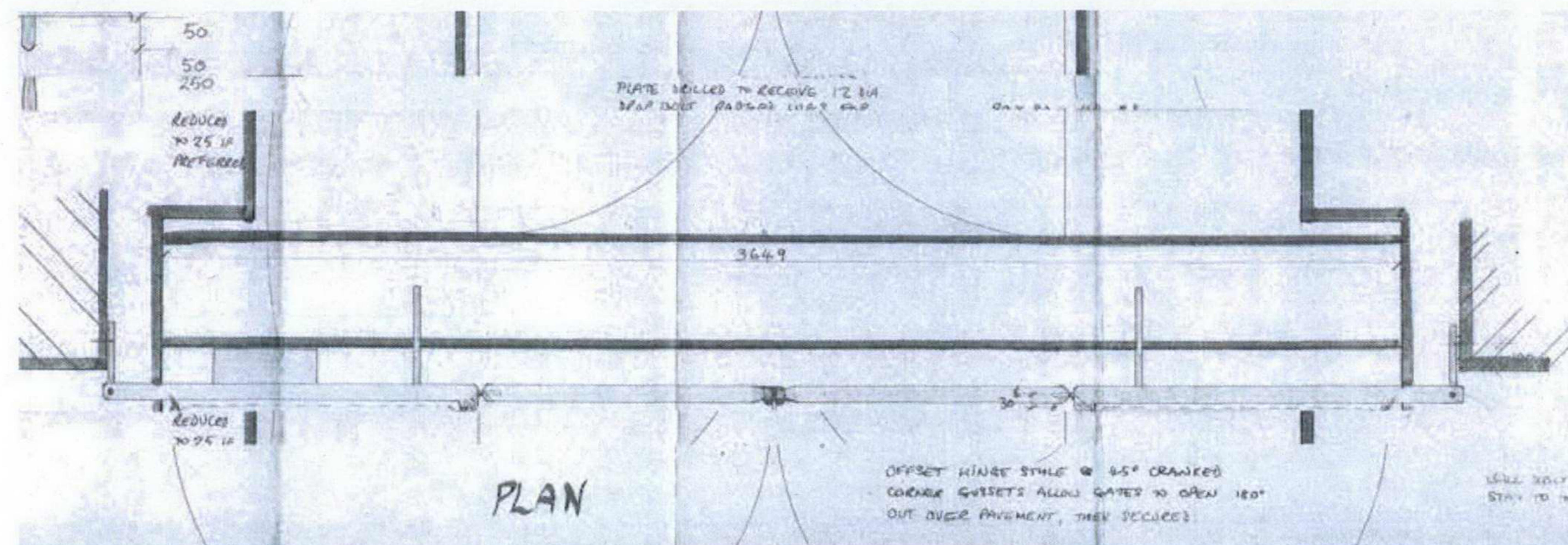

Plan of front door railings 1:20

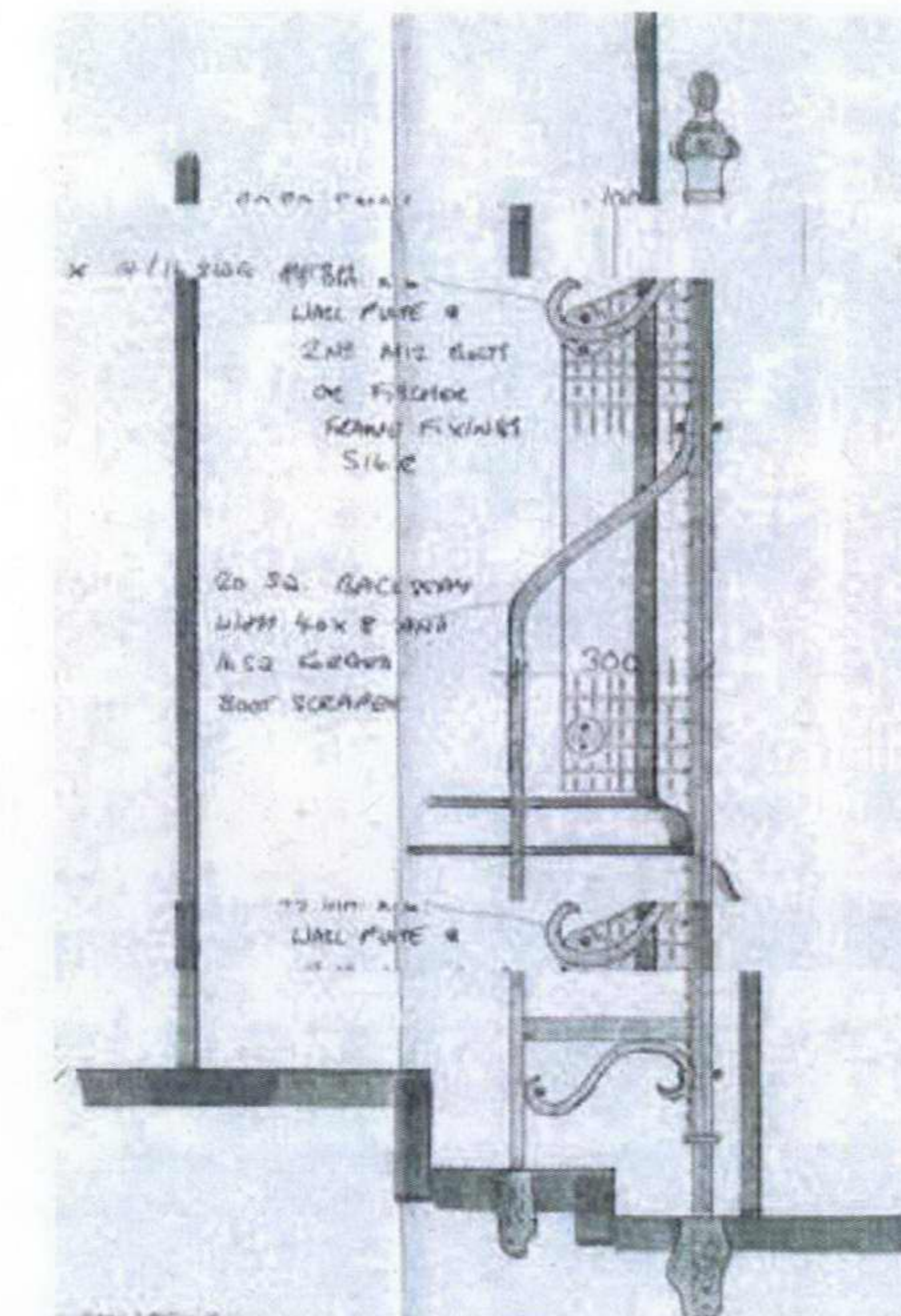

Section through front door railing 1:20

PROJECT		20.50 M.S.	
Rev	Date	Drawn	Description
<b>Capricorn</b> <b>Architectural Ironwork Ltd</b> TASSO FORGE TASSO YARD, 56 TASSO RD. LONDON, W6 8LZ 01-381 4235			
Job Title THE SWISS CHURCH IN LONDON 49, CONNELL ST SHAFTESBURY AVENUE, E1C2			
Drawing Title W.I. GATES & RAILINGS TO FRONT ENTRANCE			
Rev	Date	Drawn	Description
JOHNS	3.9.66	Original	13064
Scale	10-1	1/2"	1/8"
Date	Sept. '91	Drawn	Checked

Drawings by "Capricorn  
 Architectural Ironworks,  
 London"  
 W.I. Gates and railings to  
 front entrance  
 September 1991

DO NOT SCALE OFF DRAWING  
 REPORT ALL DISCREPANCIES  
 CHECK ALL DIMENSIONS ON SITE

© Christ & Gantenbein AG  
 08/02/2008



### 3.8 Adapt existing railings to double folding

This measure is taken to improve the DDA access issues. It is subject to a thorough study by an ironwork specialist. If this solution happens to be too difficult to realise, the railings will be taken away from the building, or left as they are. The new handrail will be adapted accordingly.

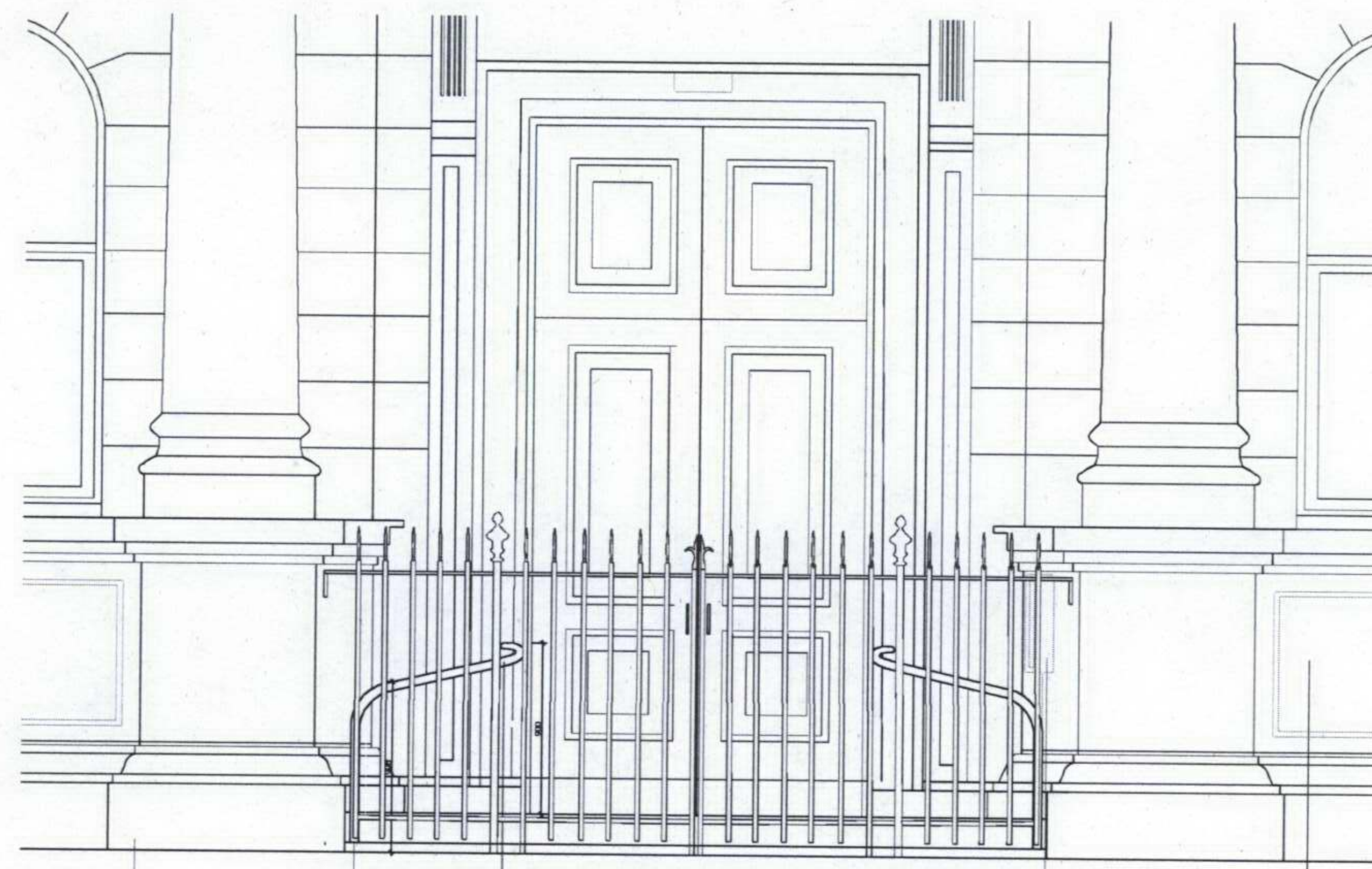

Existing railings 1:50

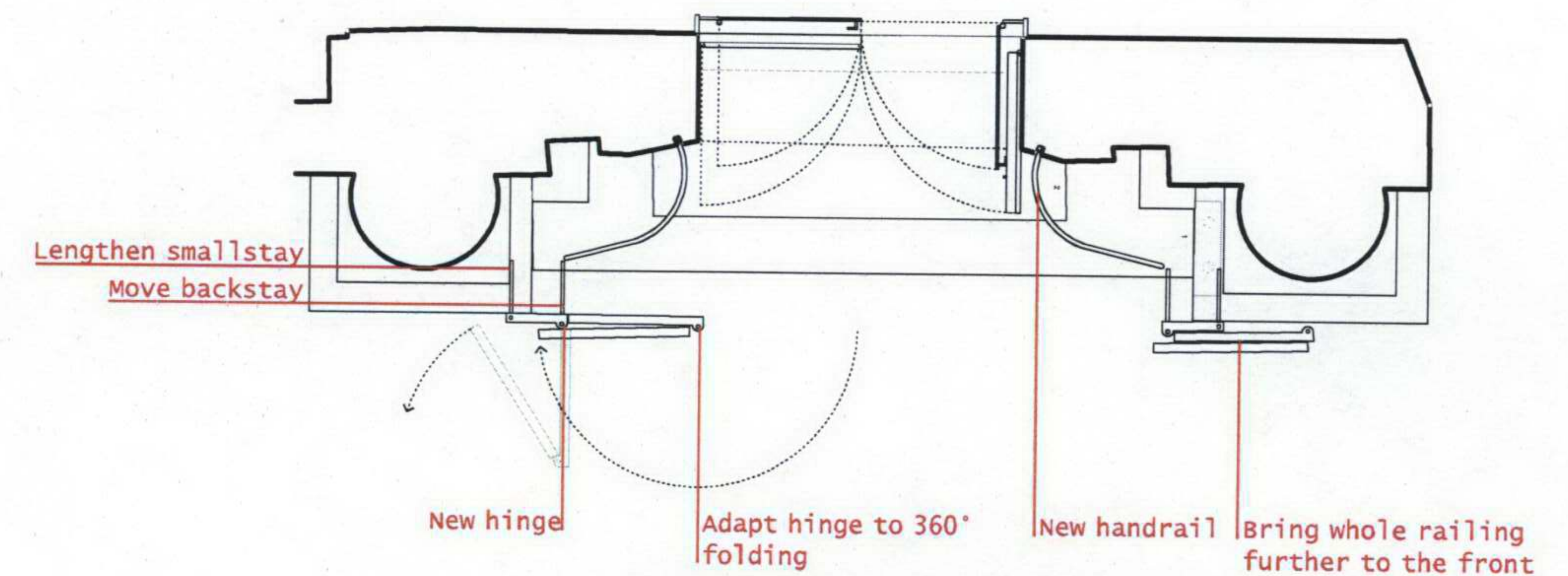

Proposed railings 1:50

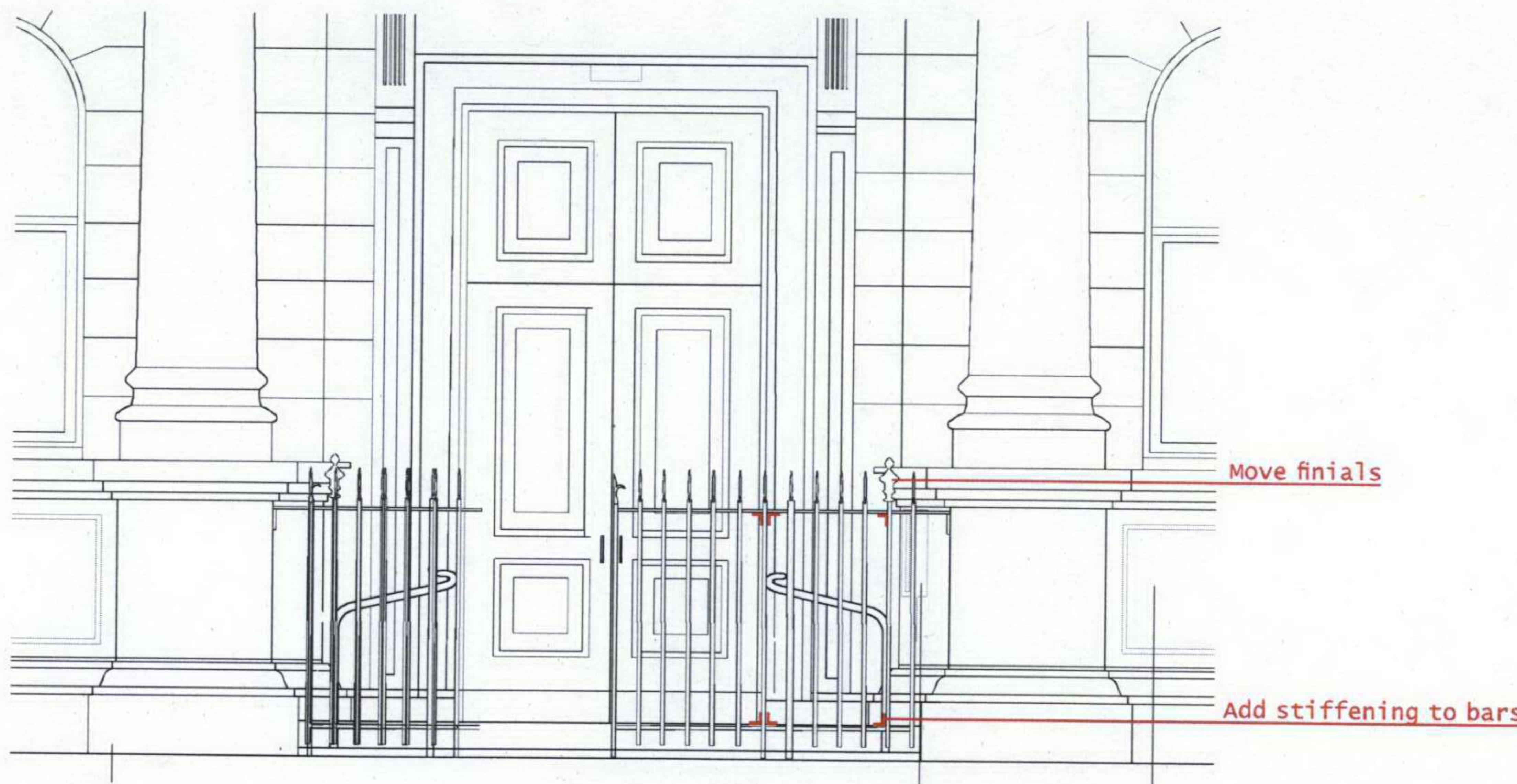

Proposed railings 1:50

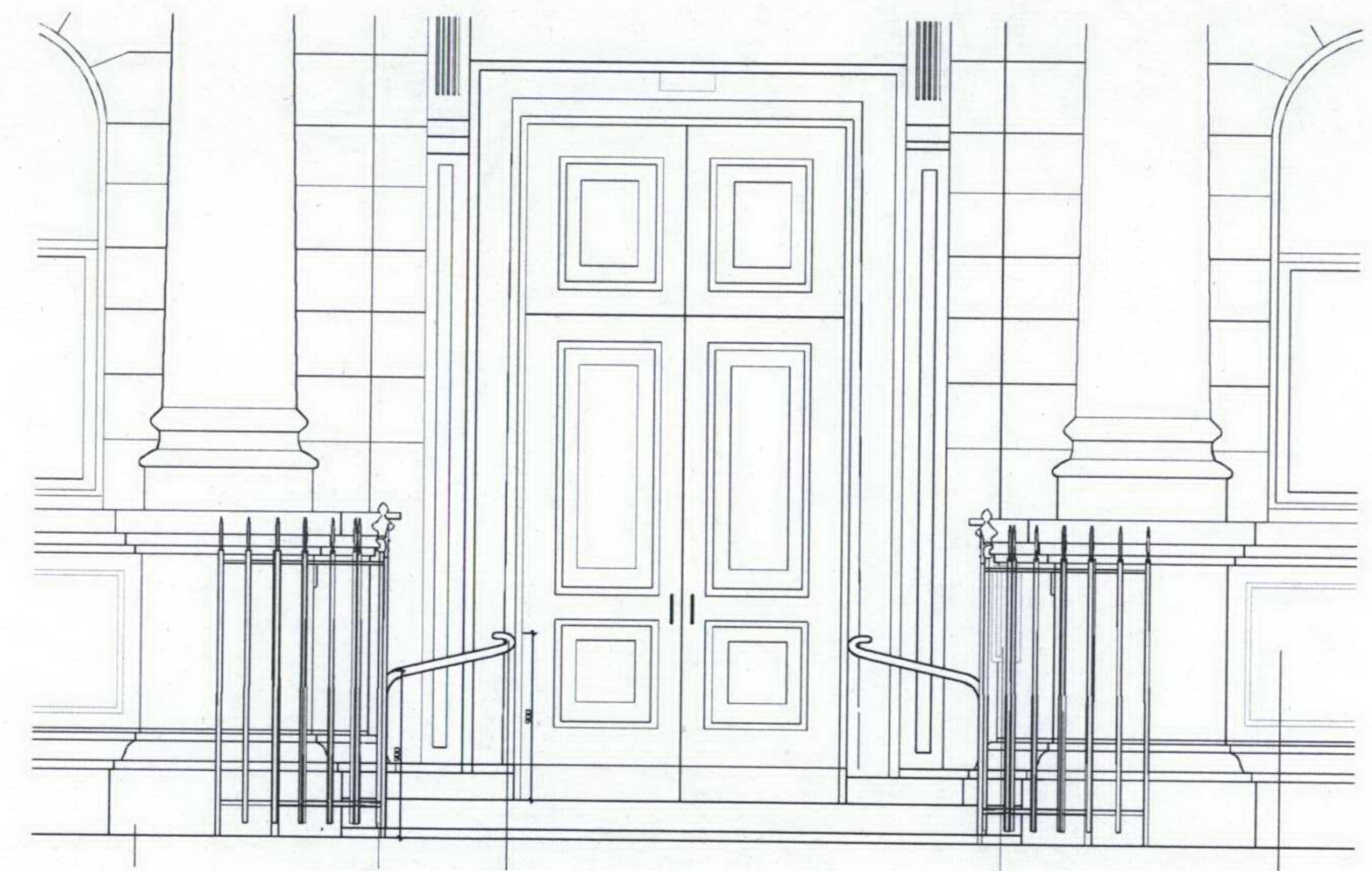

Proposed railings 1:50

DO NOT SCALE OFF DRAWING  
REPORT ALL DISCREPANCIES  
CHECK ALL DIMENSIONS ON SITE

© Christ & Gantenbein AG

08/02/2008



PROJECT	The Swiss Church, London		PHASE	Listed Building Application
CONTENT	Existing railing adapted to 2x fold		PLAN NO.	1064_06-003
FORMAT	SCALE	DATE	REV.	
42/29.7	1:50	08.02.2008		

CHRIST & GANTENBEIN AG, ARCHITECTEN ETH SIA BSA, SPITALSTRASSE 12, 4056 BASEL, T 061 260 90 20, F 061 260 90 30, mail@christgantenbein.ch



Profile recessed into redone first step for fixing purposes

New handrail  
45mm circular steel hollow profile  
Rustproofing paint  
White paint finish

Profile recessed into existing wall for fixing purposes

Existing railings retained, adapted to double folding

Leveling of first step with removed third step

New letterbox on pole with accessible call button

Plan of the entrance with new handrail 1:20

APPLICATION REF: 2008/0342/INVALID

### 3.9 Proposed new handrail

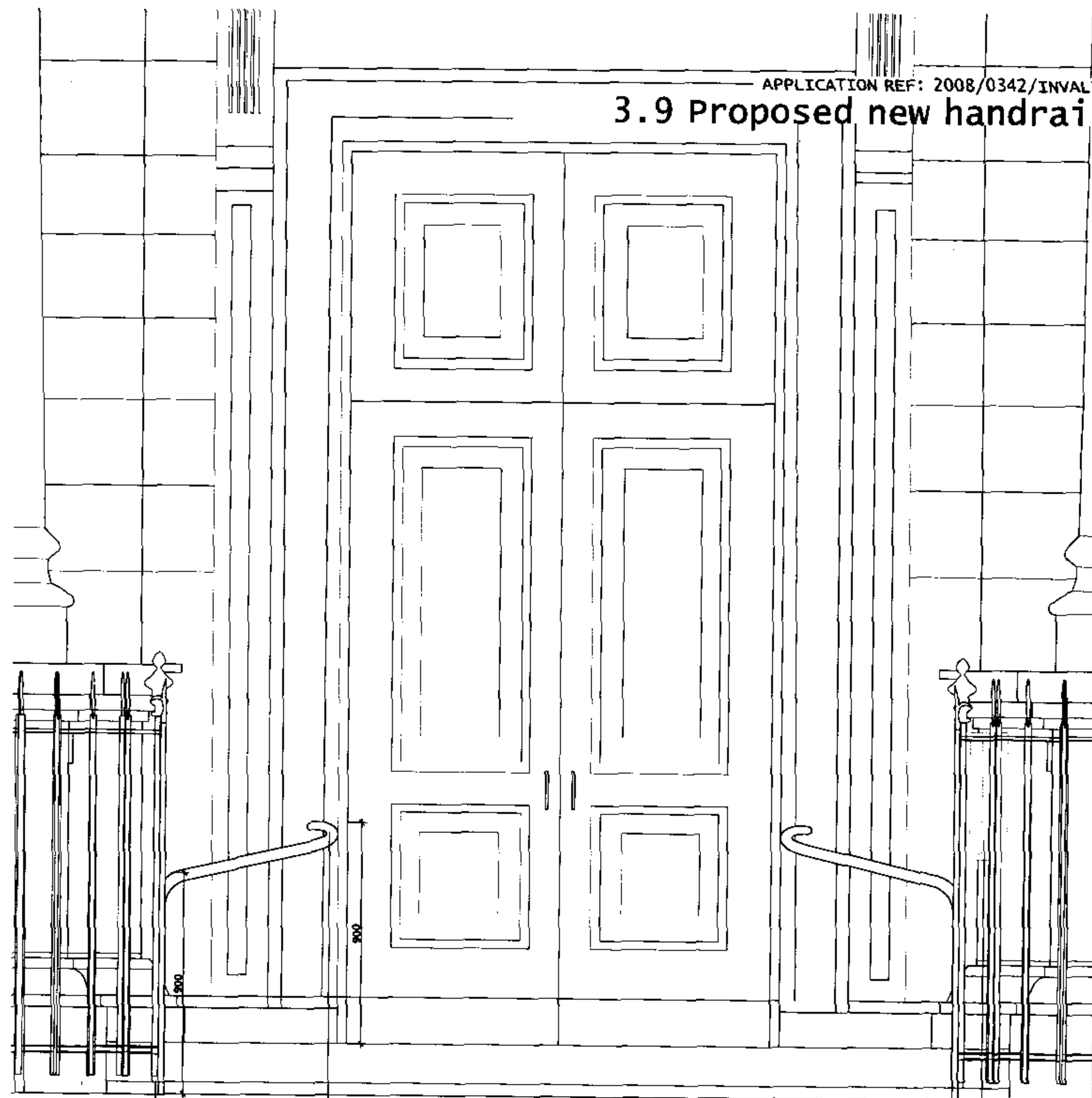

Profile recessed into redone first step for fixing purposes

New handrail  
45mm circular steel hollow profile  
Rustproofing paint  
White paint finish

New letter box with access call button

Elevation of the entrance with new handrail 1:20

DO NOT SCALE OFF DRAWING  
REPORT ALL DISCREPANCIES  
CHECK ALL DIMENSIONS ON SITE

© Christ & Gantenbein AG  
08/02/2008

PROJECT		PHASE	
The Swiss Church, London		Listed Building Application	
CONTENT		PLAN NO.	
Proposed new handrail		1064_06-002	
FORMAT	SCALE	DATE	REV.
42/29.7	1:20	08.02.2008	

CHRIST & GANTENBEIN AG, ARCHITECTEN ETH ZÜRICH, OPTIKSTRASSE 12, 8005 ZÜRICH, T 0041 251 280 10 30, F 0041 251 280 10 30, info@christgantenbein.ch

### 3.10 Opinion of independent societies

#### Ancient Monument Society

Von: Ancient Monuments Society [mailto:ancientmonumentsociety@btconnect.com]  
Gesendet: Mittwoch, 16. Januar 2008 21:29  
An: mail@christgantenbein.com  
Betreff: Swiss Church Endell Street - for Victoria Easton

For Victoria Easton

Thankyou very much for sending the very thorough brochure on your scheme for Endell Street. I found it sufficiently comprehensive to avoid the need, at least at this stage, to pay a visit.

Broadly speaking I think we can support the principle of the scheme. However there are three areas of initial concern

a) The striking new gallery structure is meant to be in dramatic contrast to the vulliamy original. This we understand and can support. But why must the front face ( looking into the sanctuary ) on each of the new floors be so waywardly irregular ? There is more than a touch of the fashionably perverse about it in echo of the horror of the straight line shown by Zaha Hadid. Walls at irregular angles are not only restless to look at but create difficult angles to use. By all means introduce movement but why not curves echoing those of the apse at the other end of the sanctuary ?

b) Corraling the monuments together on two floors has a certain appeal but it is very important that regimentation be avoided. Because people die decades, even centuries apart, monuments are always going to look somewhat haphazard in their placing and there is virtue in that. They should not appear like portraits in a gallery

c) We infer that the present railings within the central bay on the facade are to be removed. But why ?

I am copying this email to Tony Redman

Thankyou again for making contact

Matthew Saunders  
Secretary  
Ancient Monuments Society  
St Ann's Vestry Hall, 2 Church Entry, London EC4V 5HB  
Tel: 020 7236 3934 & email: office@ancientmonumentsociety.org.uk  
website: www.ancientmonumentsociety.org.uk

Victorian Society

EINGEGANGEN 26. Jan. 2008  
1958  
2008

**THE VICTORIAN SOCIETY**

Campaigning for Victorian and Edwardian architecture and other arts

Patron HRH The Duke of Gloucester KC, GVO  
President Lord Mabel Strick  
Chairman Dr Colin Cunningham

David Garrard  
Historic Churches Adviser  
Direct line 020 8747 5893  
david@victoriansociety.org.uk

Victoria Easton  
Christ & Gantenbein AG  
Spitalstrasse 12  
CH-4056 Basel  
Switzerland

Your reference:  
Our reference: 2007C-06-007

22 January 2008

Dear Ms Easton

**Swiss Protestant Church, 79 Endell Street, London (grade II, G. Vulliamy, 1853-5) – proposed internal remodelling**

Thank you for your letter and enclosures of 10 December 2007, notifying the Victorian Society of proposals concerning the above church, and also for kindly agreeing to send through the documents in electronic format. I had the pleasure of visiting the church earlier this month, and was shown round by David Leuenberger and his colleagues. The proposals were subsequently discussed by our Southern Buildings Committee, whose response I now write to convey.

The Swiss Church is a fine and nobly-proportioned building by a distinguished 19<sup>th</sup>-century architect. Its international connections – having been designed and paid for by members of the Swiss community in mid-Victorian London, and used by their descendants for more than 150 years – give it a unique social and historical importance. It has suffered much from fire damage and from unsympathetic alteration, losing all of its original internal fittings and (thanks to the interwar remodelling of the lobby area) many of the special qualities that are its finest feature. It has also been subject to a poor-quality redecoration scheme, the result of which has been to give the building an appearance of premature dilapidation.

We therefore welcome the proposal to renovate and redecorate the building. The quality of the worship area will be much improved by the removal of the present gallery structure, and its replacement strikes us as a well-conceived modern intervention that responds well to the austere aesthetic of Vulliamy's interior. We do not object to the lowering of the floor or the extension of the basement area, provided this is done carefully so as to avoid damage to the historic fabric.

Our only concerns relate to two comparatively minor matters: the relocation of the memorial plaques from the main hall to the entrance area, and the replacement of the windows on the main street front with new double-glazed units. The memorials, as well as documenting the history of the church and its congregation, also play a role in articulating the interior space. They are arranged in matching pairs (two in marble, then two in bronze, then two more in marble), placed equidistantly on either side of the hall, presumably a deliberate design

1 Priory Gardens, London W4 1TT Telephone 020 8984 1019 Facsimile 020 8747 5898 www.victoriansociety.org.uk  
The Victorian Society is a Registered Charity No. 1081439 and a Company Limited by Guarantee Registered in England No. 3640990. Registered office at above

choice on the part of the church's late 19<sup>th</sup> and early 20<sup>th</sup>-century congregation. We feel that transferring the monuments to the vestibule area would not (in the words of the consultation document) make them significantly 'more accessible for study purposes', and would deprive the main hall of a small but important part of its historic and visual character. We would therefore advise that they remain *in situ*.

As regards the windows, it is not clear from the application whether the existing sashes and casements are original to the building; if they are, then we would point out that government guidance on works to historic buildings – as embodied in *Planning Policy Guidance 15*, appendix C.40-49 – strongly advises against the replacement of original windows in listed buildings unless strictly necessary. In this case, we feel that secondary glazing placed behind the existing window frames would be preferable to new double glazing.

Thank you once again for your consultation. If you have any further questions, please do not hesitate to contact me.

Yours sincerely



David Garrard  
Historic Churches Adviser

Cc. Zoe Coad, English Heritage  
Conservation and Design Team, Camden Borough Council