

P9601231R2 9601297R2

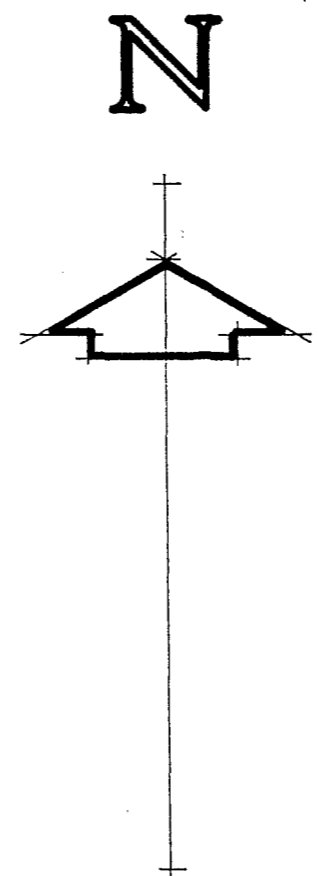

proposed extensions  
shown dotted

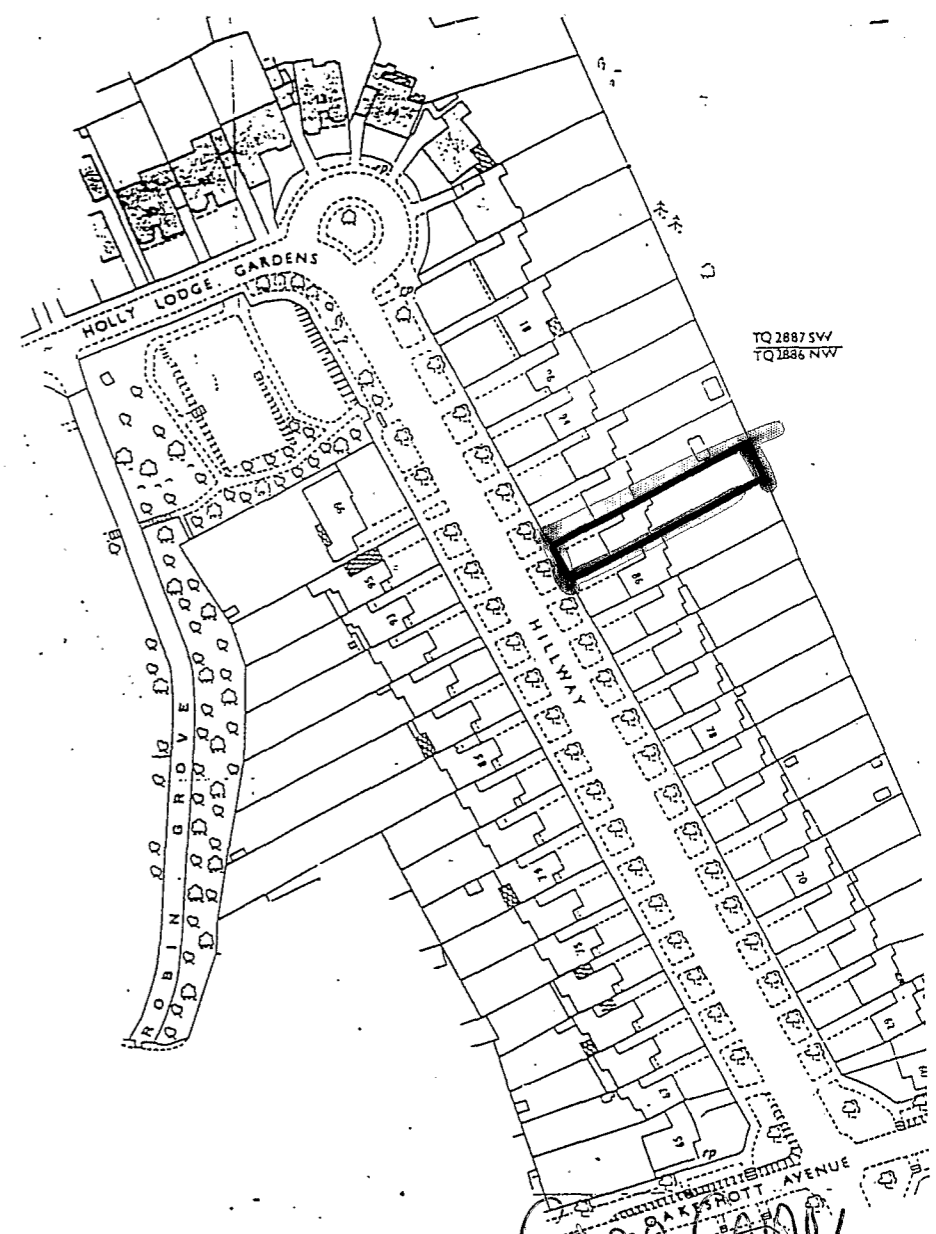
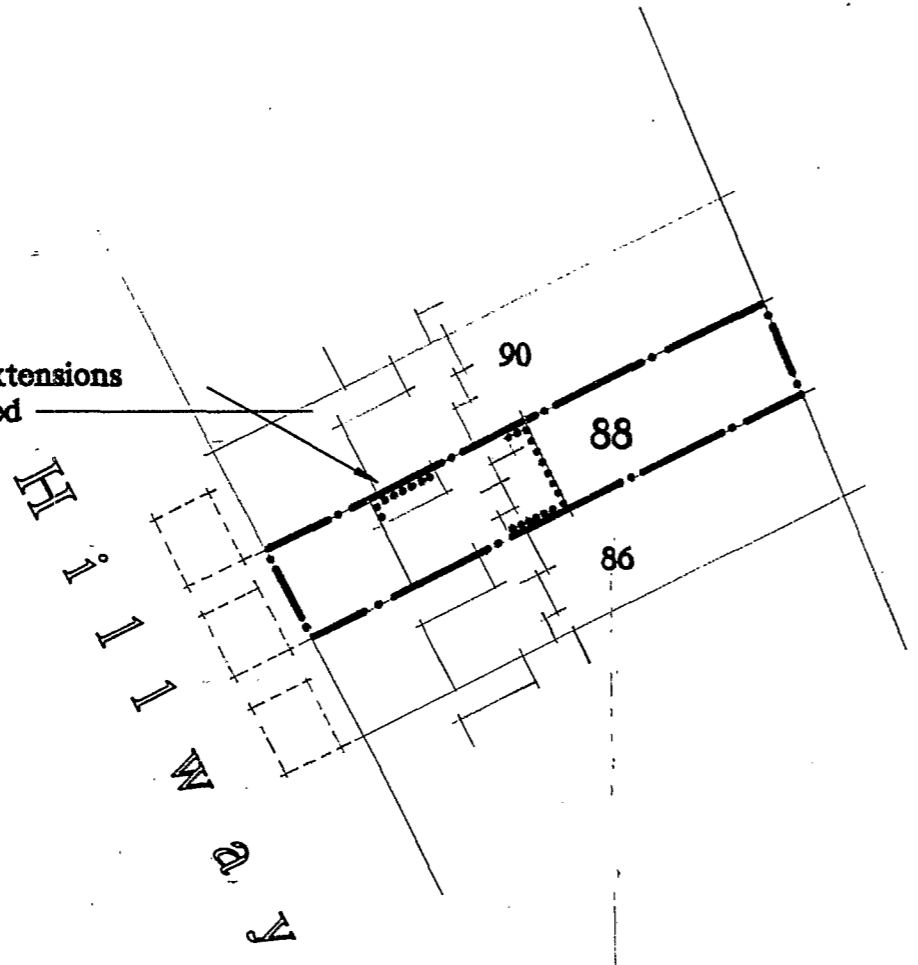

*Carole Lamb*  
LONDON BOROUGH OF BARNET  
TOWN AND COUNTRY PLANNING ACTS  
17 OCT 1996  
PLANS APPROVED  
ON BEHALF OF THE COUNCIL

1:500 & 1:1250

9609 - 01  
site & location plans