

PROPOSED SHOPS, OFFICES & RESIDENTIAL HOSTEL

ON SITE BOUNDED BY —
TOTTENHAM COURT NO. 10 • MIDFORD PLACE
CRAFTON WAY & WHITFIELD STREET.

E. S. BOYER & PARTNERS
Architects & Engineers
66-90, ARMS IN ROAD, W.C.1.

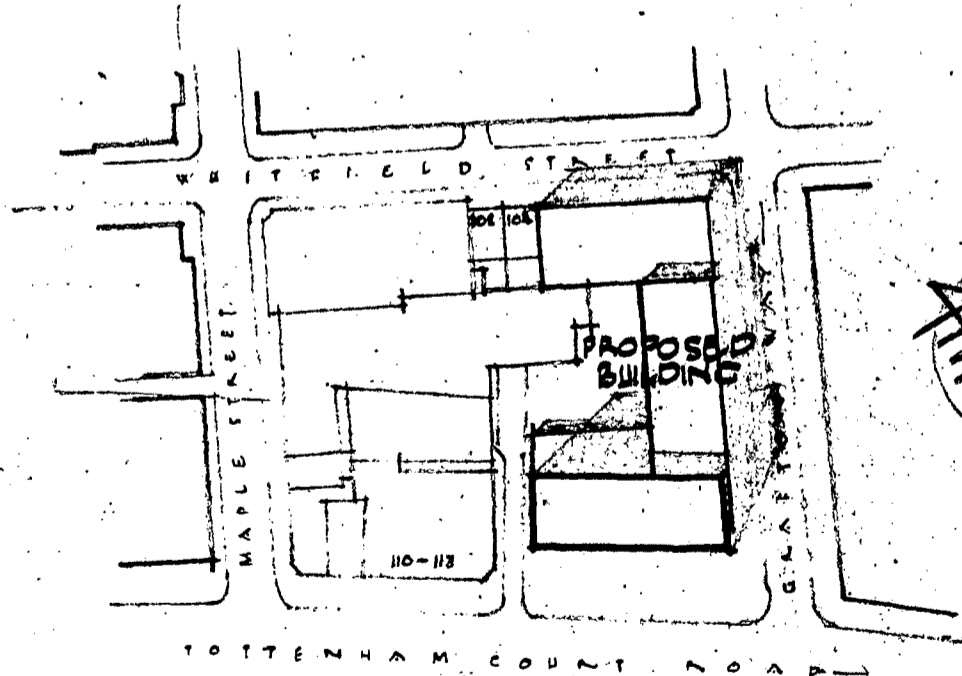

ARCHITECT L.C.C.
No. ~~19916~~
28 NOV 1960 / 8380
REF

32ND SCALE SKETCH SCHEME

JOB NO: 814