

27, ROUSDEN STREET, LONDON, N.W.1.

GROUND FLOOR FLAT - PLAN.

NOTE:

The demised premises are outlined in RED thus 
The Common areas are outlined in Green thus 

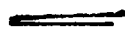
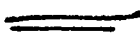
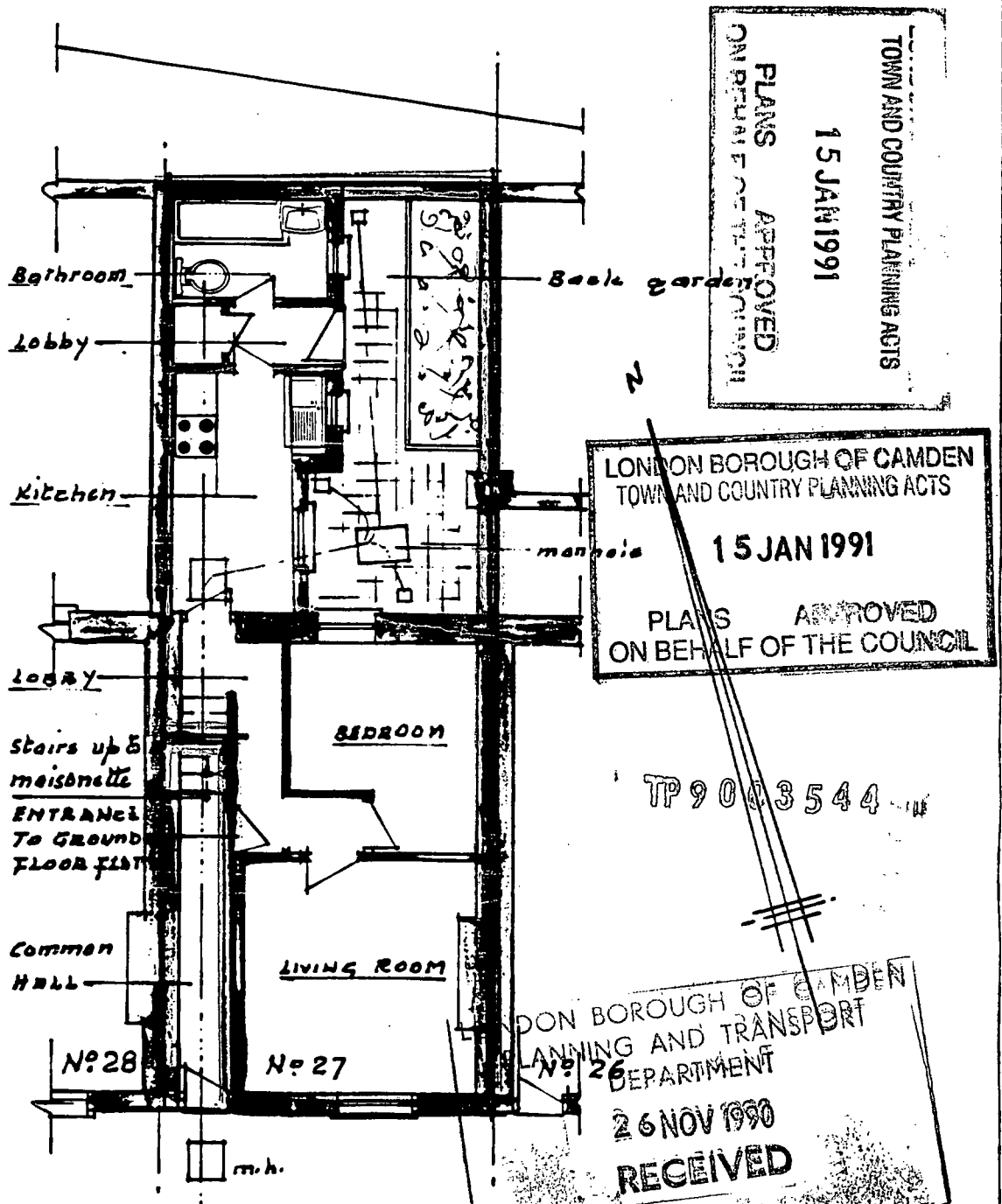

ROUSDEN STREET
GROUND FLOOR PLAN

DRAWN - January 1985
SCALE - 1/8 INCH TO 1 FOOT
DRAWING NO 1/1/85