

N.T.S.

SMALL BRICK PLANTERS
HT. 0.5m

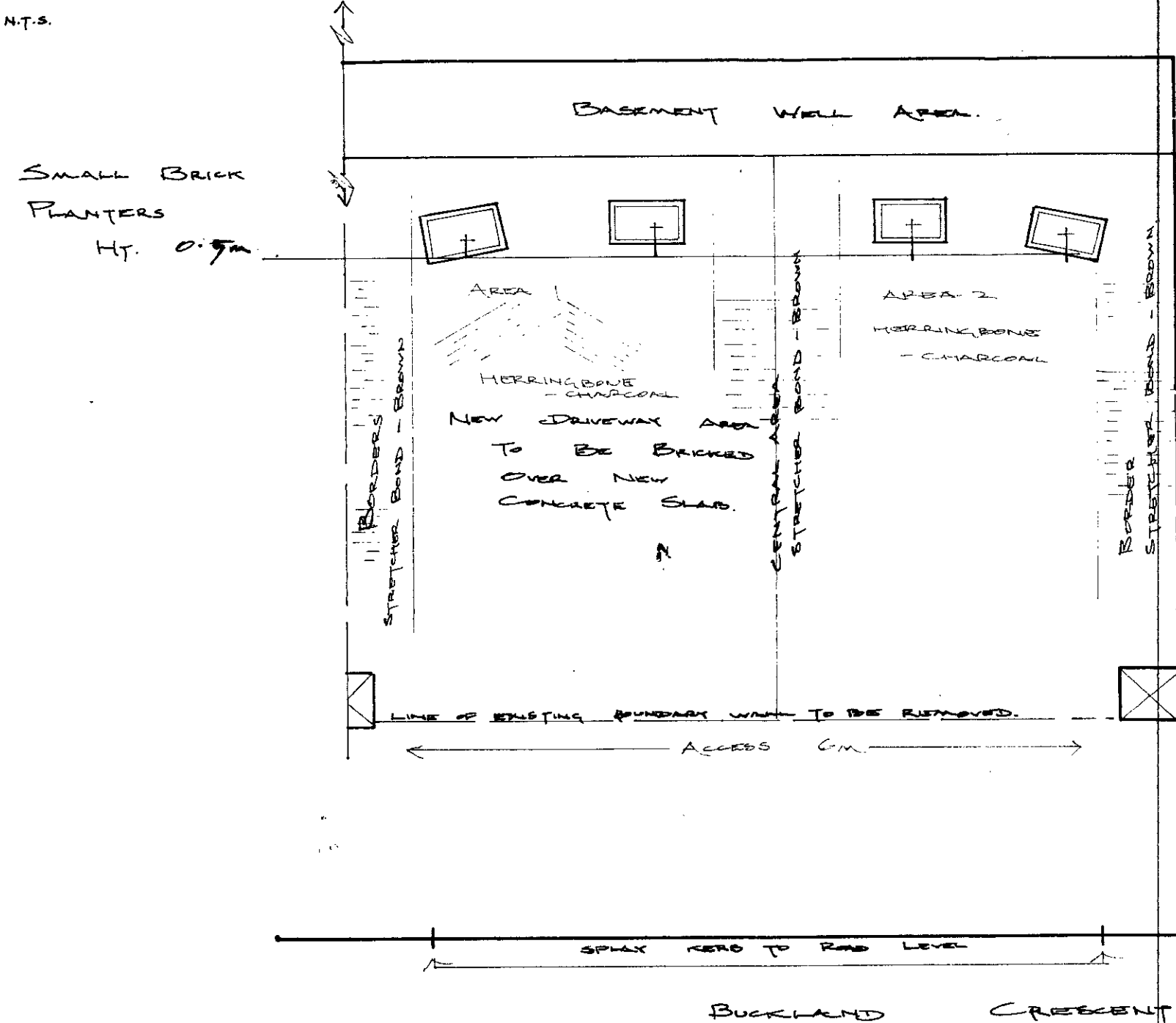

31 ~~30~~ BUCKLAND CRESCENT

LONDON BOROUGH OF CAMDEN
TOWN AND COUNTRY PLANNING ACTS
19 APR 1989
PLANS ~~NOT APPROVED~~ APPROVED
ON BEHALF OF THE COUNCIL

RECEIVED
LONDON BOROUGH OF CAMDEN
PLANNING AND TRANSPORT
DEPARTMENT
9 NOV 1988

NOTES:
All dimensions must be checked on site and not scaled from this drawing.

- PROPOSAL:
1. REMOVE FRONT BOUNDARY WALL WHERE SHOWN.
 2. CONCRETE OVER GARDEN AREA ON COMPACTED SOIL AND HARDWARE BED
 3. LAY 'DOW-MAC' INTERLOCKING CONCRETE BLOCK PAVING IN MIXED PATTERN (HERRINGBONE & STRETCHER BOND) IN CHARCOAL AND BROWN COLOUR
 4. SOLAY KERO TO ROAD LEVEL WHERE SHOWN
 5. INSTALL BRICK PLANTERS AS SHOWN

A	Date	Revisions

© copyright

4. SOLAY KERO TO ROAD LEVEL WHERE SHOWN
5. INSTALL BRICK PLANTERS AS SHOWN

Client

Job Title

PAVING OVER OF FRONT GARDEN AREA

Drawing Title

31 ~~30~~ BUCKLAND CRESCENT LONDON N.W.6.3

Scale

Date
JUNE 89

Drawn by

Drg No.
1A

Rev