

BACK STAIRCASE TO
2ND FLOOR.

500-1185-
C-11-11-11

20867

~~XXXXXXXXXX~~

1 SET 72 11/11/11

FRONT WALL DOWN TO 7'6"

BRAMPING

TUTOR

REAR WALL 8'3"

EXISTING BUILDING

13'0"

DOOR OF EXISTING BUILDING

PLAN

10"x2" TIMBER JOISTS AT 3/2" CENTERS PERCH OF ROOF 9' ASBESTOS SHEETING COVERING ROOF. LEANTO BUILT INTO EXISTING BUILDING.

Good job! Used up steel 1/2 2002

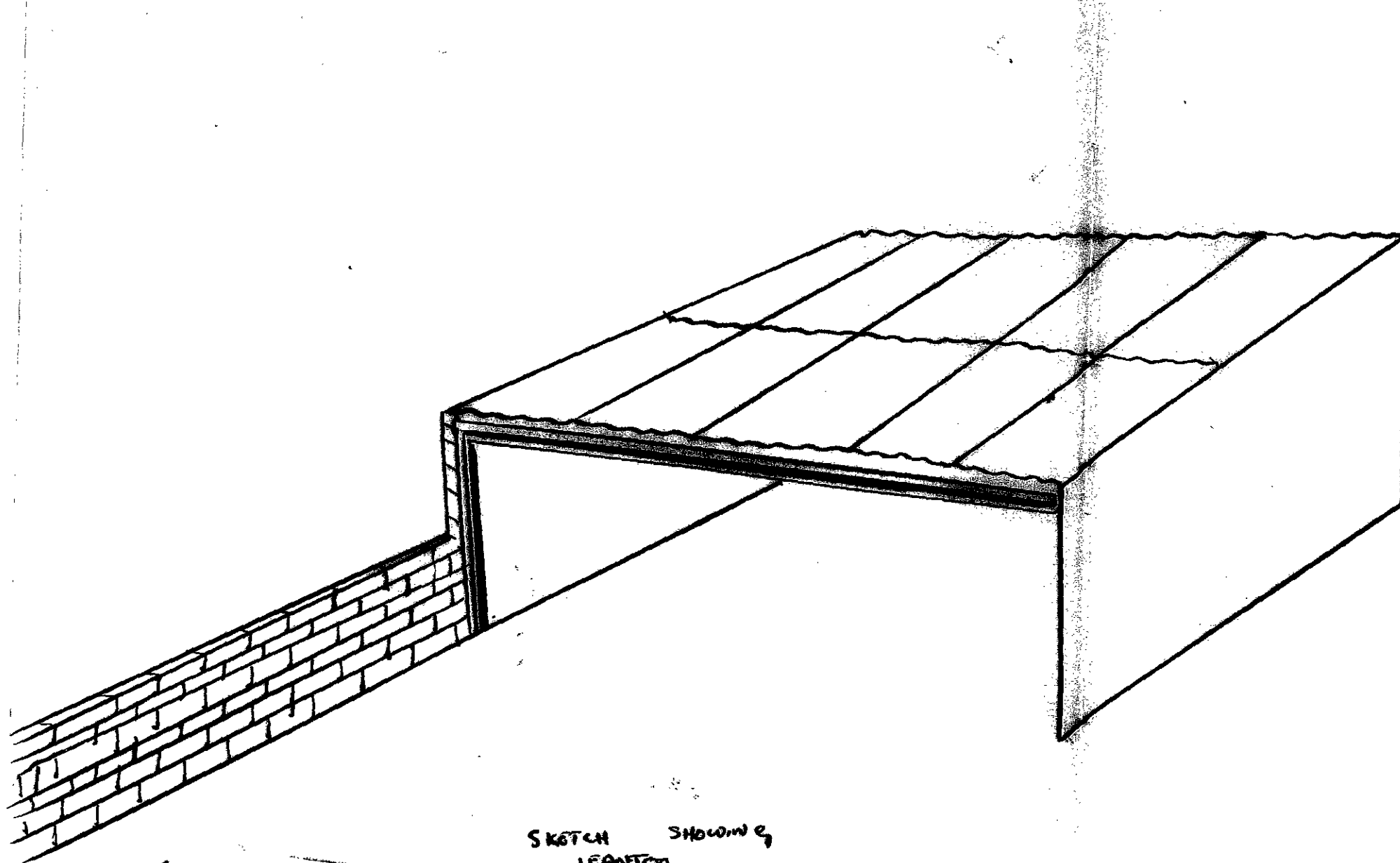

SKETCH SHOWING LEANTO.

Perth 12/10

PRESENTED TO TOWN COMMITTEE - 5 MAR 1952

20867