

PART ELEVATION

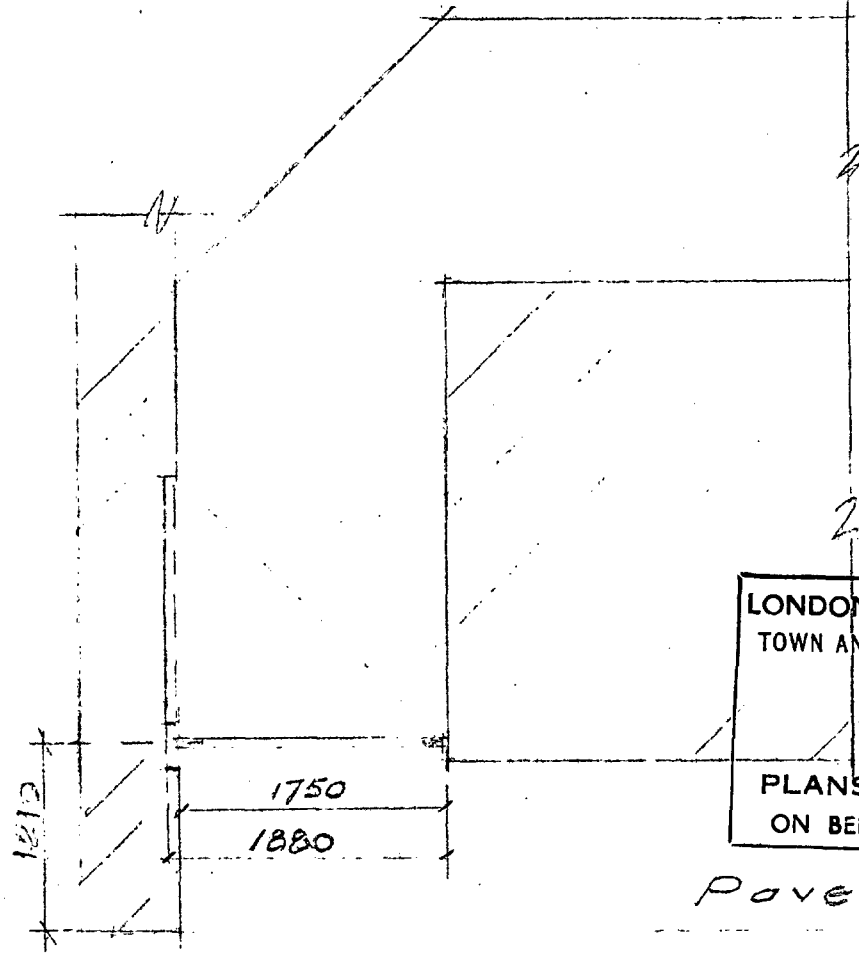

LONDON BOROUGH OF CAMDEN
 TOWN AND COUNTRY PLANNING ACTS
 15 JAN 1987
 PLANS APPROVED
 NOT APPROVED
 ON BEHALF OF THE COUNCIL

Pavement

PART PLAN

TP8601606

DRAWN BY _____	TITLE <u>ELECTRICITY REMOTE</u>	DWG. No. <u>FR/K/A/1</u>
	<u>CONTROL GATE at</u>	SCALE <u>1:50</u>
	<u>223 A FINCHLEY ROAD N.W.3</u>	DATE <u>JULY '86</u>