

CENTRE FACE (PRINCE OF WALES ROAD)

DISCUS HOUSE

(1 canopy)

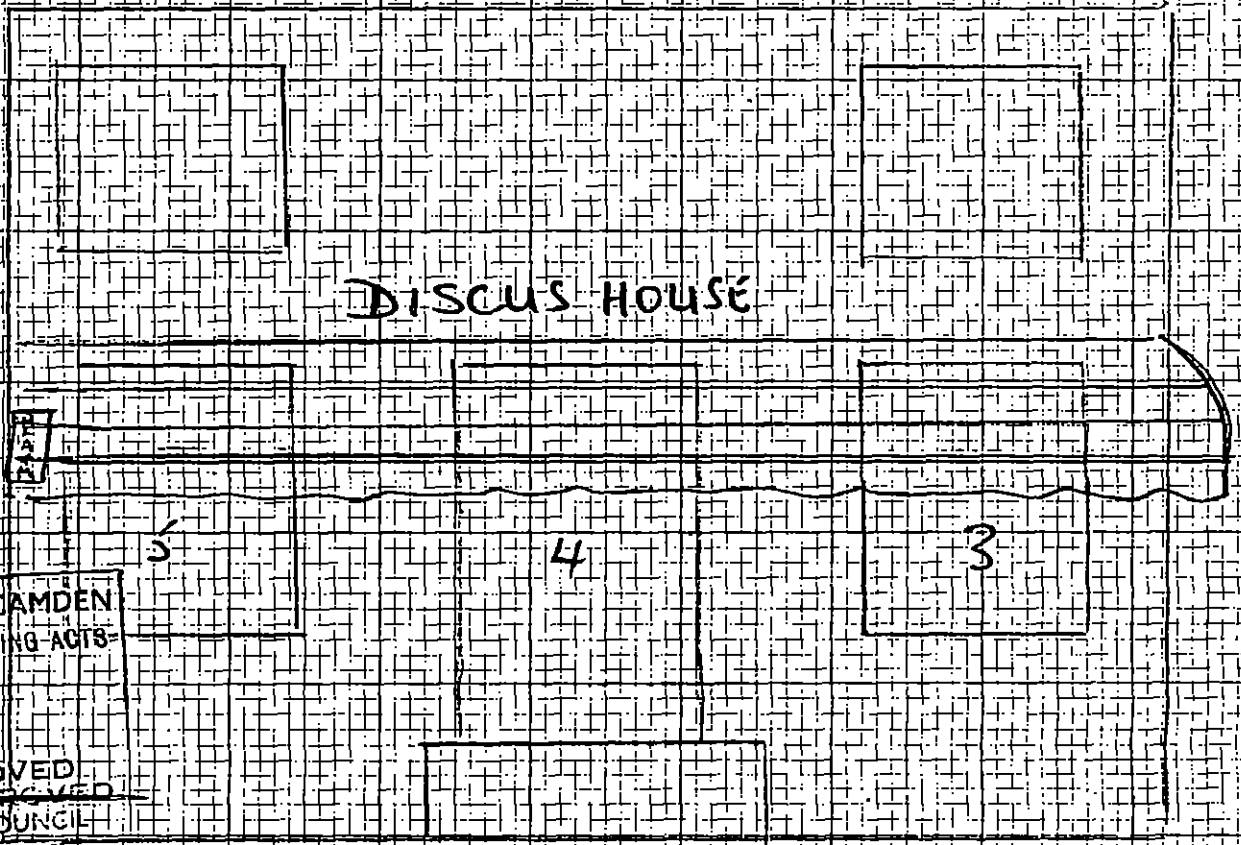

LONDON BOROUGH OF CAMDEN
TOWN AND COUNTRY PLANNING ACTS
28 JUL 1982
PLANS ~~NOT APPROVED~~ APPROVED
ON BEHALF OF THE COUNCIL

CTP/610/22/9/34471

RIGHT HAND FACE (IN HAVERSTOCK HILL)

62 DISCUS HOUSE



LONDON BOROUGH OF CAMDEN
TOWN AND COUNTRY PLANNING DEPT

26 JUL 1982

MAIN
ENTRANCE

PLANS ~~NOT APPROVED~~
ON BEHALF OF THE COUNCIL

910/22/9/34471

LEFT HAND FACE
(PRINCE OF WALES RD)

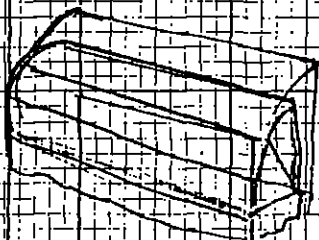

7



6

LONDON BOROUGH OF CAMDEN
TOWN AND COUNTRY PLANNING ACTS

28 JUL 1982

APPROVED
PLANS ~~NOT APPROVED~~
ON BEHALF OF THE COUNCIL

CTP/G10/22/9/3447!