

P9600191

CAROLYN SQUIRE DIP ARCH RIBA	JOB NO: 9601/1
104 MILTON GROVE LONDON N16 8QY	DATE: JAN 96
01-254 0624	SCALE: 1:50
PROJECT: 183A GLENLOCH ROAD LONDON NW3	
DRAWING: PROPOSED CAR PARKING SPACE	

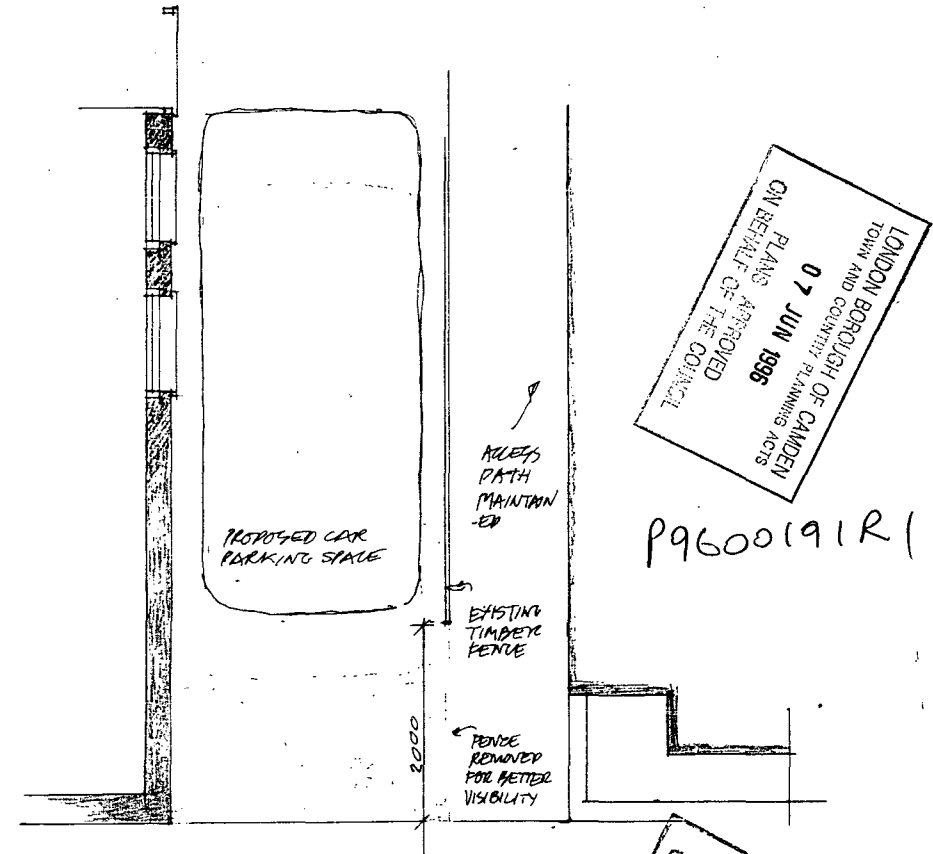

LONDON BOROUGH OF CANNEN
TOWN AND COUNTRY PLANNING ACTS
PLANS APPROVED
ON BEHALF OF THE COUNCIL
07 JUN 1996

P9600191R1

LONDON BOROUGH OF CANNEN
TOWN AND COUNTRY PLANNING ACTS
PLANS APPROVED
ON BEHALF OF THE COUNCIL
07 JUN 1996

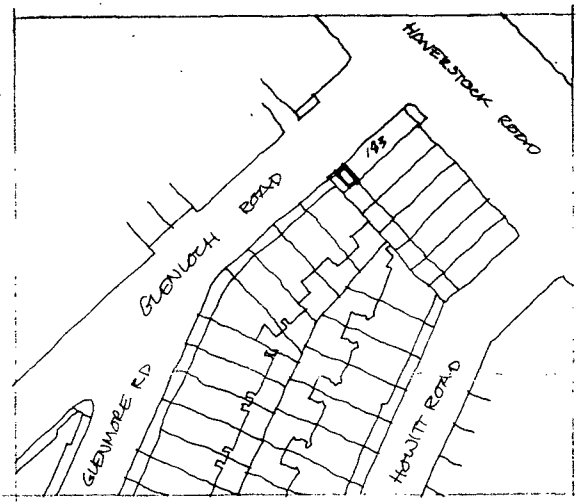

SITE PLAN 1:250

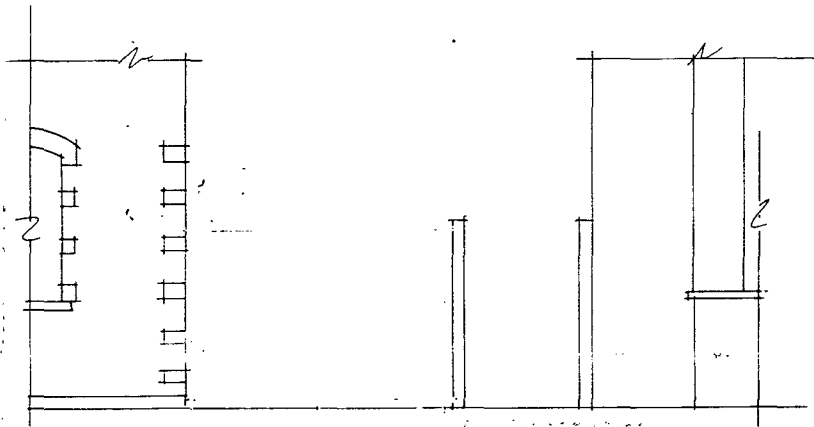

ELEVATION TO STREET

P9600191R1

REV A CAR PARKING SPACE MOVED BACK
FENCE & GATE OMITTED AT FRONT.

CAROLYN SQUIRE JOB NO: 9601/1A
DIPARCH RIBA
104 MILTON GROVE DATE: JAN 96
LONDON N16 8QY
01-254 0624 SCALE: 1:50

PROJECT: 183A HAVERSTOCK HILL
LONDON NW3

DRAWING: PROPOSED CAR
PARKING SPACE