

CI/SFB

AMENDMENTS

M. L. BELCHAMBER Dip. Arch., Dip. T.P., A.R.I.B.A.
 CHIEF ARCHITECT & SURVEYOR,
 METROPOLITAN POLICE OFFICE,
 NEW SCOTLAND YARD,
 10 BROADWAY,
 LONDON, SW1H 0BG.

DRAWN	CHECKED	APPROVED
<i>[Signature]</i>		
DATE	DATE	DATE
FEBRUARY 1983		

SUBJECT PARKING & YARD SPACE

Kentish Town
 Police Station
 Holmes Road
 London NW5 3AE

Site Layout

SCALES
 1" = 35' 9 1/2"

JOB NO. LB 486

DRAWING NO.
 31656 / 150 / 1

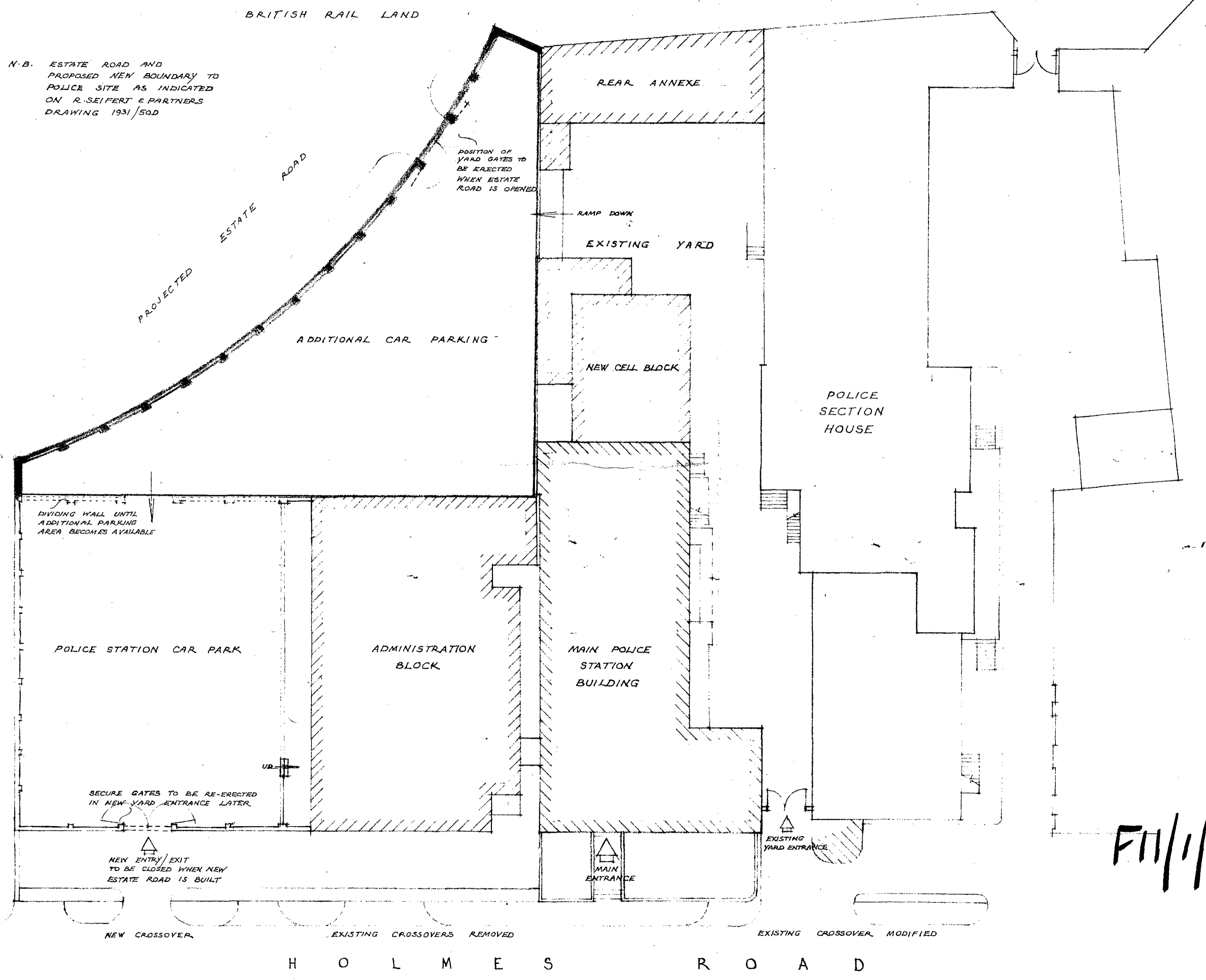

N.B. ESTATE ROAD AND PROPOSED NEW BOUNDARY TO POLICE SITE AS INDICATED ON R. SEIFERT & PARTNERS DRAWING 1931/50D

Handwritten: F11/1/W/35985

NO DIMENSIONS TO BE SCALED FROM THIS DRAWING	PLAN OF WORK STAGE	SYSTEM BUILDING REF	
	MICROFILMING YES/NO DATE TO S&C	AREA NO	DISTRICT LETTER-

AMENDMENTS	
DATE	INTL

M. L. BELCHAMBER, Dip Arch, Dip TP., A.R.I.B.A.
CHIEF ARCHITECT & SURVEYOR,
METROPOLITAN POLICE OFFICE,
NEW SCOTLAND YARD,
10 BROADWAY,
LONDON, SW 1H 0BG 0BG

DRAWN <i>A. W. Stungo</i>	CHECKED	APPROVED
DATE MARCH 1983	DATE	DATE

SUBJECT
PARKING & YARD SPACE

JOB NAME AND ADDRESS
**Kentish Town
Police Station
Holmes Road
London NW5 3AE**

SCALES 1:50 1:200	JOB NO LB 486
REG FILE NO	MINUTE REF NO

DRAWING NO
31656/150/2
Category C1/SfB Sequential Issue & Table 1 No. Suffix

DRAWING NO
31656/150/2
Category C1/SfB Sequential Issue & Table 1 No. Suffix

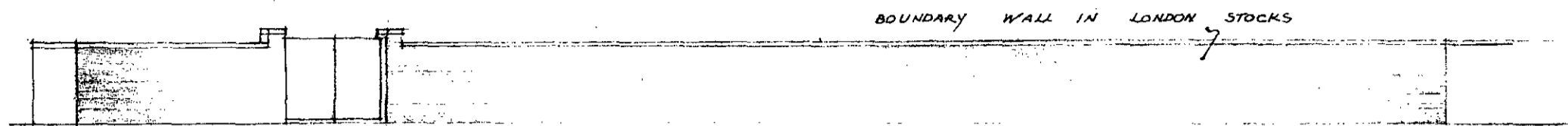

ELEVATION TO ESTATE ROAD (1:200)

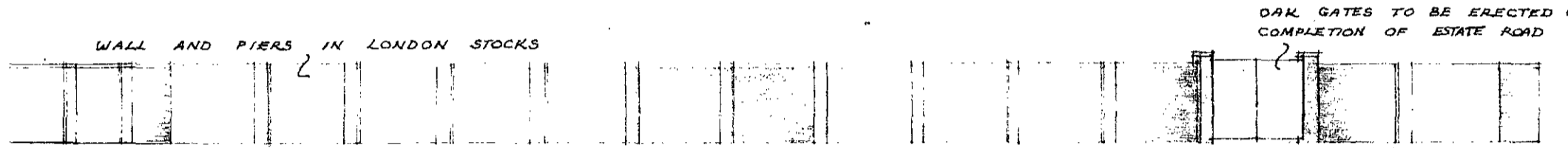

ELEVATION TO POLICE YARD (1:200)

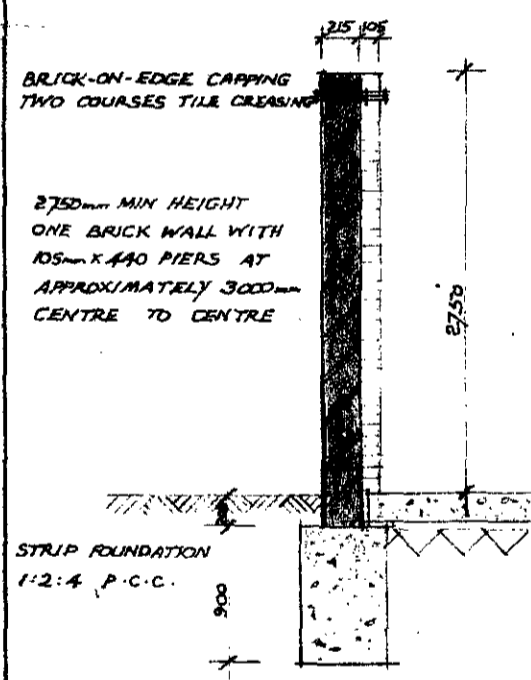

SECTION

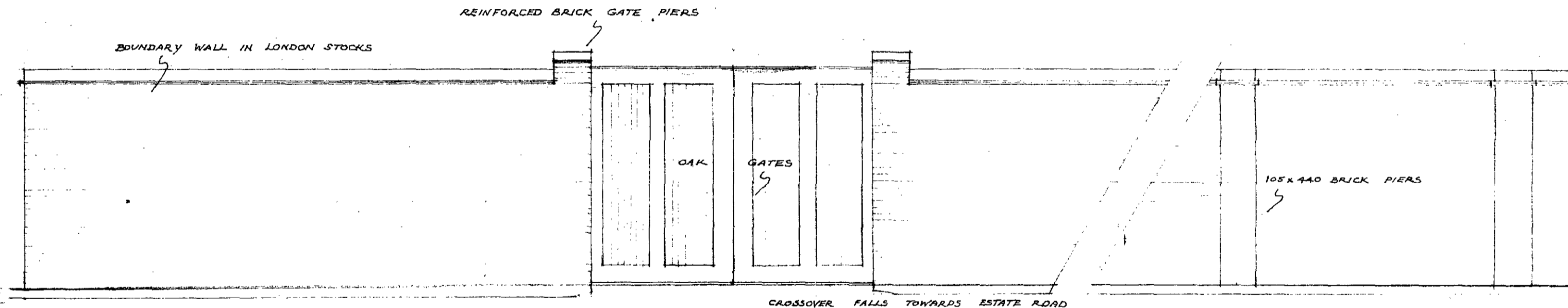

PART ELEVATION TO ESTATE TO POLICE YARD

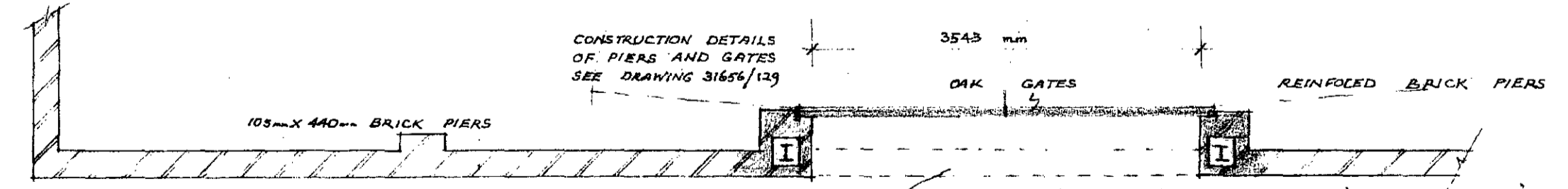

PART PLAN

F11/1/W/35985