

SCHEDULE OF ACCOMMODATION: SOUTHERN SITE

TYPE AA	3 BED 6P HOUSE	16 No.
TYPE B	4 BED 7P HOUSE	10 No.
TYPE E	2 BED 4P (W) FLAT 2 BED 2P FLAT	1 No. 3 No.
TYPE F	2 BED 2P (W) FLAT 2 BED 2P FLAT	1 No. 3 No.
TYPE G	1 BED 2P FLAT 2 BED 4P FLAT	4 No. 4 No.
TYPE H	1 BED 2P FLAT 2 BED 4P FLAT	8 No. 8 No.
TYPE I	2 BED 4P (W) FLAT 2 BED 4P FLAT	1 No. 7 No.
TYPE J	2 BED 4P FLAT	8 No.
TYPE W	1 BED 2P FLAT	8 No.
TOTAL		82 No.
CAR PARKING TOTAL		60 spaces

(W = Wheelchair access)

LONDON BOROUGH OF CAMDEN
TOWARDS COUNTY PLANNING ACTS
06 JAN 1994
PLANS APPROVED
ON BEHALF OF THE COUNCIL

9301122R1

LONDON BOROUGH OF CAMDEN
ENVIRONMENTAL HEALTH
PLANNING DEPARTMENT
13 DEC 1993

Revision B updated: Block G and adjoining AA Blocks curved to follow line of towpath, 2.7m high brick wall to Railway altered; position of railway turntable and associated tracks altered; Oriol window indicated to flank wall of Block W

Revision A: Updated; Block I added in place of Block J (Nov. 93)

POLLARD THOMAS & EDWARDS ARCHITECTS
18 ESSEX ROAD, LONDON N1 8LN FAX: 071-354 0884 TELEPHONE: 071-359 7

JOB TITLE	CAMDEN GOODS YARD	SCALE	1:200	DATE	8.93
DRAWING TITLE	SOUTHERN SITE	JOB No.	92/4-42	DWG No.	PL102
	PROPOSED SITE LAYOUT			REV. No.	B



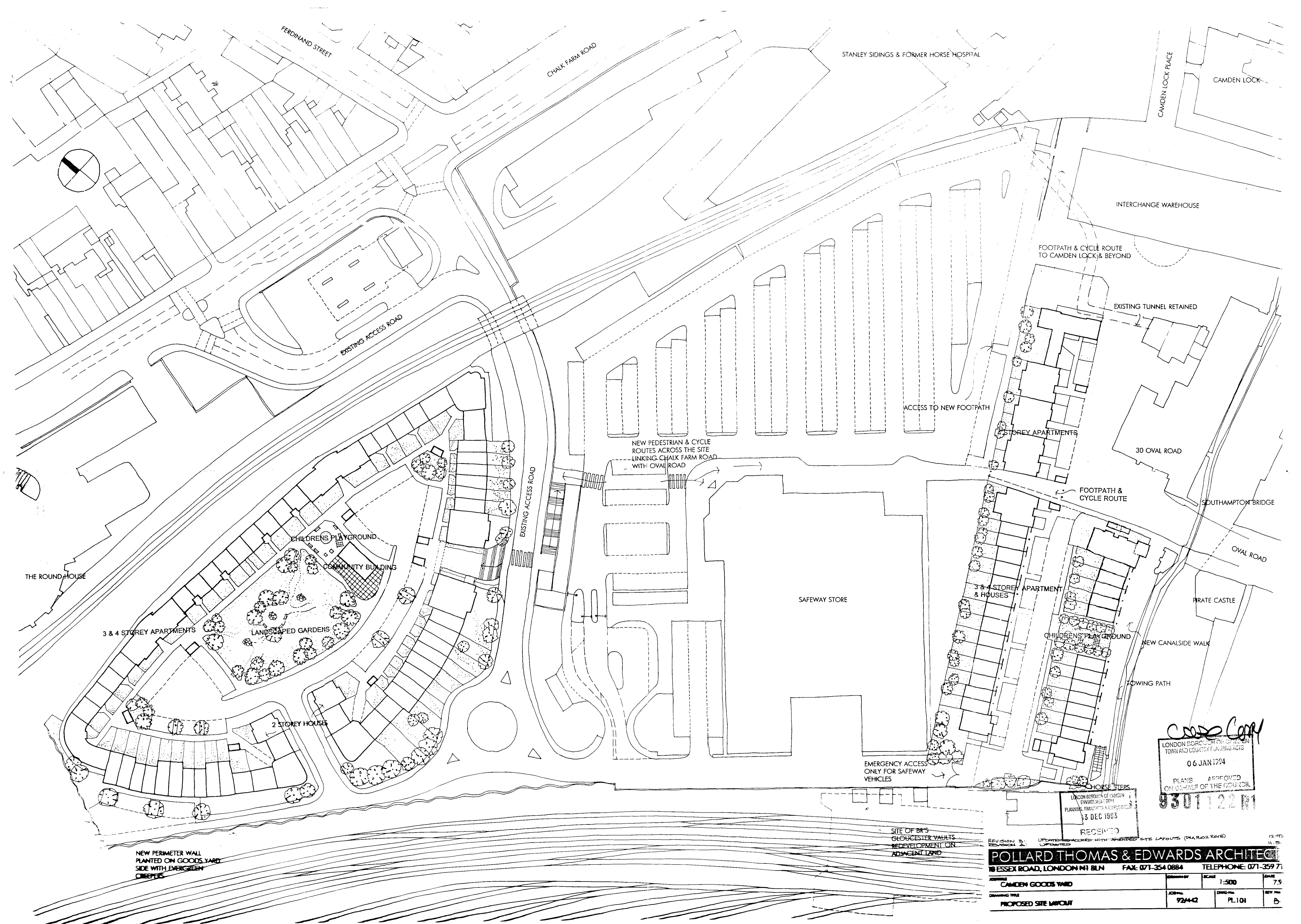

NEW PERIMETER WALL
PLANTED ON GOODS YARD
SIDE WITH EVERGREEN
CREEPERS

SITE OF BR'S
GLOUCESTER VAULTS
REDEVELOPMENT ON
ADJACENT LAND

Case Copy
LONDON BOROUGH OF CAMDEN
TOWN AND COUNTRY PLANNING ACTS
06 JAN 1994
PLANS APPROVED
ON BEHALF OF THE COUNCIL
9301122 R1

LONDON BOROUGH OF CAMDEN
ENVIRONMENT DEPT
PLANNING, TRANSPORT & RECREATION
13 DEC 1993

RECEIVED

REVISION 1: UPDATED TO ACCORD WITH APPROVED SITE LAYOUTS (PLA FLOOR REVISED)
REVISION 2: UPDATED

POLLARD THOMAS & EDWARDS ARCHITECTS			
18 ESSEX ROAD, LONDON N1 6LN		FAX: 071-354 0884	TELEPHONE: 071-359 71
PROJECT	CAMDEN GOODS YARD	SCALE	1:500
DRAWING TITLE	PROPOSED SITE LAYOUT	DATE	7.9
		REV. NO.	B

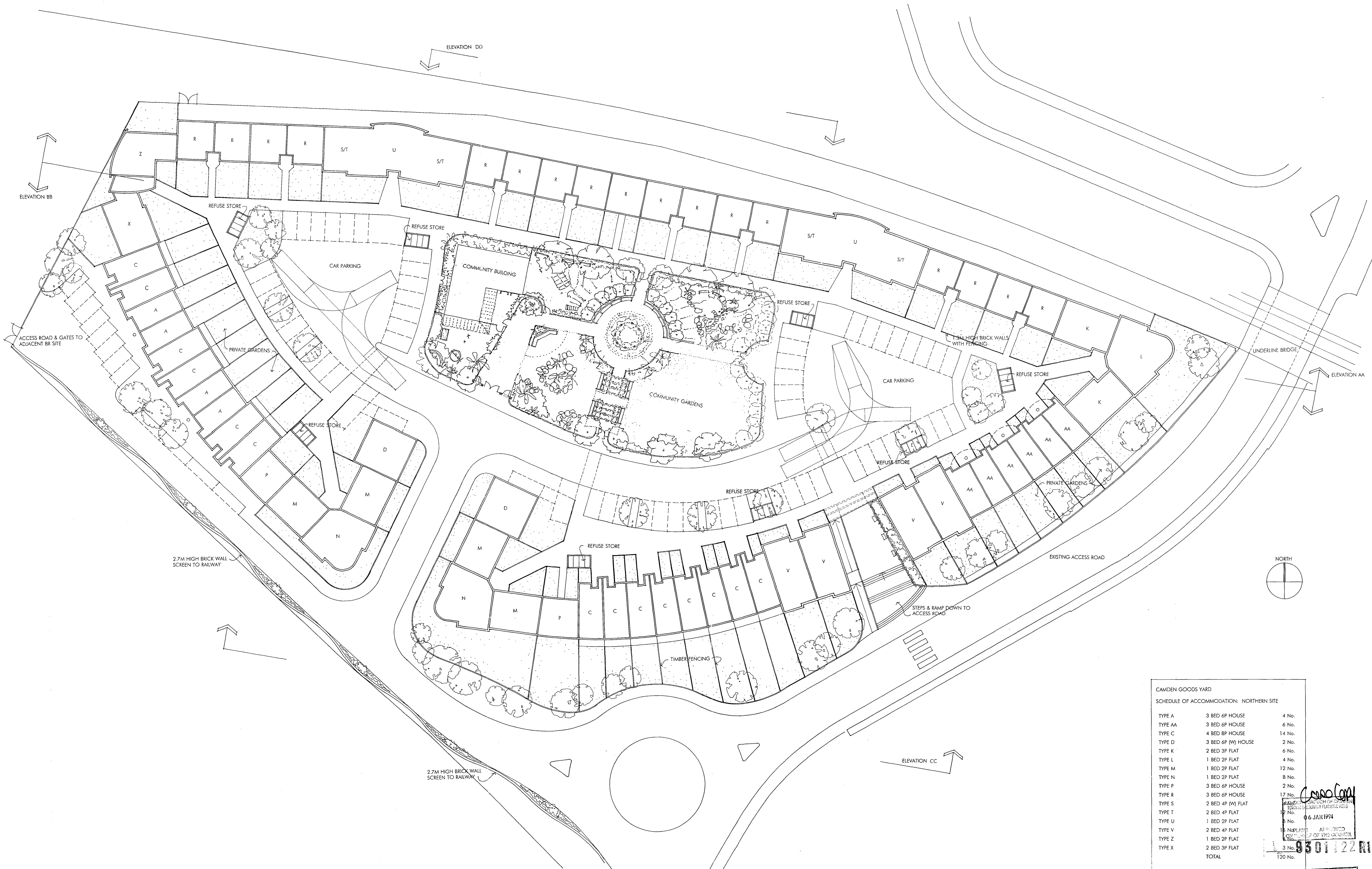

CAMDEN GOODS YARD
SCHEDULE OF ACCOMMODATION: NORTHERN SITE

TYPE A	3 BED 6P HOUSE	4 No.
TYPE AA	3 BED 6P HOUSE	6 No.
TYPE C	4 BED 8P HOUSE	14 No.
TYPE D	3 BED 6P (W) HOUSE	2 No.
TYPE K	2 BED 3P FLAT	6 No.
TYPE L	1 BED 2P FLAT	4 No.
TYPE M	1 BED 2P FLAT	12 No.
TYPE N	1 BED 2P FLAT	8 No.
TYPE P	3 BED 6P HOUSE	2 No.
TYPE R	3 BED 6P HOUSE	17 No.
TYPE S	2 BED 4P (W) FLAT	12 No.
TYPE T	2 BED 4P FLAT	12 No.
TYPE U	1 BED 2P FLAT	6 No.
TYPE V	2 BED 4P FLAT	18 No.
TYPE Z	1 BED 2P FLAT	3 No.
TYPE X	2 BED 3P FLAT	3 No.
TOTAL		120 No.

Case.com
 APPROVED
 06 JAN 1994
 9301122 R1

CAR PARKING - 75 SPACES

Revision B: General Revisions Dec. 93
 Revision A: Updated (Nov. 93)

POLLARD THOMAS & EDWARDS ARCHITECTS
 18 ESSEX ROAD, LONDON N1 8LN FAX: 071-354 0884 TELEPHONE: 071-359 7121

JOB TITLE	CAMDEN GOODS YARD NORTHERN SITE	SCALE	DATE
DRAWING TITLE	PROPOSED SITE LAYOUT	1 : 200	11.93
JOB No.	92/442	DWG No.	PL103
REV. No.			B