

19 WADHAM GARDENS : LONDON NW3
SITE LOCATION PLAN
SCALE 1:1250

LONDON BOROUGH OF CAMDEN
TOWN AND COUNTRY PLANNING ACTS
30 MAY 2002
PLANS NOT APPROVED
ON BEHALF OF THE COUNCIL

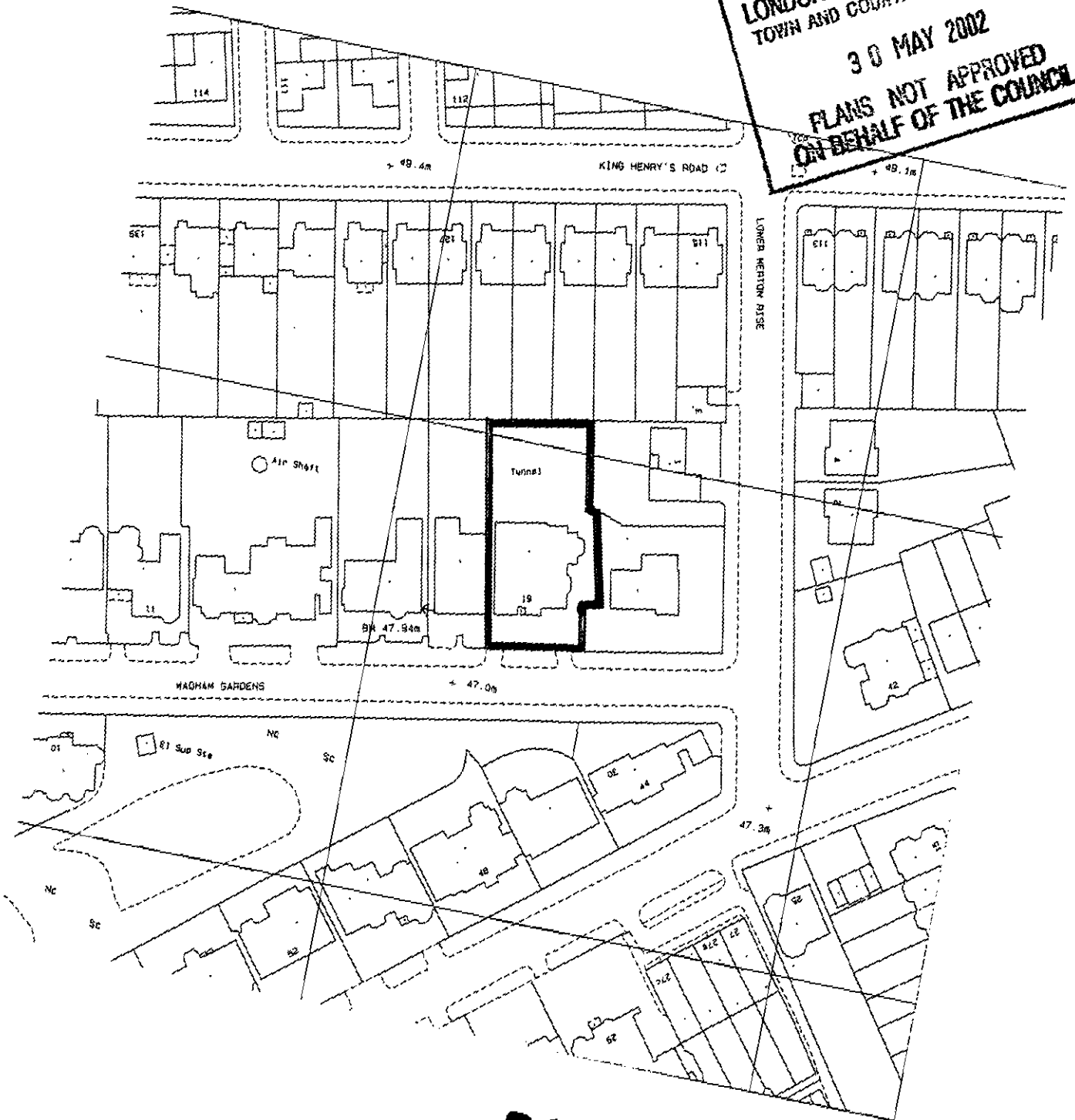

PEX0101049

■ Buchanan Associates Architects

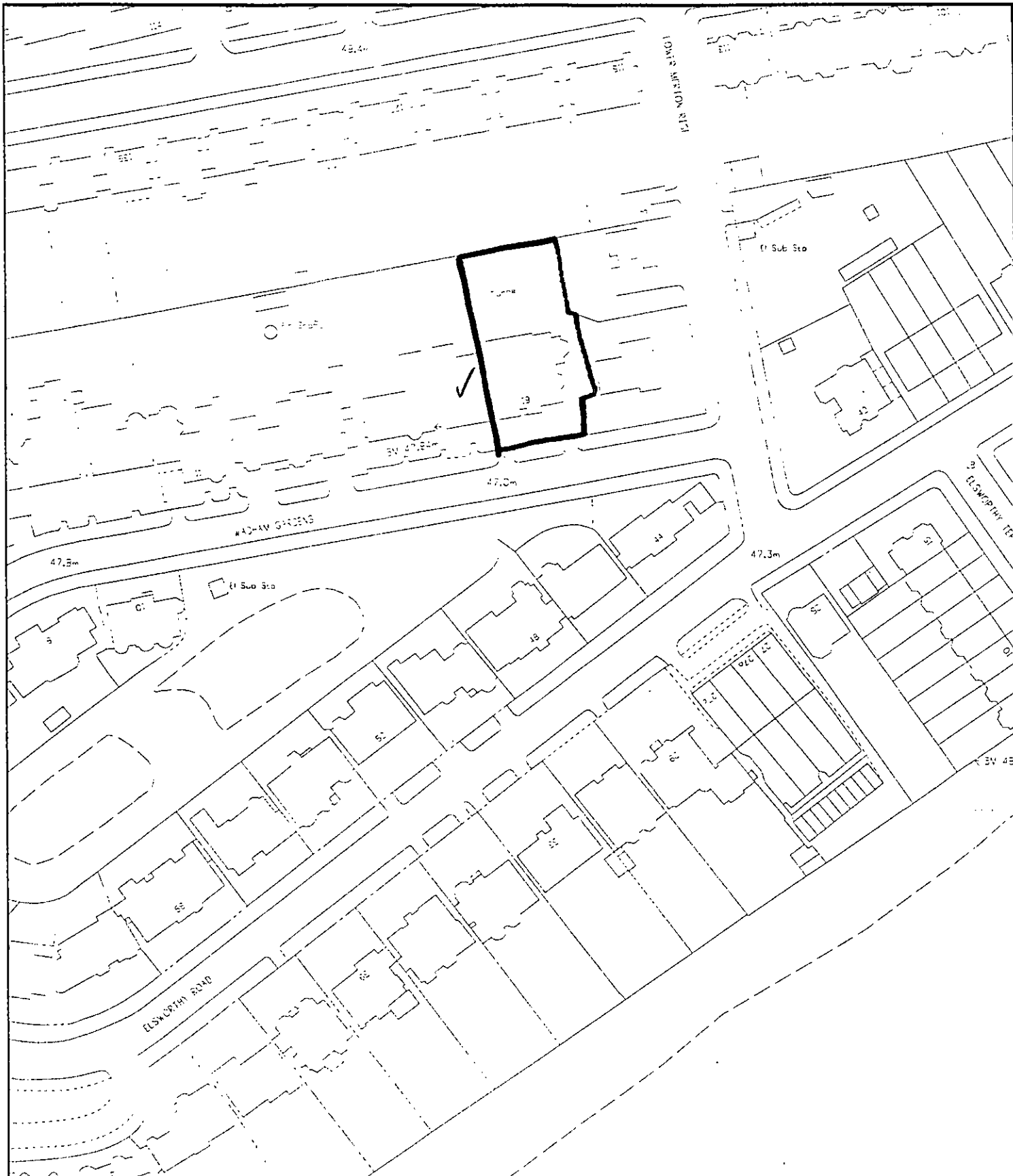

Reproduced from the OS map with the permission of the Controller of H.M.S.O. Licence No. LA086339.

London Borough of Camden 19 Wadham Gardens

Environment Department
Town Hall Extension
Argyle Street Entrance
London WC1H 8EQ

79/12

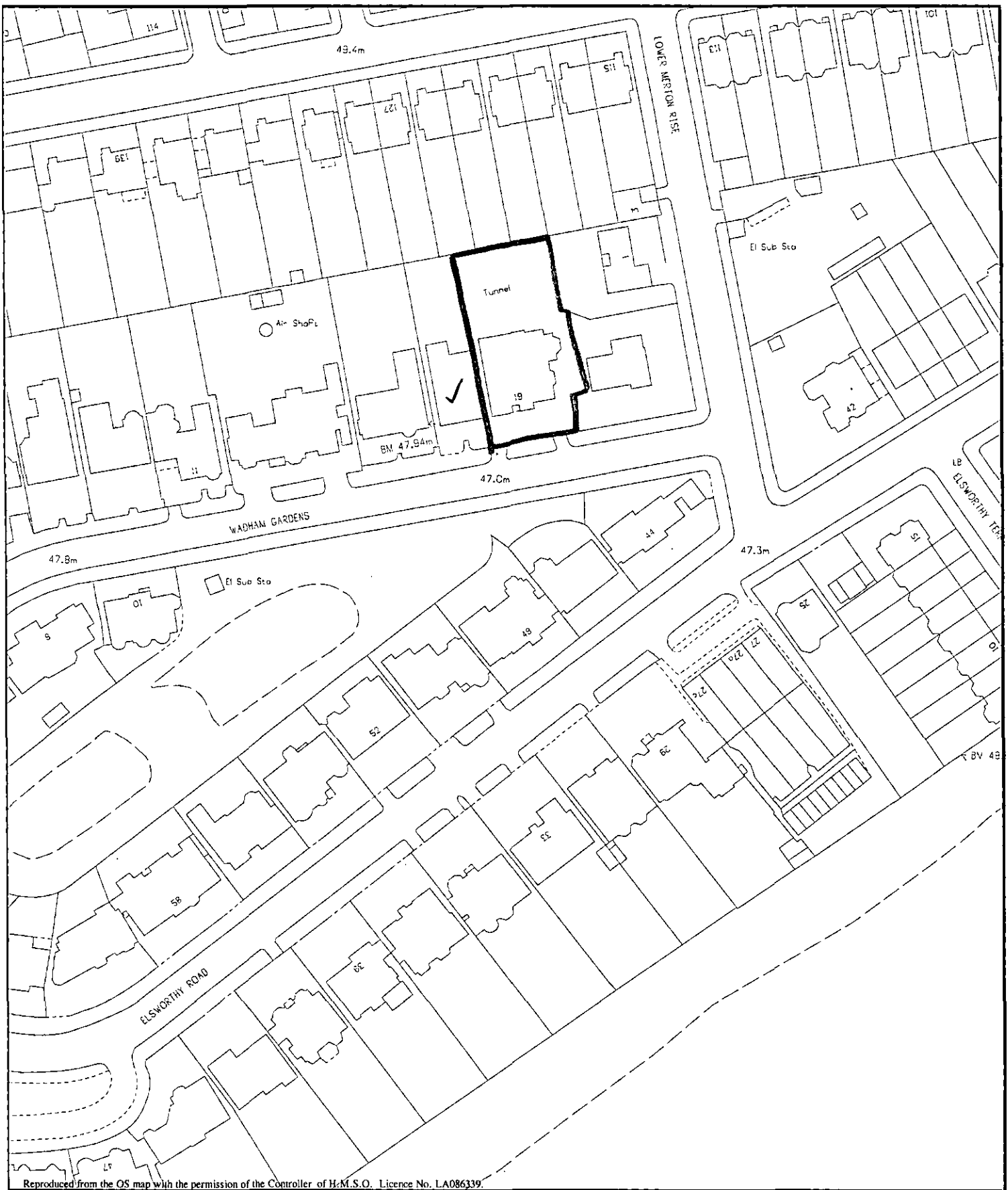

Reproduced from the OS map with the permission of the Controller of H.M.S.O. Licence No. LA086339.

London Borough of Camden 19 Wadham Gardens

Environment Department
 Town Hall Extension
 Argyle Street Entrance
 London WC1H 8EQ