

**notes**  
 Check all dimensions on site before starting work

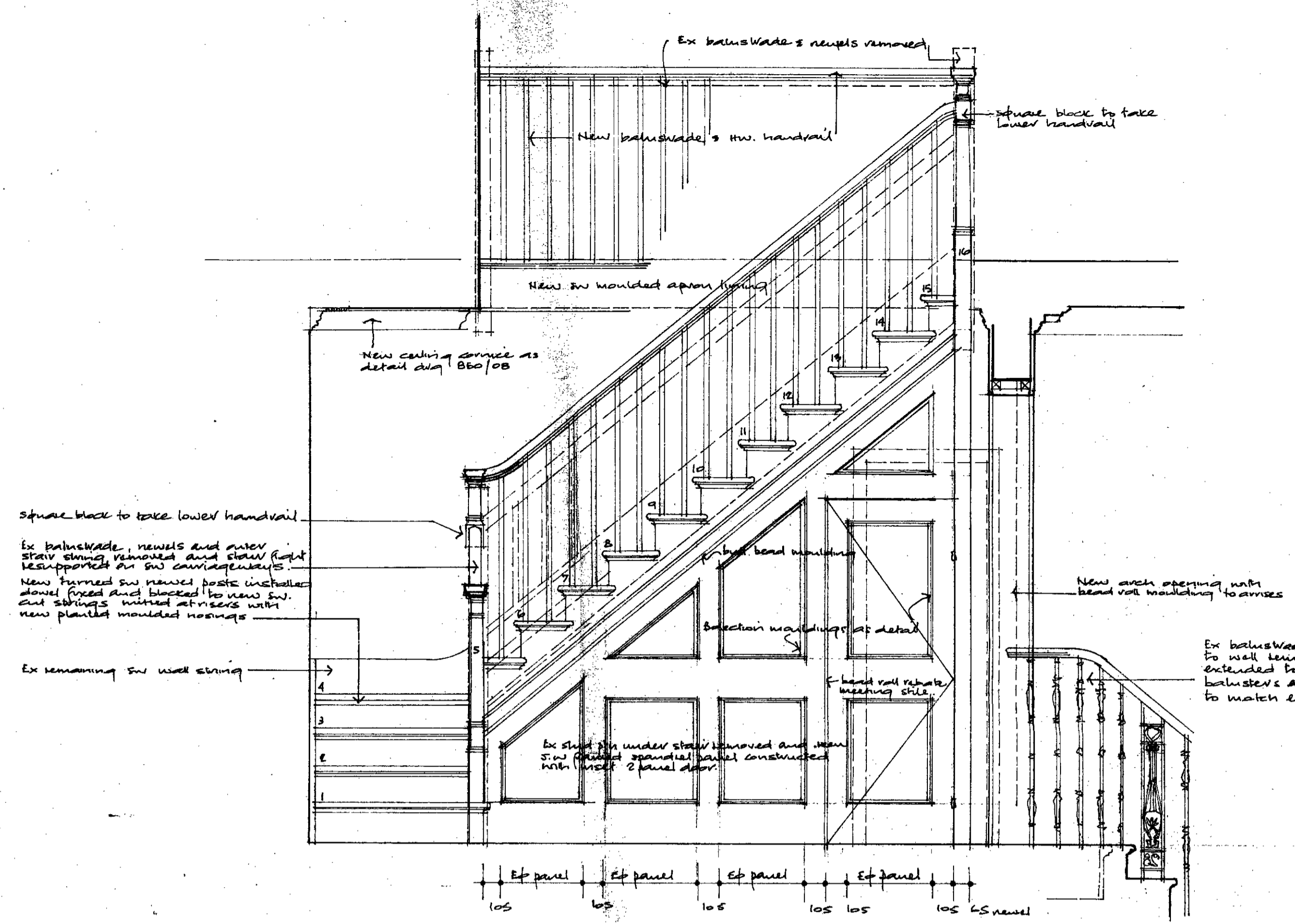

CROSS SECTION A . A

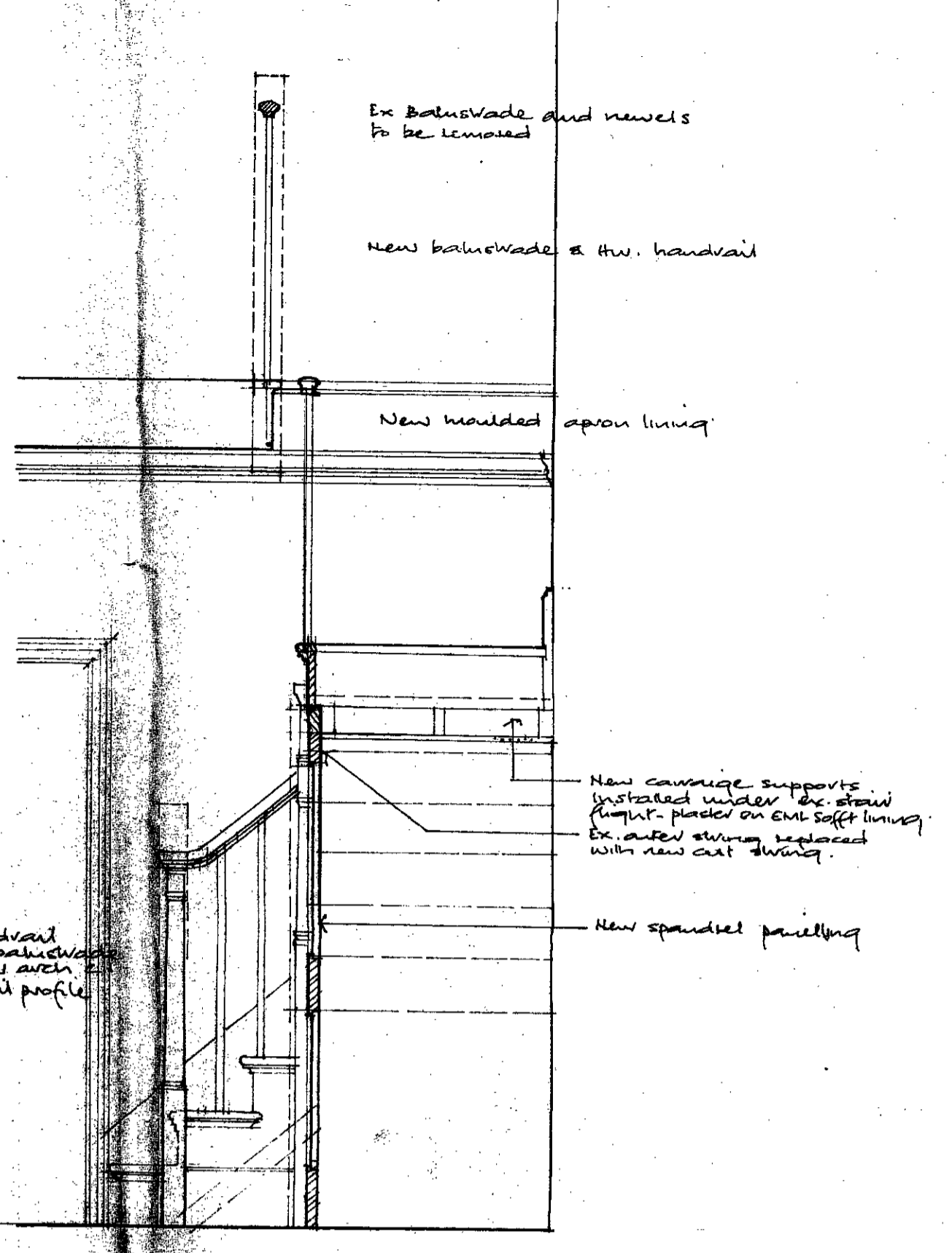

CROSS SECTION B . B

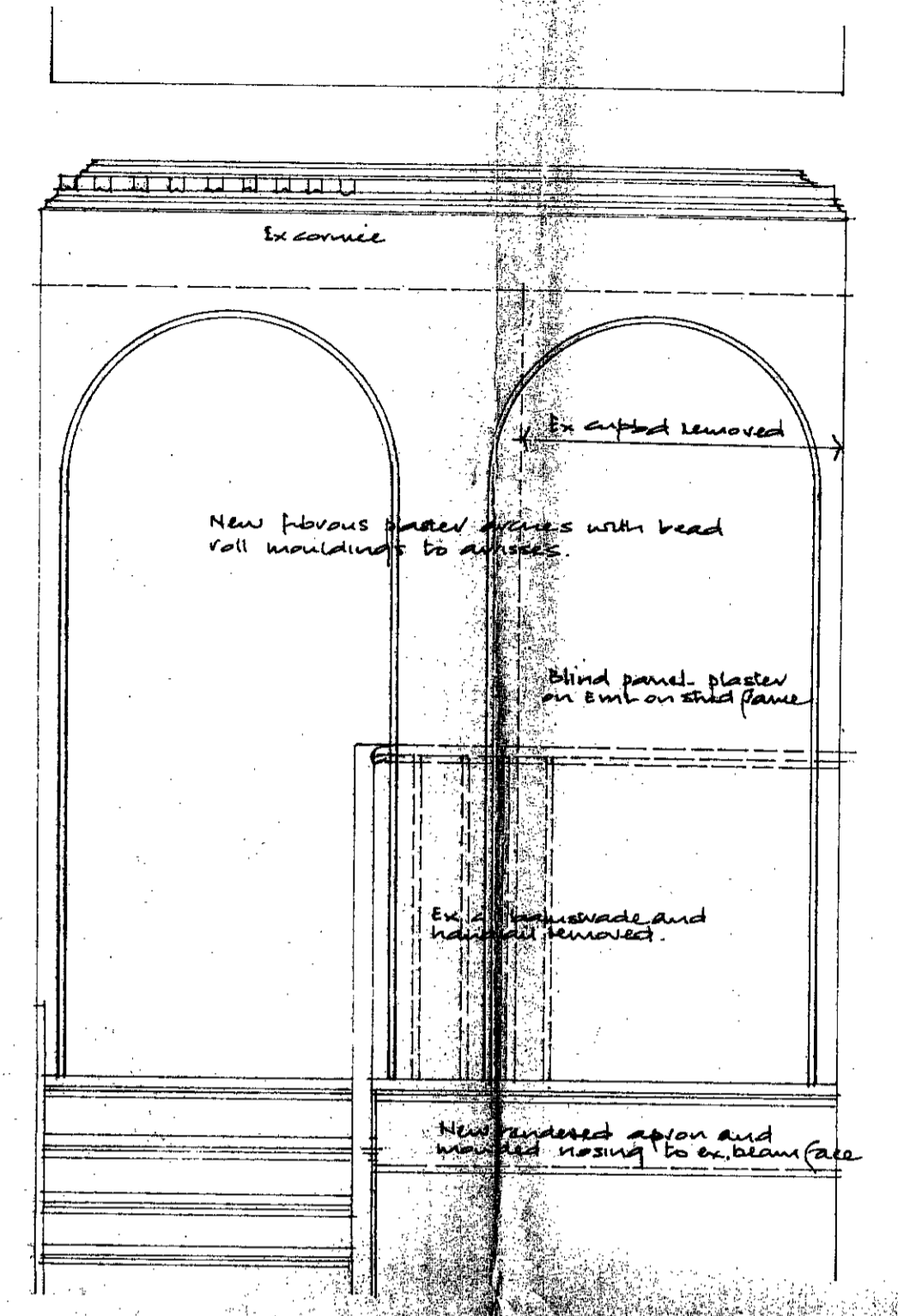

SECTION C . C

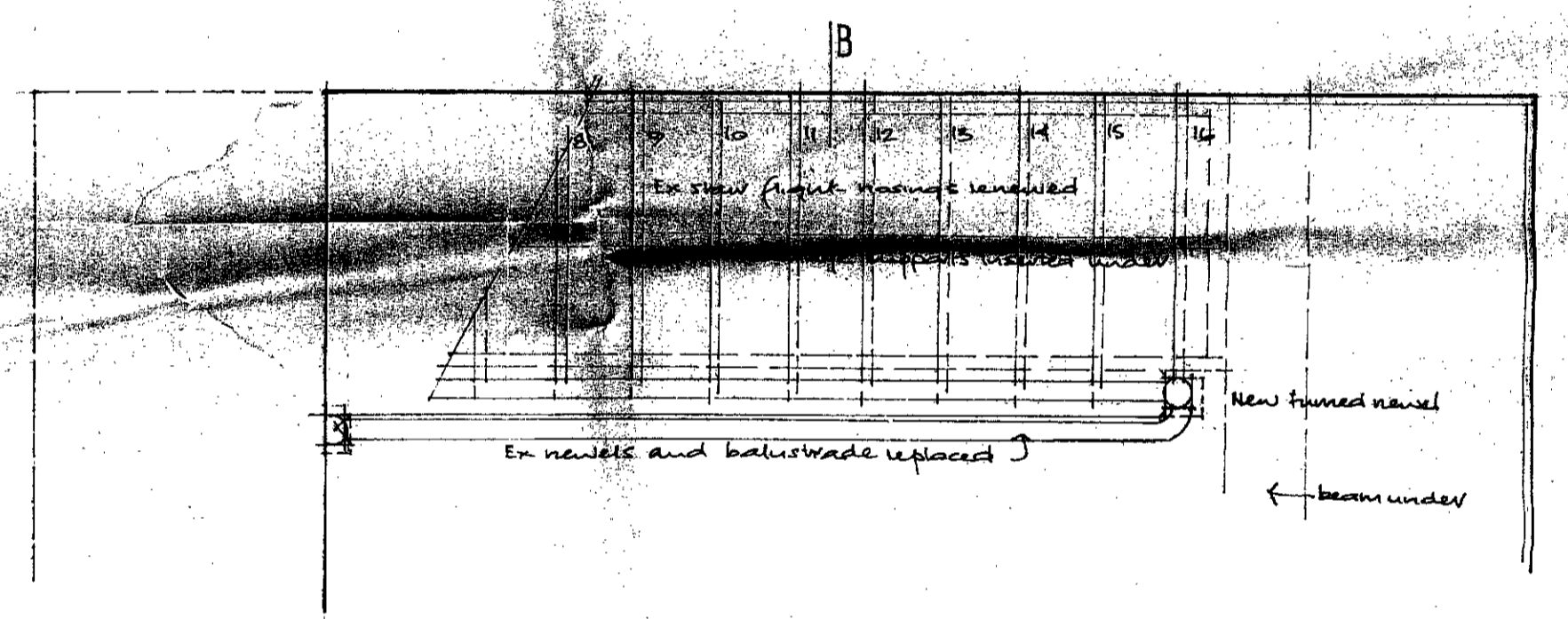

THIRD FLOOR PLAN

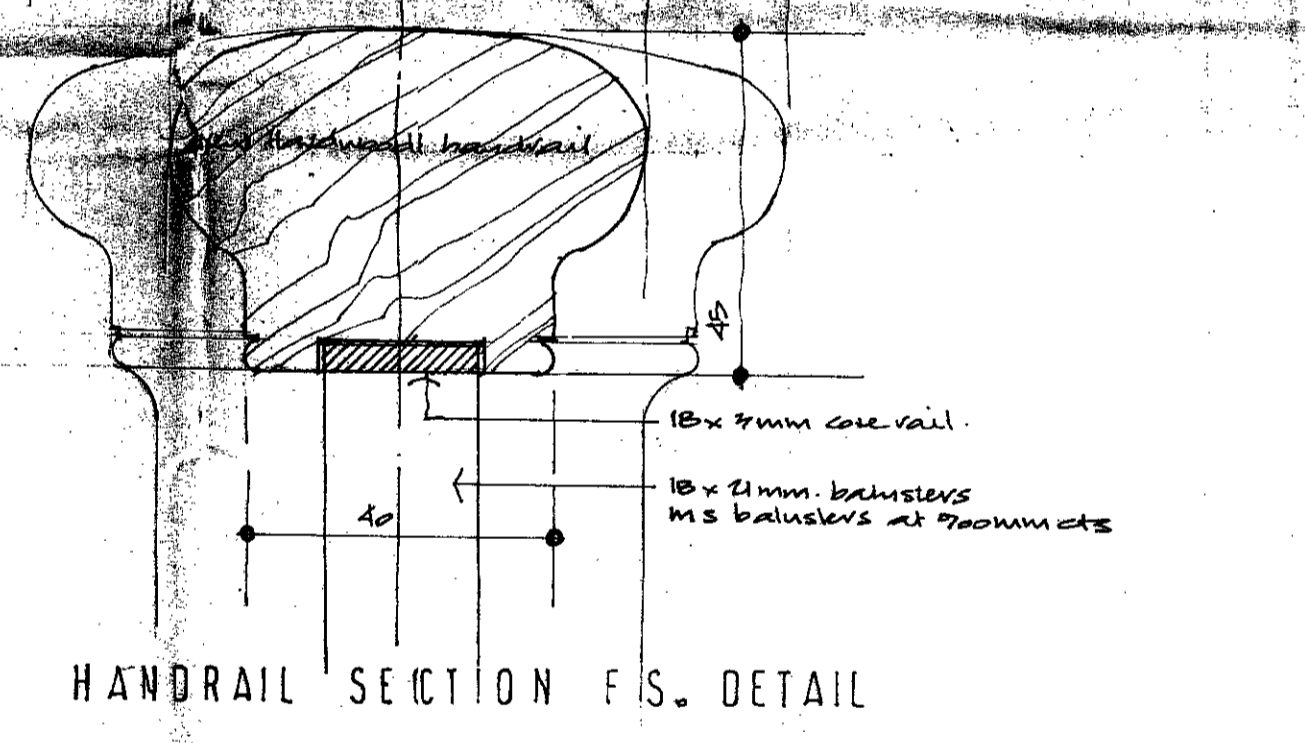

HANDRAIL SECTION FS. DETAIL

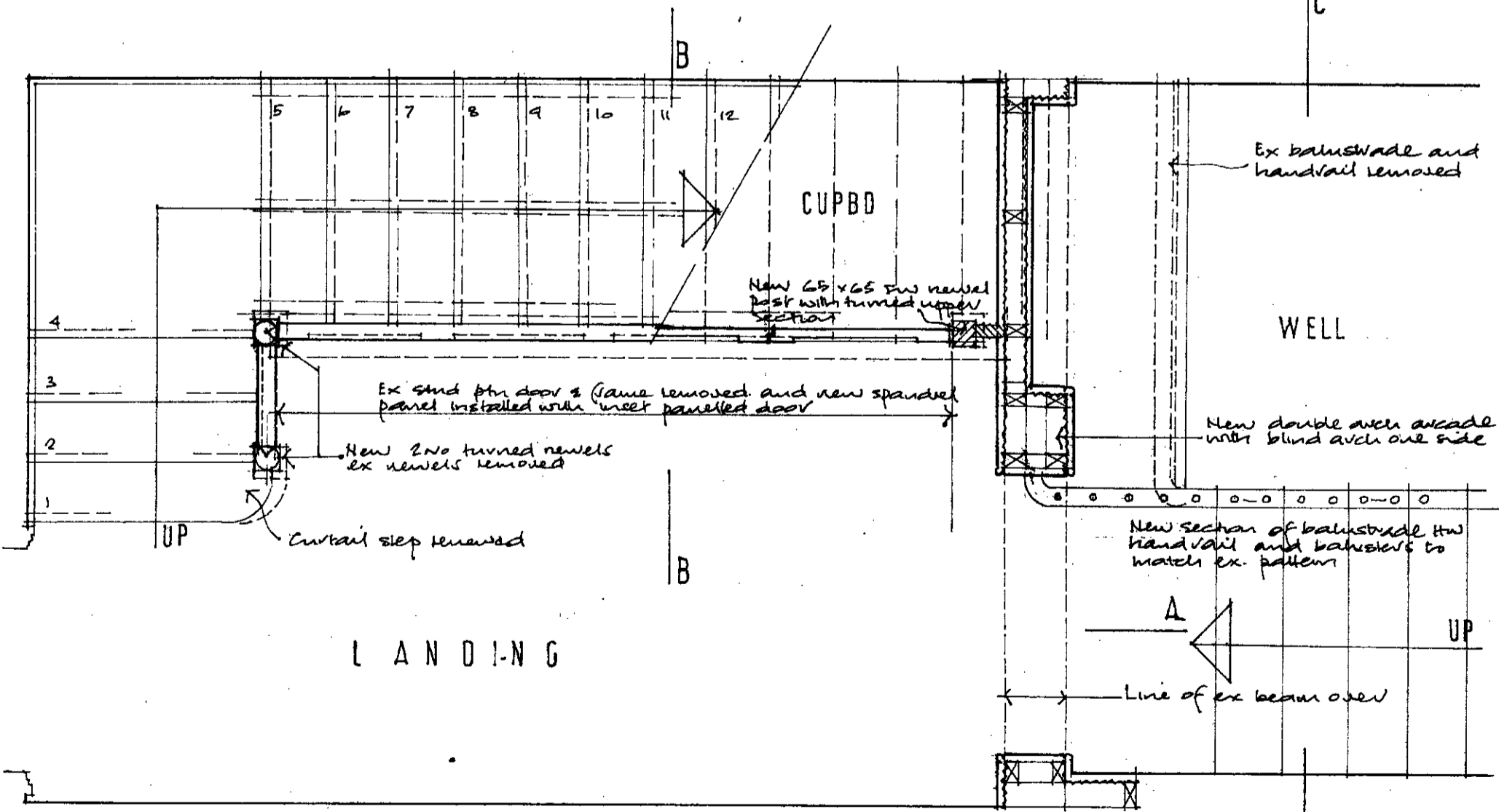

SECOND FLOOR PLAN

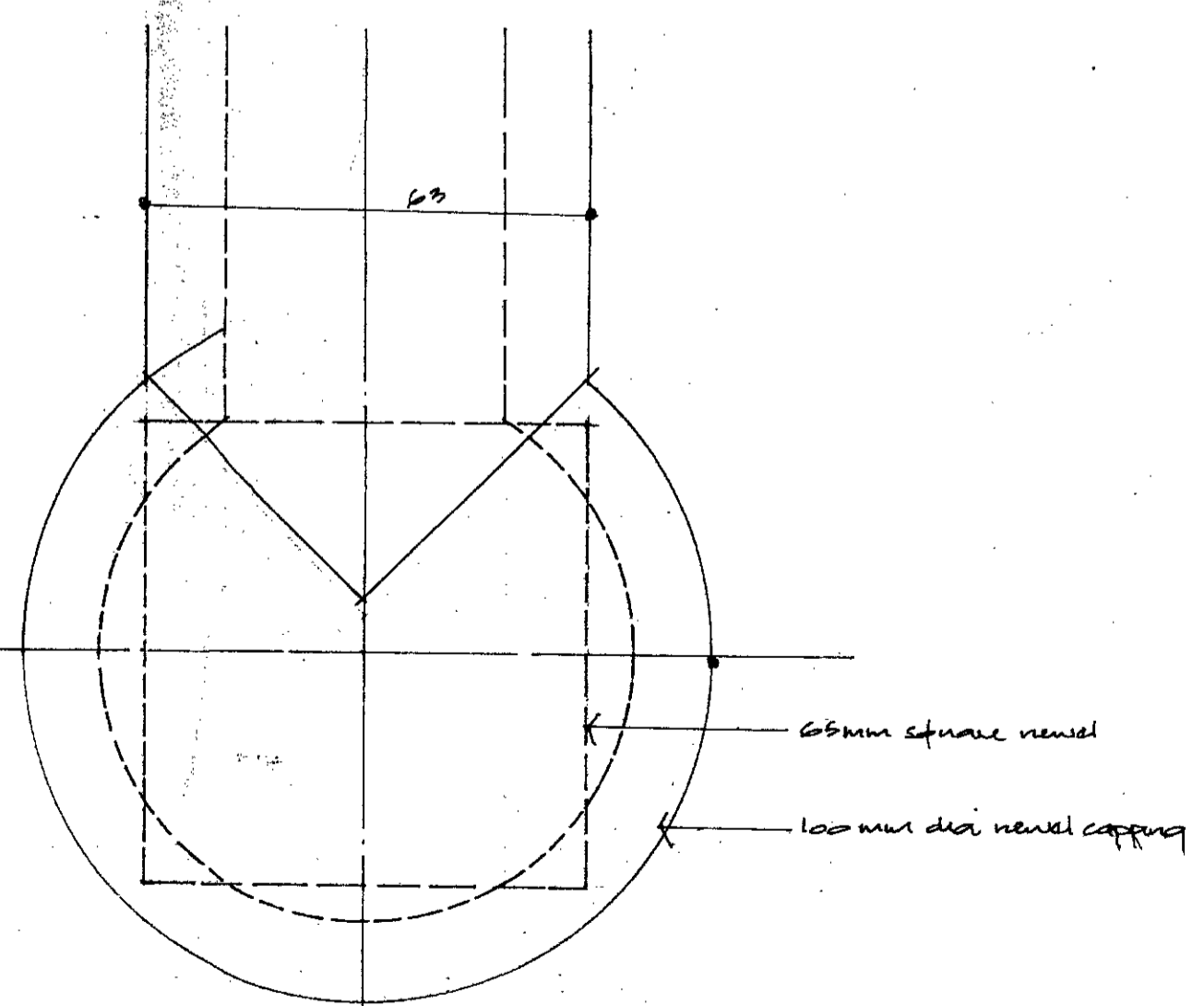

PLAN AT NEWEL POST FS DETAIL

LONDON BOROUGH OF CAMDEN  
 PLANNING AND TRANSPORT  
 DEPARTMENT  
 18 JUL 1988  
 RECEIVED

LONDON BOROUGH OF CAMDEN  
 TOWN AND COUNTRY PLANNING ACTS  
 - 7 AUG 1988  
 APPROVED  
 PLANS  
 ON BEHALF OF THE COUNCIL

HB 887 0321

8870321

55 CUMBERLAND TERRACE  
 LONDON  
 AND 29 CUMBERLAND TERRACE MEWS  
 DRAWING SHOWING MODIFICATIONS  
 TO EXISTING STAIRCASE FLIGHT  
 FROM 2ND TO 3RD FLOOR

drawing number 850/09  
 scale 1:20  
 date  
 drawn by

Westwood, Piet, Poole & Smart  
 Chartered Architects  
 22 Suffolk Street London SW1Y 4HU  
 01-839 1106

**notes**

Check all dimensions on site before starting work.

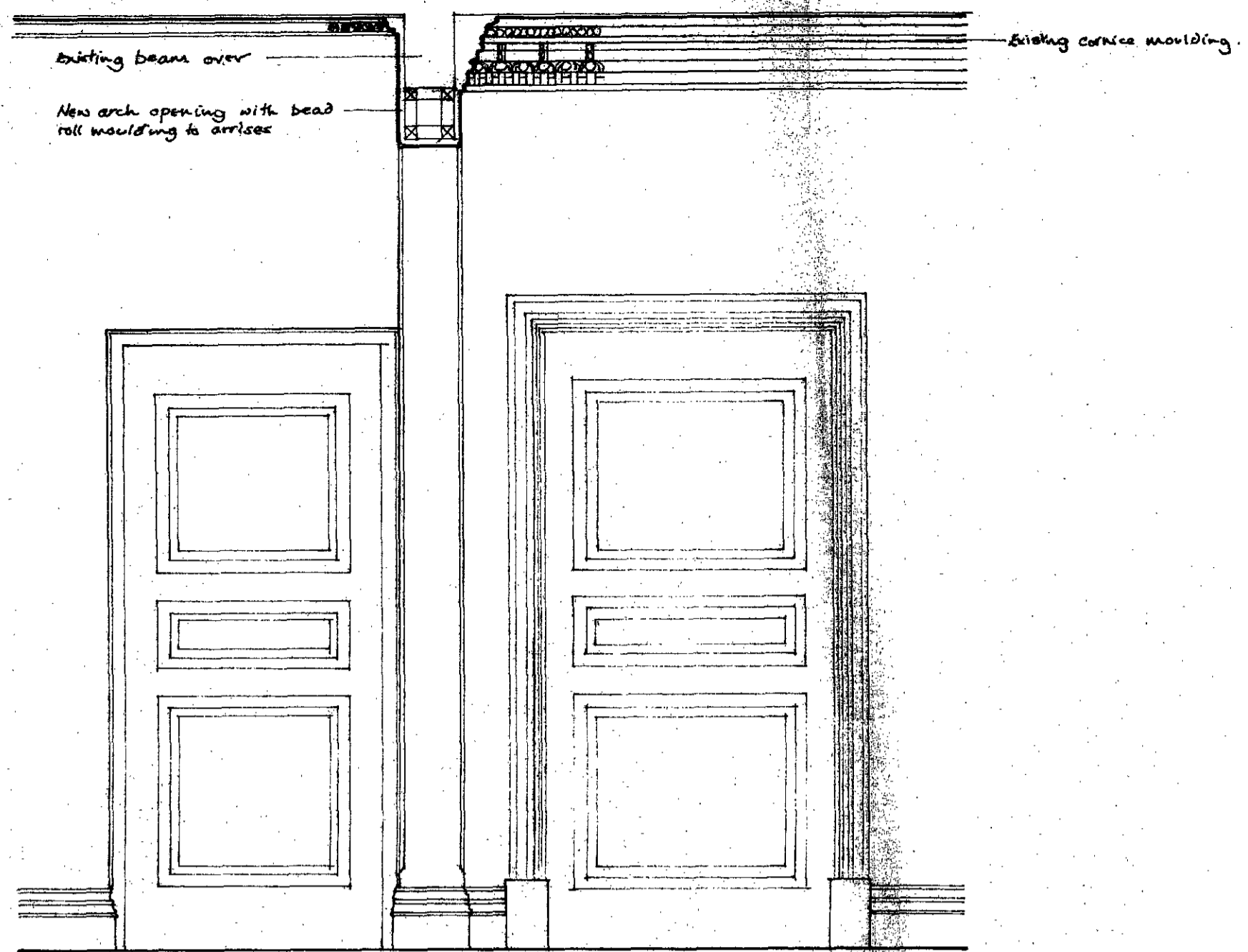

SECTION A - A

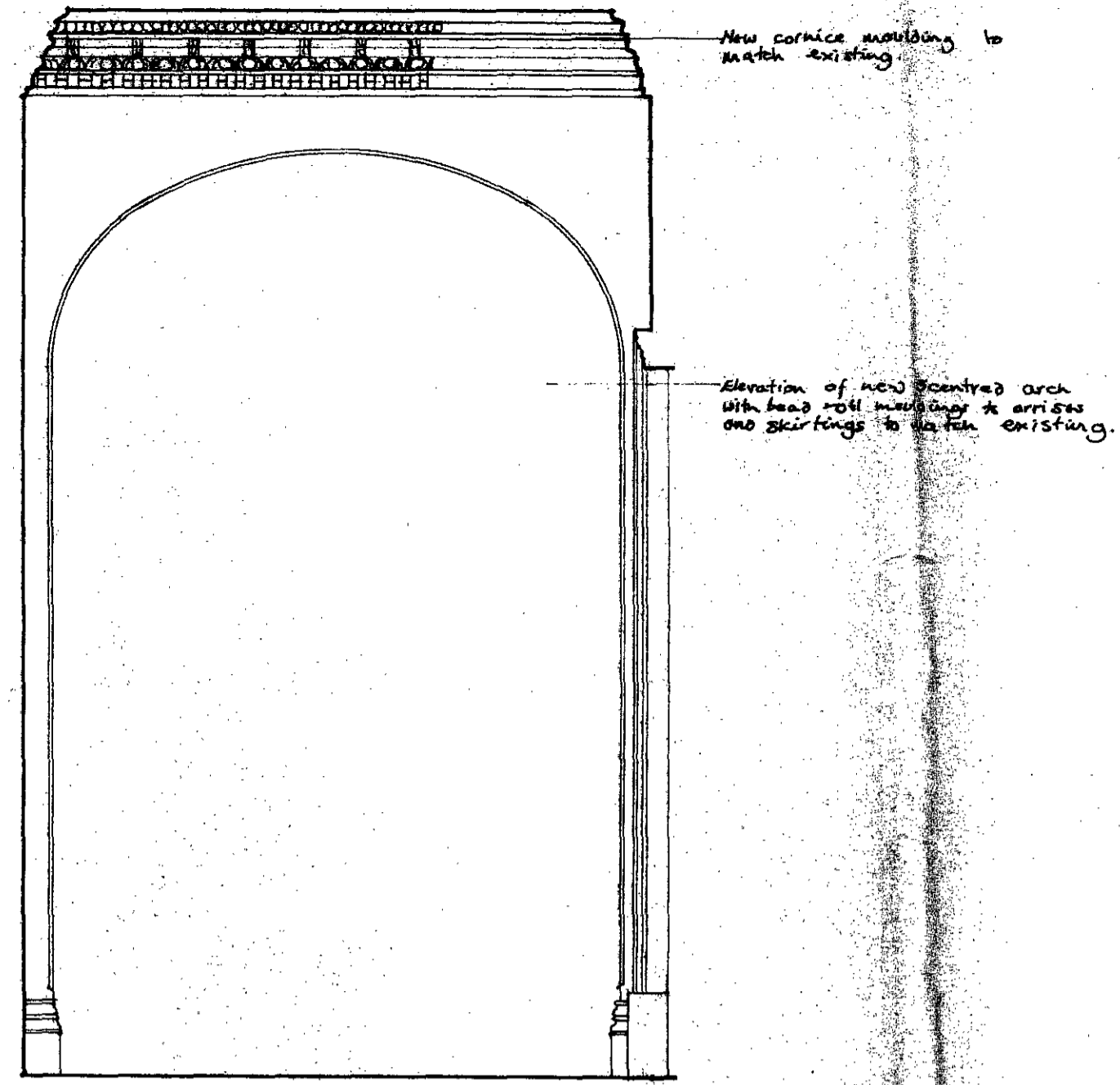

SECTION B - B

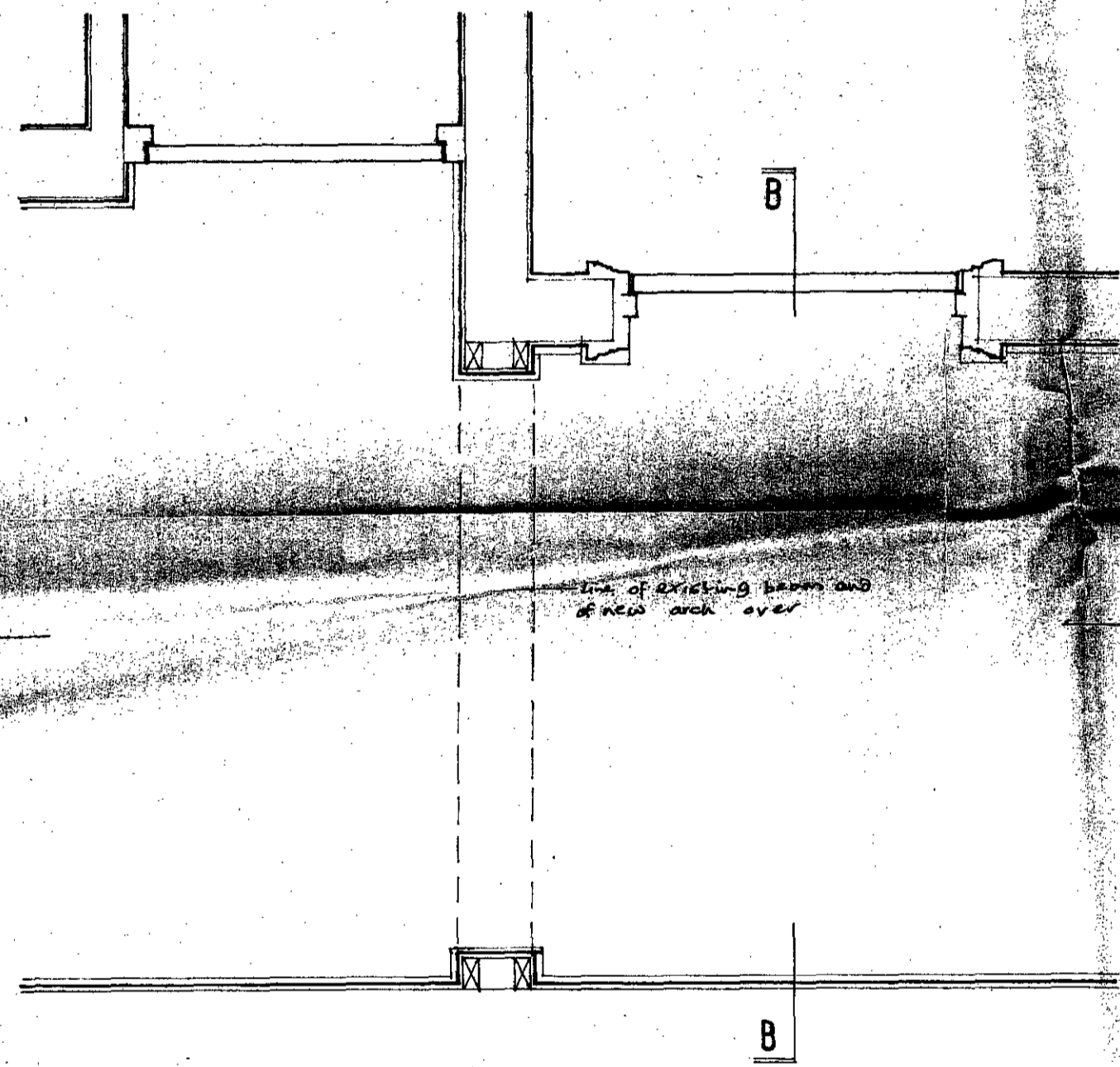

PLAN - GROUND FLOOR ENTRANCE HALL

DRAWING TO SHOW NEW ARCH IN ENTRANCE HALL  
SCALE 1:20

DETAILS OF EXISTING MOULDINGS FOR MATCHING SCALE 1:1

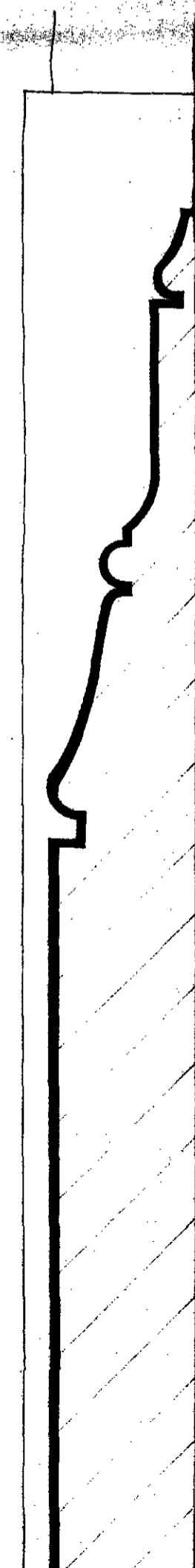

Skirting to be used on staircases & landings and is a repeat of the existing in the ground floor entrance hall

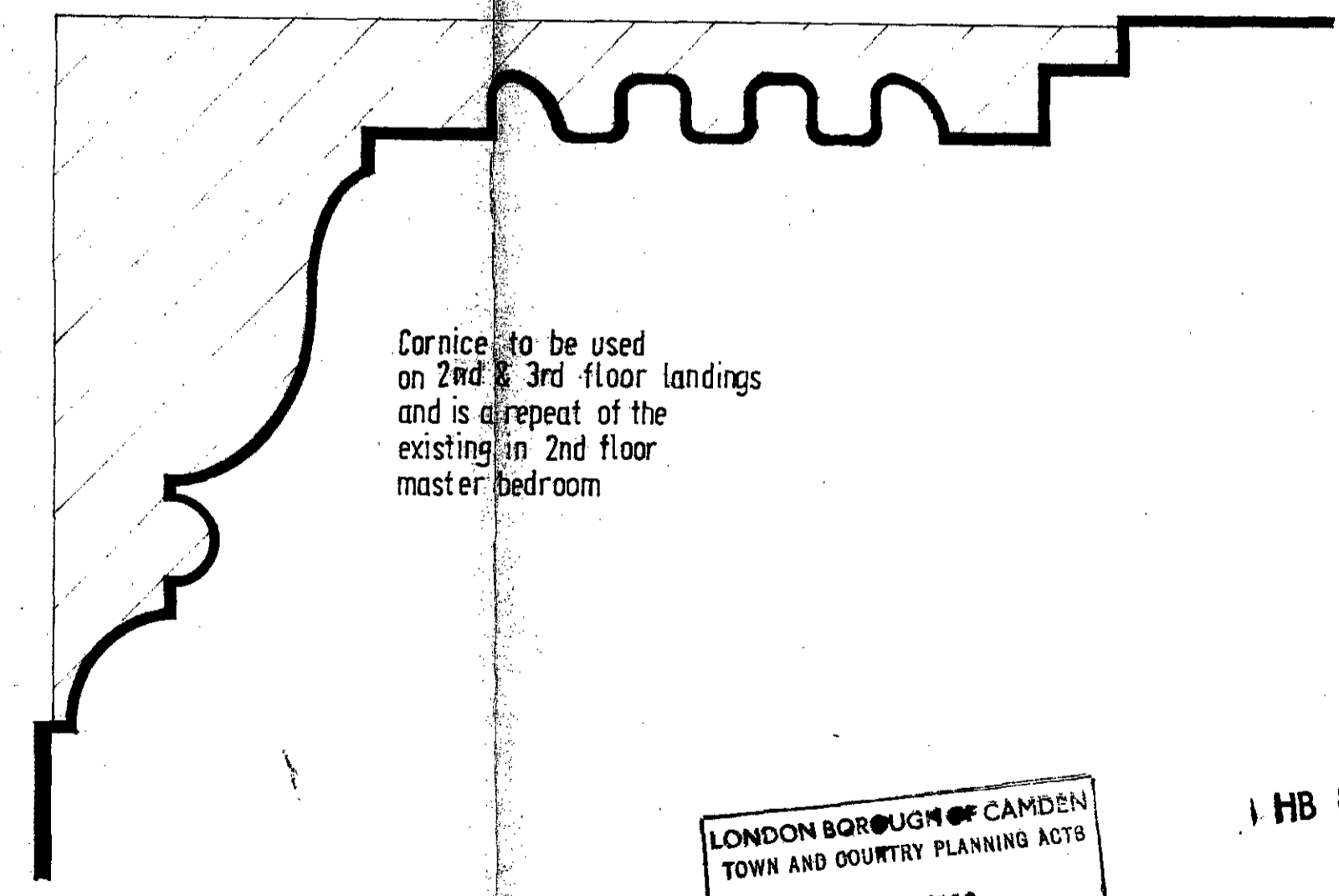

Cornice to be used on 2nd & 3rd floor landings and is a repeat of the existing in 2nd floor master bedroom

LONDON BOROUGH OF CAMDEN  
PLANNING AND TRANSPORT  
DEPARTMENT  
18 JUL 1988  
RECEIVED

LONDON BOROUGH OF CAMDEN  
TOWN AND COUNTRY PLANNING ACTS  
- 4 AUG 1988  
PLANS APPROVED  
ON BEHALF OF THE COUNCIL

HB 8870321

8870321

55 CUMBERLAND TERRACE LONDON AND 29 CUMBERLAND TERRACE MEWS	drawing number 850/08
DETAILS	scale 1:20 / 1:1
	date
	drawn by

**The Westwood Partnership**  
Chartered Architects  
22 Suffolk Street London SW1Y 4HU 01-839 1106