

OUTLINE OF QUEEN'S BUILDING

LONDON COUNTY COUNCIL  
 23690 10-9-64  
 ARCHITECT'S REGISTRY

2 story lecture room west wing  
 adjoining main block

'SELIN COURT'  
 existing building at  
 west end of site

approx ground level

\* Basement window  
 (workshop)

\* adjacent to main block

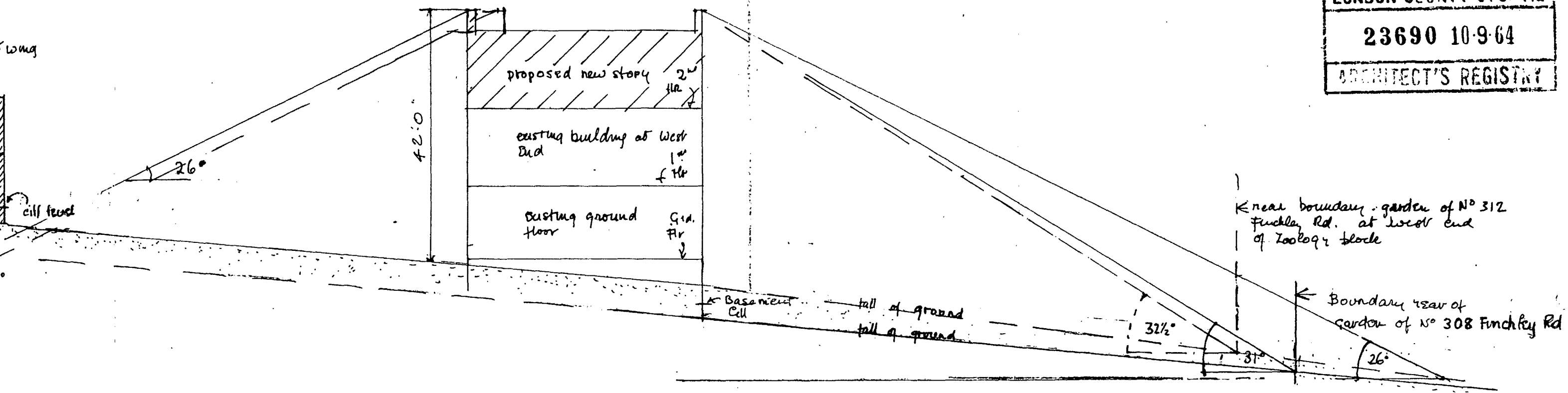

← N

SECTION LOOKING EAST

WESTFIELD COLLEGE LONDON N.W.3.			
ZOOLOGY WING			
Proposed additions. LIGHT ANGLES			
1/16" = 1ft.	DATE + 9. 64	REVISED	DRG NO. W.Z. 12
Rees Lawrence & Mitchell chartered architects 38 Holland Villas Road London. W.14			