

**- PROPOSED GARAGE AT 20 REDINGTON ROAD - NW3 -**

RECEIVED  
30 SEP 1988  
DEPARTMENT  
PLANNING AND TRANSPORT  
LONDON BOROUGH OF CAMDEN

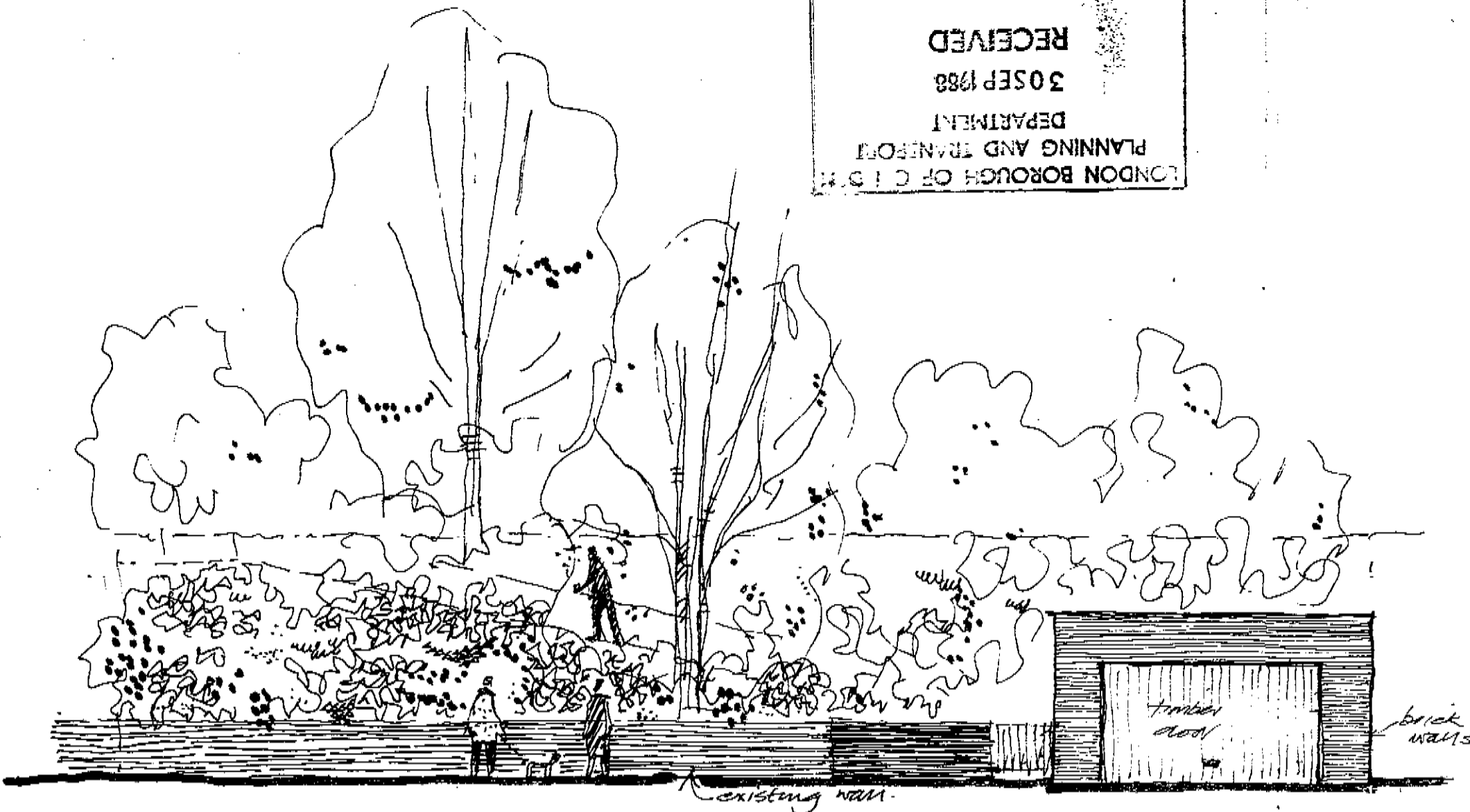

- ELEVATION -

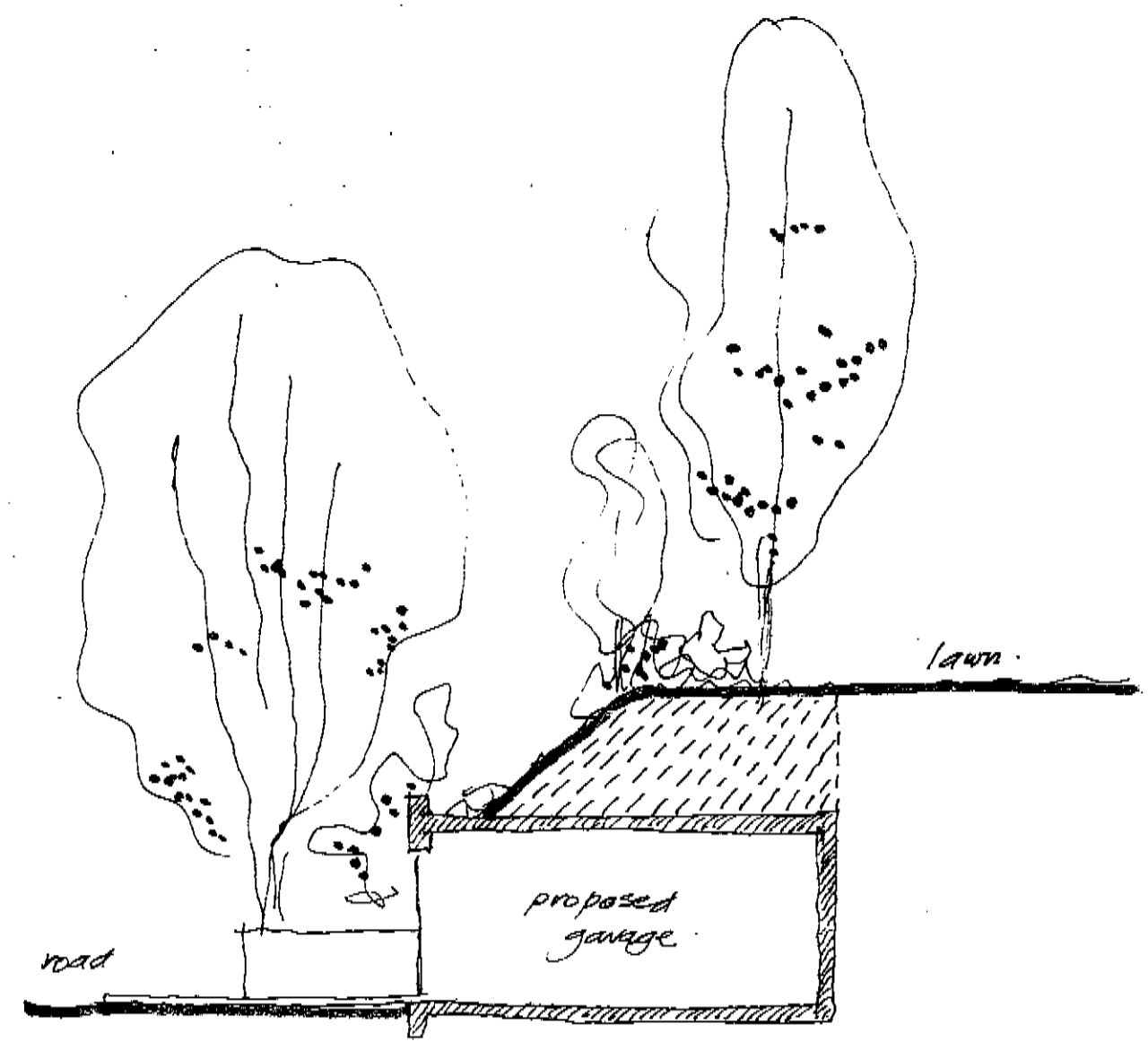

- SECTION -

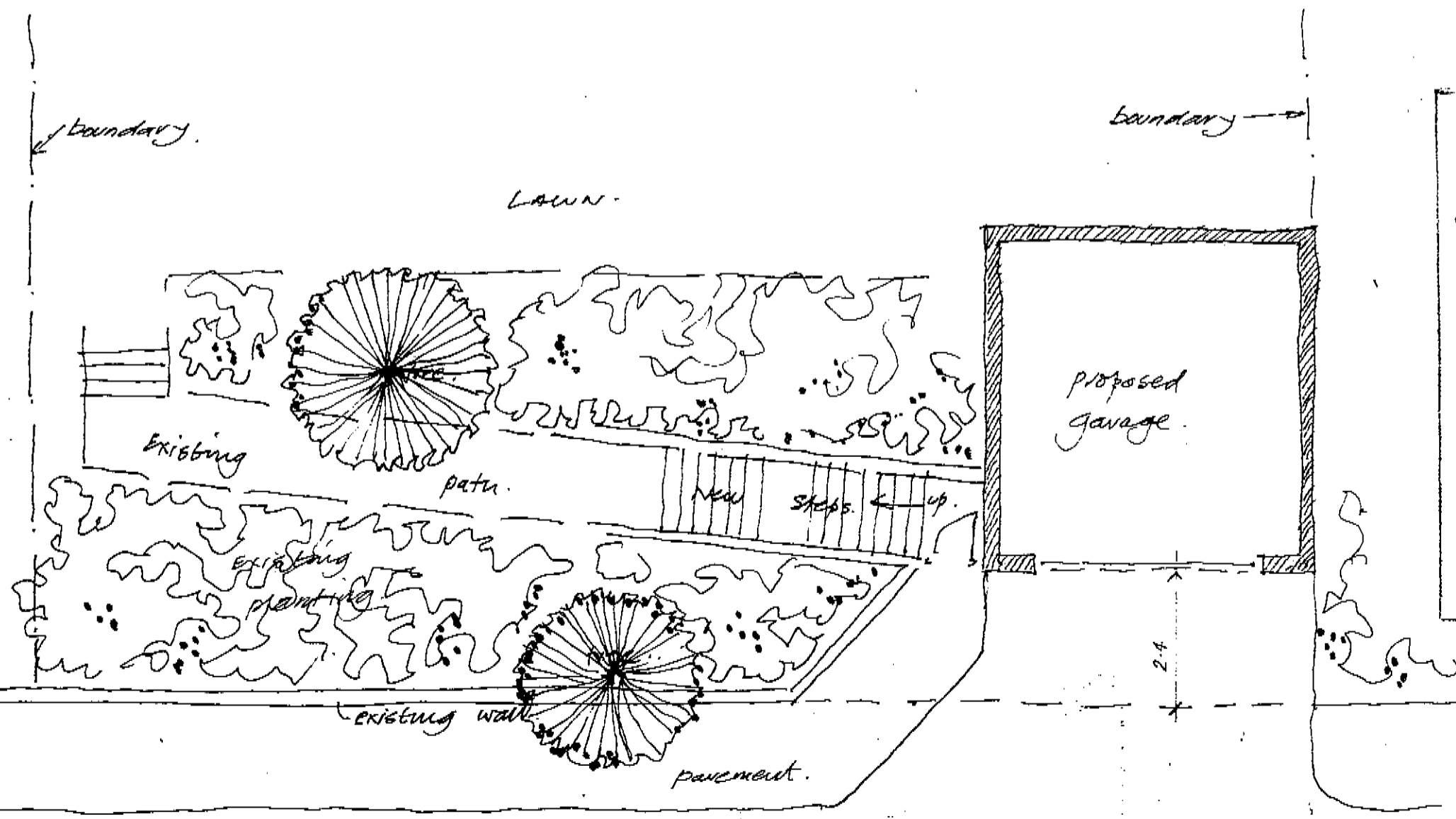

- PLAN -

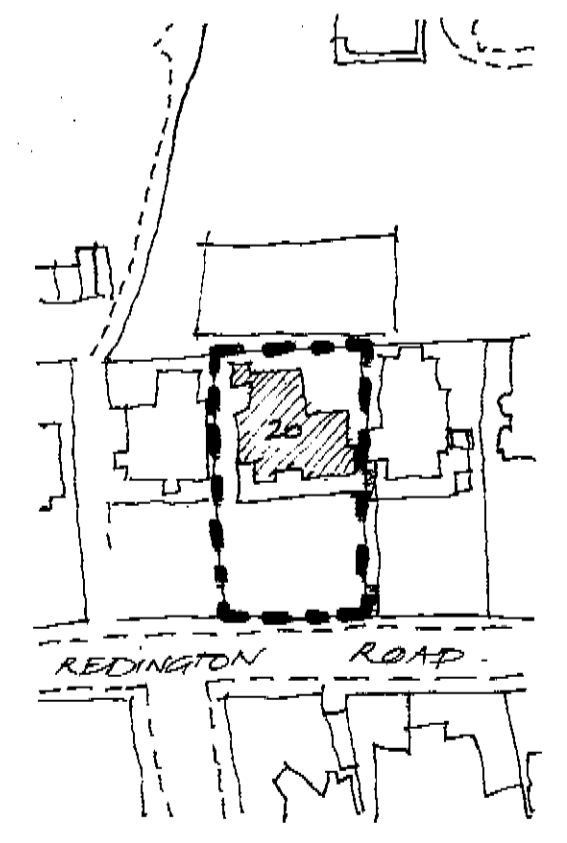

- LOCATION PLAN - scale 1/1250

RECEIVED  
30 SEP 1988  
DEPARTMENT  
PLANNING AND TRANSPORT  
LONDON BOROUGH OF CAMDEN

ALDEN ASSOCIATES ARCHITECTS & PLANNERS 8 CHESTERFORD GARDENS LONDON NW3 7DE TELEPHONE (01) 435 1692		
SCALE 1: 100	DATE SEPT 88	DRWG. NO. 762/1