

Templar House  
Completed 1989  
Bernard Sunley  
Investment Trust Limited  
  
Architects  
Richardson and McLaughlin  
Contractors  
Roth and Towline Ltd.

**LONDON  
ELECTRICITY**

London Electricity P.L.C.  
20 Kingly Court  
London W1R 5LE  
Tel. 01-434 0887/0517  
Fax 01-434 0269

- EXISTING STONE CLAD BULKHEAD OVER DOOR
- EXISTING STONE CLAD WALL AND PLASTER
- INTERNALLY/FLUORESCENT LIGHT SIGNAGE BOX WITH ELECTRO PLATED COPPER FACING
- ELECTRICAL FEEDS FROM EXISTING CONDUIT
- LETTERING ETCHED INTO METAL FACING
- COMPOSITE GLASS LOGO TO BE REFINED WITH FACING
- FLUORESCENT LIGHTING TO ILLUMINATE LOGO AND PERIMETER
- PERIMETER OF SIGN WHEN ILLUMINATED TO HAVE BLUE HALO EFFECT
- BLUE PERSPEX REF 743
- GREEN PERSPEX REF 692

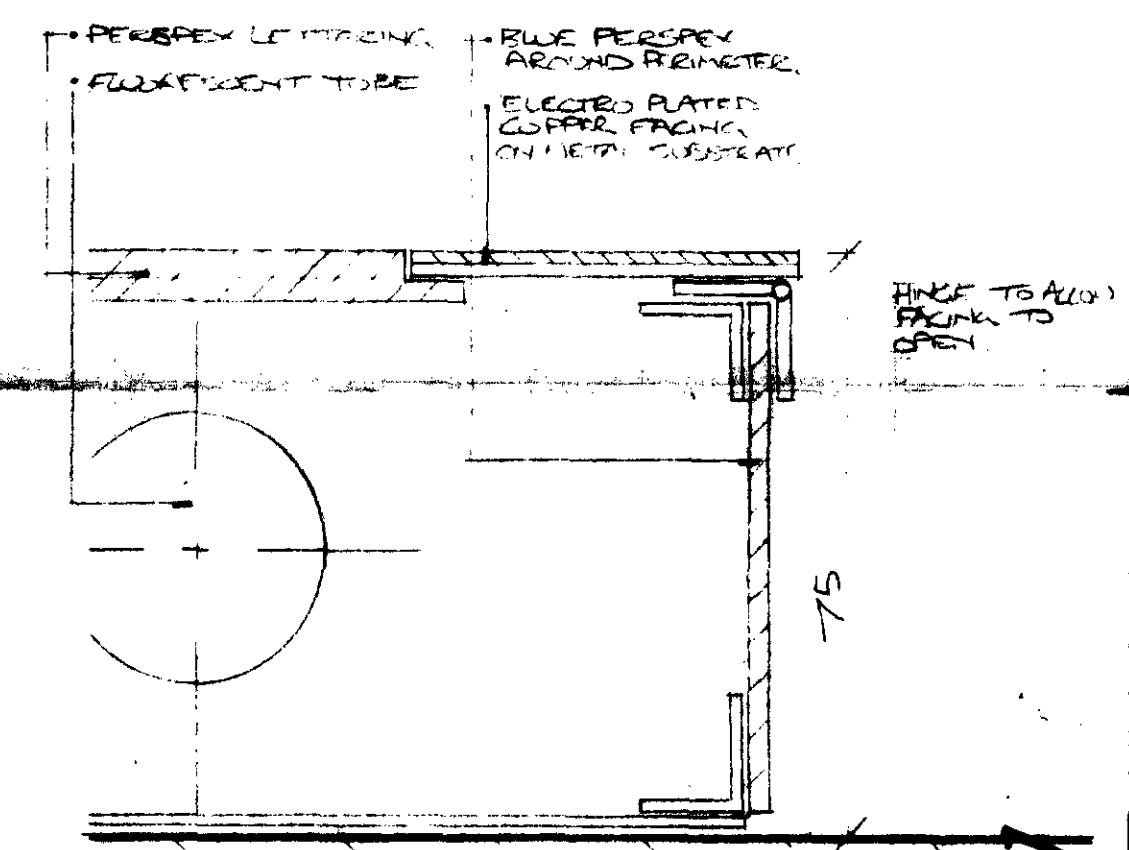

D1 - FULL SIZE

CASE COPY  
RECORDED  
21 JAN 1992  
FLA'S  
ON BEHALF OF THE COUNCIL



No.	Date	Initial	Revision

the design solution

20 Kingly Court  
London W1R 5LE  
Tel. 01-434 0887/0517  
Fax 01-434 0269

This drawing should not be scaled.  
The contractor is to verify all dimensions and conditions on site.  
N.B. - this drawing is the property of The Design Solution and they reserve the copyright. It is issued on the understanding that it will not be copied, reproduced or disclosed in whole or in part to any unauthorised party without written permission from The Design Solution.

Job No. 07/1015	Date JULY 91
Scale 1:10 F.S.	Drawn by
Job: LONDON ELECTRICITY P.L.C. ENTRANCE / RECEPTION.	
Drawing: SIGNAGE DETAILS.	
Drawing No. 07/1015   AA   (9)   01	

REV	DATE	DESCRIPTION
A	3.7.91	REVOLVING DOOR, 2M DIA, AUTO SLIDING DOOR, 1.5M DIA

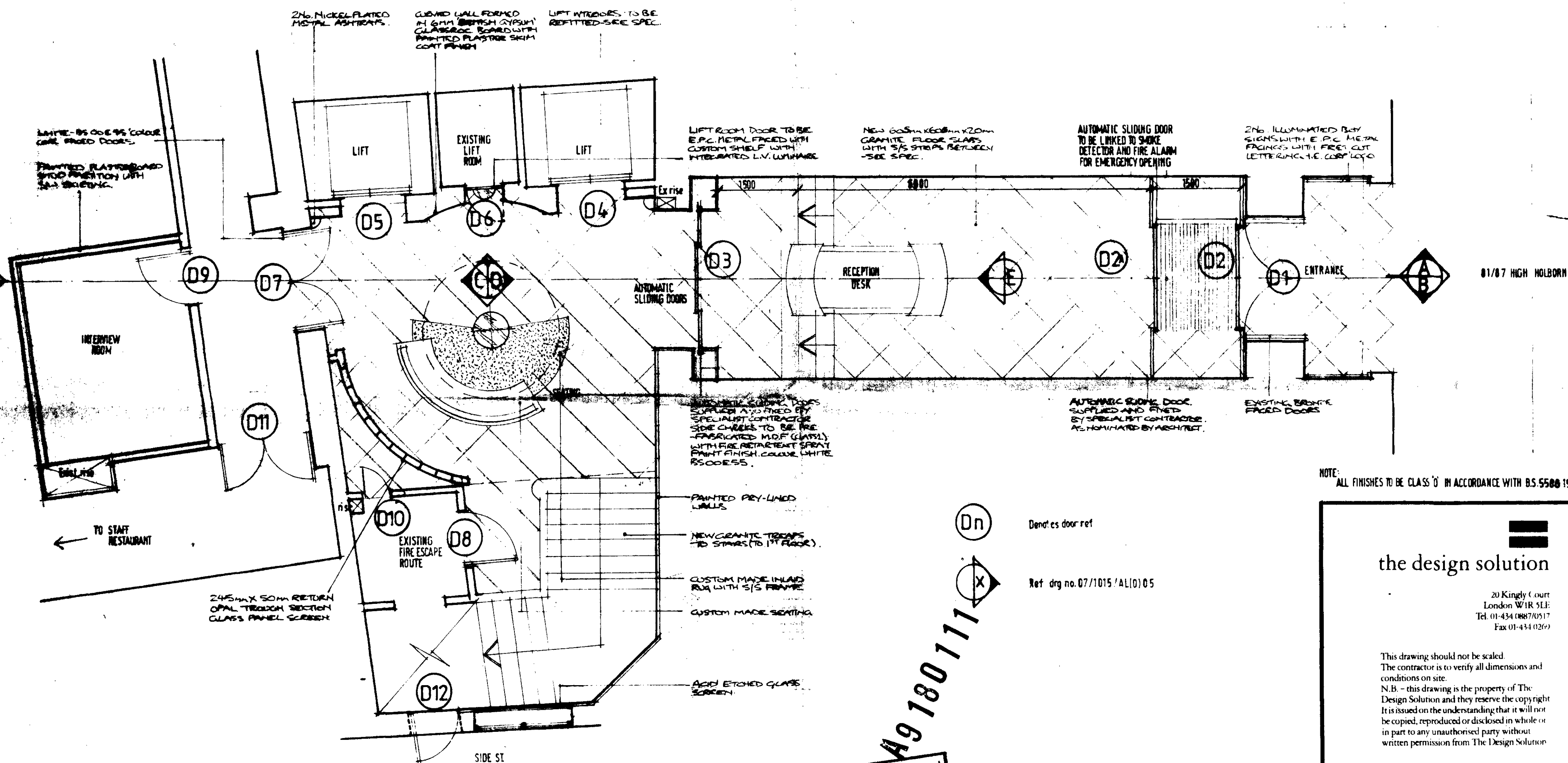

NOTE: ALL FINISHES TO BE CLASS 'O' IN ACCORDANCE WITH B.S. 5588 1983 PART 3

Dn

Denotes door ref

X

Ref. drg no. 07/1015/AL(0)05

the design solution

20 Kingly Court  
London W1R 5LE  
Tel: 01-434 0887/0517  
Fax 01-434 0269

This drawing should not be scaled.  
The contractor is to verify all dimensions and conditions on site.  
N.B. - this drawing is the property of The Design Solution and they reserve the copyright. It is issued on the understanding that it will not be copied, reproduced or disclosed in whole or in part to any unauthorised party without written permission from The Design Solution.

Job No.	07/1015	Date	APRIL 91
Scale	1:50	Drawn by	
Job	LONDON ELECTRICITY ENTRANCE/RECEPTION		
Drawing	PROPOSED G.A.		
Drawing No.	07/1015   AL   (0)   02. A		

CA 9 180 111  
21 JAN 1992  
LONDON ELECTRICITY  
PLANNING  
ON BEHALF OF COUNCIL