

NOTES

- ALL WORKS TO BE CARRIED OUT IN ACCORDANCE WITH CURRENT BUILDING REGULATIONS.
- ALL DIMENSIONS, LEVELS, HEIGHTS TO BE CHECKED AND VERIFIED ON SITE BEFORE COMMENCING ANY WORK AND ANY DISCREPANCIES TO BE REPORTED TO THE OFFICE IMMEDIATELY.
- THIS DRAWING TO BE READ IN CONJUNCTION WITH CONTRACT DOCUMENTS, PROJECT WORKING DRAWINGS, SPECIFICATION, ALL CONSULTANTS / SPECIALIST DRAWINGS, DETAILS AND SPECIFICATION.
- ALL MATERIALS TO BE USED IN THE CONSTRUCTION OF THE EXTERNAL SURFACES OF THE NEW WORKS SHALL MATCH THOSE IN THE EXISTING BUILDING.

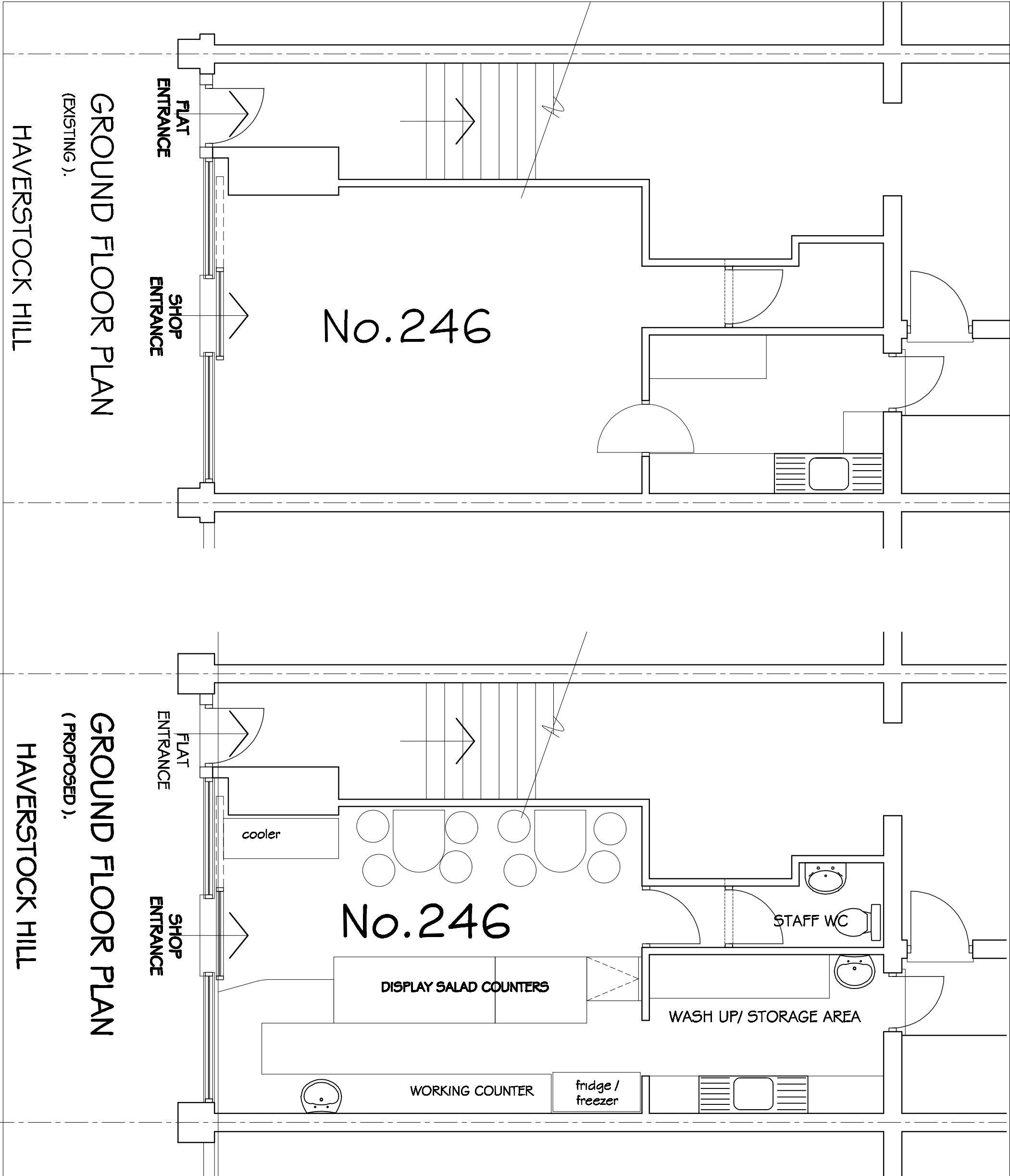
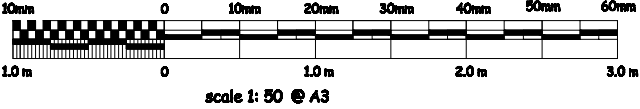

GROUND FLOOR PLAN

(EXISTING).

HAVERSTOCK HILL

GROUND FLOOR PLAN

(PROPOSED).

HAVERSTOCK HILL

JOB TITLE: PROPOSED CHANGE OF USE FROM LAUNDETTE TO SANDWICH BAR (A1) AT 246 HAVERSTOCK HILL, LONDON NW3 2AE	
CLIENT: MR RAZA	DRAWING TITLE: EXISTING & PROPOSED PLANS
REV: DATE	AMENDMENT
SCALE: 1:50	DRAWN:
DATE: NOV. 2009	JOB NO: RD/24GHAV
DRAWING NO: RD/24GHAV/CHPO1	REV.
COPYRIGHT RESERVED	