

DESIGN STATEMENT

- CLIENT :** Mr John James
Soho Estates Limited , 2 Archer Street, Piccadilly, London. W1D 7AW
- SITE :** 66a Heath Street, Hampstead London.
- PROJECT :** Alteration to existing basement kitchen air extract and fresh air supply ductwork system
- REQUIREMENT :** Ground and basement area of 66a Heath Street which operates as a restaurant has a kitchen facility located within its basement. The main cooking area in the basement is served by mechanical ventilation which provides cooker hood air extraction and general fresh air make. The mechanical ventilation comprises of two fan box units located in 1st floor rear internal room connected to metal ductwork that passes through the floor of the room into the restaurant below. The external air inlet serving the fresh air fan box is via an air louvre fitted into rear wall of building at this point. The extract fan box unit has metal ductwork that passes through external wall and runs up external rear wall before terminating at roof level. Operation of the system is via local control within the restaurant. It is the clients intention to remove the existing fan box units from within the 1st floor rear room and re-site replacement units on the main roof of the building. The ductwork within the 1st floor room is to be replaced and routes re-configured, the main extract ductwork riser running up external wall is to be re-used, a new fresh air duct from the 1st floor room and running up external wall alongside existing extract duct is to be installed and new ductwork and fan units to be installed onto the main roof area.
- All ductwork which is to be re-installed within the 1st floor is to be fully fire proofed being clad with proprietary material, new fan units that are to be located on roof to have noise suppression sections fitted. The air flow design has been based on existing fan units specifications.

FAN UNIT SPECIFICATION – BOTH UNITS

- Make :** Air Flow Developments
- Model :** A.D. 102H2WLL/4
- Air Flow :** 102 m³/s @ 300pa
- Noise Level :** 46dBa @ 3m

RECEIVED
21 JAN 2009

Fan units to be fully weather proofed and lined with barafoam sound insulation.

Fan units to be fitted with variable speed controller for air flow adjustment and to maximise sound suppression.

External unit size 1.000 x 1.000 x 800 high



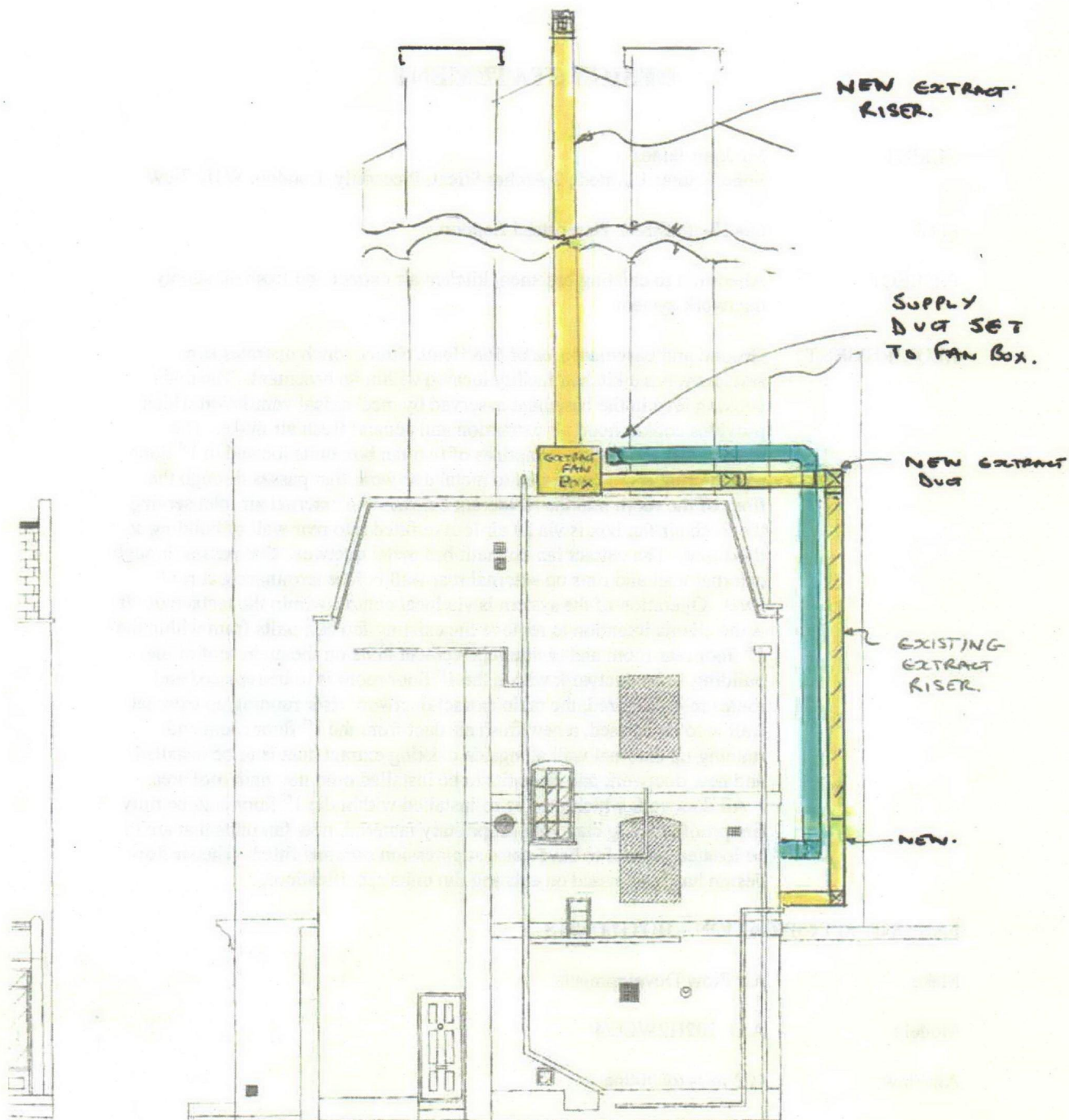

Side (Gable) Elevation

66 Heath Street
Scale: 1/100

