

Murray Mews

third floor as proposed :

1 x 2 bed flat = 94m2 gross internal

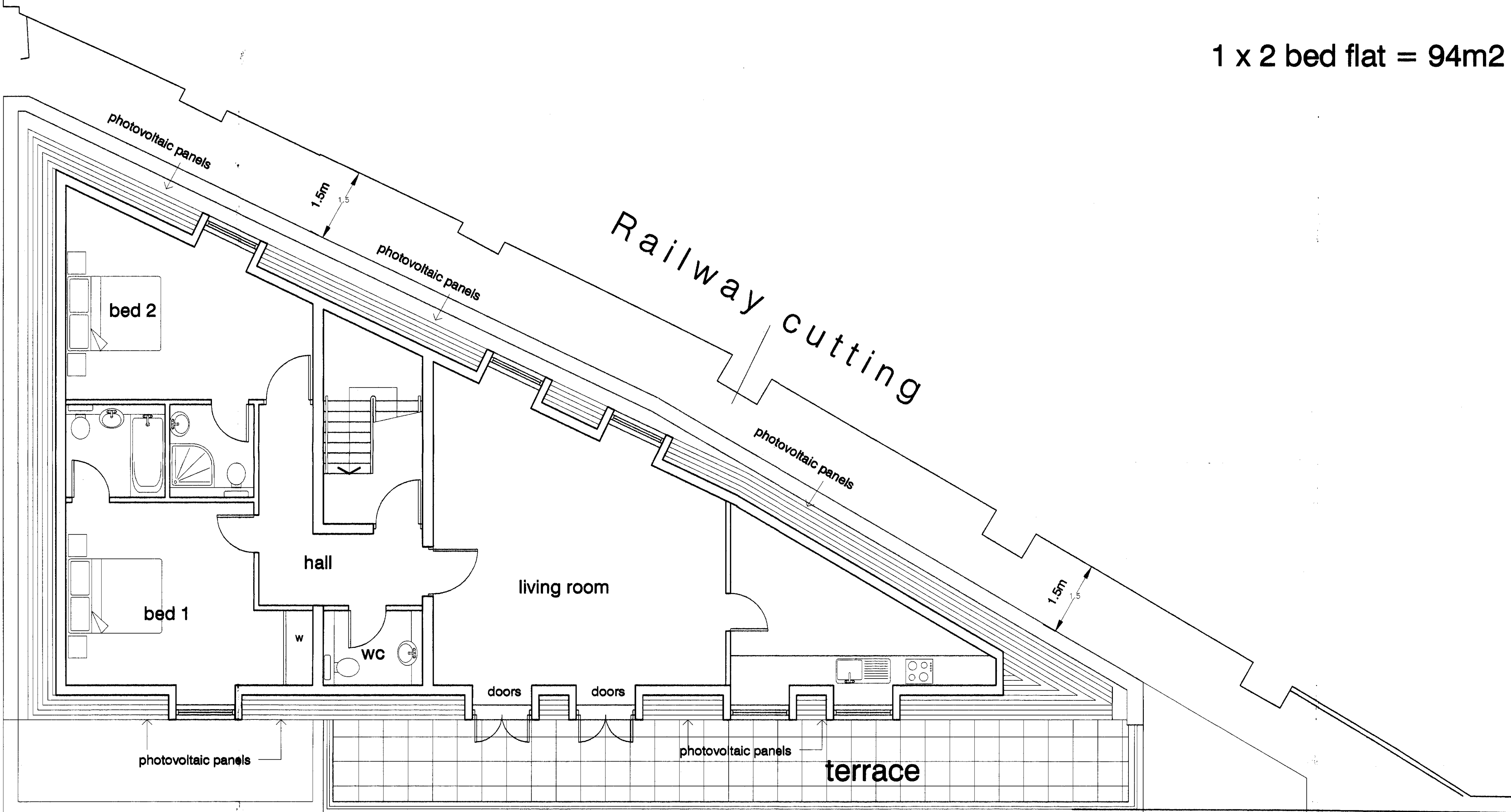

2 bed flat 94m2

Murray St.

scales 1:50 @ A1
1:100 @ A3

DVM
ARCHITECTS

4a Murray Street . London . NW1 9RE
Telephone 0207 485 2121 . Facsimile 0207 267 2527
e-mail: studio@dvmarch.com

Client
Damsonetti

Project
17a Murray Street
London NW1

Title
Third Floor
as proposed

Scale 1: 50	Date 19.11.08	Job No. 1709
Drawing No. 1709/07 Damsonetti	Rev.	

All dimensions are to be checked on site.
This drawing is copyright and remains the property of David & Victoria Mercer at all times and may not be reproduced in part or whole without written consent.