

# r.howorth & co. ltd.

## chartered surveyors



registered london office

80 Shaftesbury rd. London N19 4QN

Tel: 07794 400 212

Email: [info@rhoworth.co.uk](mailto:info@rhoworth.co.uk)

15<sup>th</sup> September 2008

Mr G. Barrett  
Barrettfirrell Chartered Surveyors  
7 Belsize terrace,  
London,  
NW3 4AX

Dear Mr Barrett

**Re: Proposed development and trees to Rear garden - 18 Daleham Gardens,  
London, NW3**

Further to your instructions of 27<sup>th</sup> August and my inspection of 9<sup>th</sup> September 2008,  
I wish to report as follows:

This report gives an overview of the effects of the proposed development on the  
existing trees and shrubs at the above address.

The attached drawings and tree schedule details the trees and shrubs within the rear  
garden of No. 18 and the adjacent neighbouring gardens also showing the footprint  
of the proposed development.

In summary, there is only one tree within the rear garden on No. 18 that will be  
affected by the works and is significant in terms of its future structural value in the  
landscape. This tree is identified as T7, Monkey puzzle tree (*araucaria araucana*).  
This tree is approximately 6-10 years old and could be transplanted if it is likely to be  
disturbed by the works.

There is a mature Birch (*betula pendula*) tree, T22, in the gardens of the property to  
the right. This tree is approximately 3 ½ metres from No. 18. There is uninterrupted  
sufficient rooting zone for this tree in the gardens of No. 16; therefore no root zone  
protection is necessary.



**RICS**

commercial  
residential  
building surveys  
building regulations

project supervision  
tree reports and surveys  
dilapidations  
design and supervision

damp/defects  
fire risk surveys  
specifications  
party walls



**r.howorth & co. ltd.**

chartered surveyors

There is also a line of closely cropped pollarded Lime (*tilia x europea*) trees T1-T5. There is uninterrupted sufficient rooting zone for these trees in the gardens of No. 20; therefore no root zone protection is necessary.

The mixed shrub borders, close to the main house of No. 18, T23-T24 can be lifted, stored and re-planted elsewhere if required.

None of the other trees within the rear gardens are of a significant amenity value or close enough to the works to warrant any special protection.

Please consider the above and if you have any further queries, do contact me.

Yours sincerely,

A handwritten signature in blue ink, consisting of several stylized, overlapping loops and a final downward stroke.

**ROBIN HOWORTH, MRICS, MICFor, M.Arbor.A**  
**Chartered Surveyor**  
**Chartered Forester and Professional Arboriculturist**



Do not scale, use figured dimensions only. All dimensions to be verified on site prior to the commencement of any work or the production of any shop drawing. This drawing to be read in conjunction with all related drawings and any other relevant information.

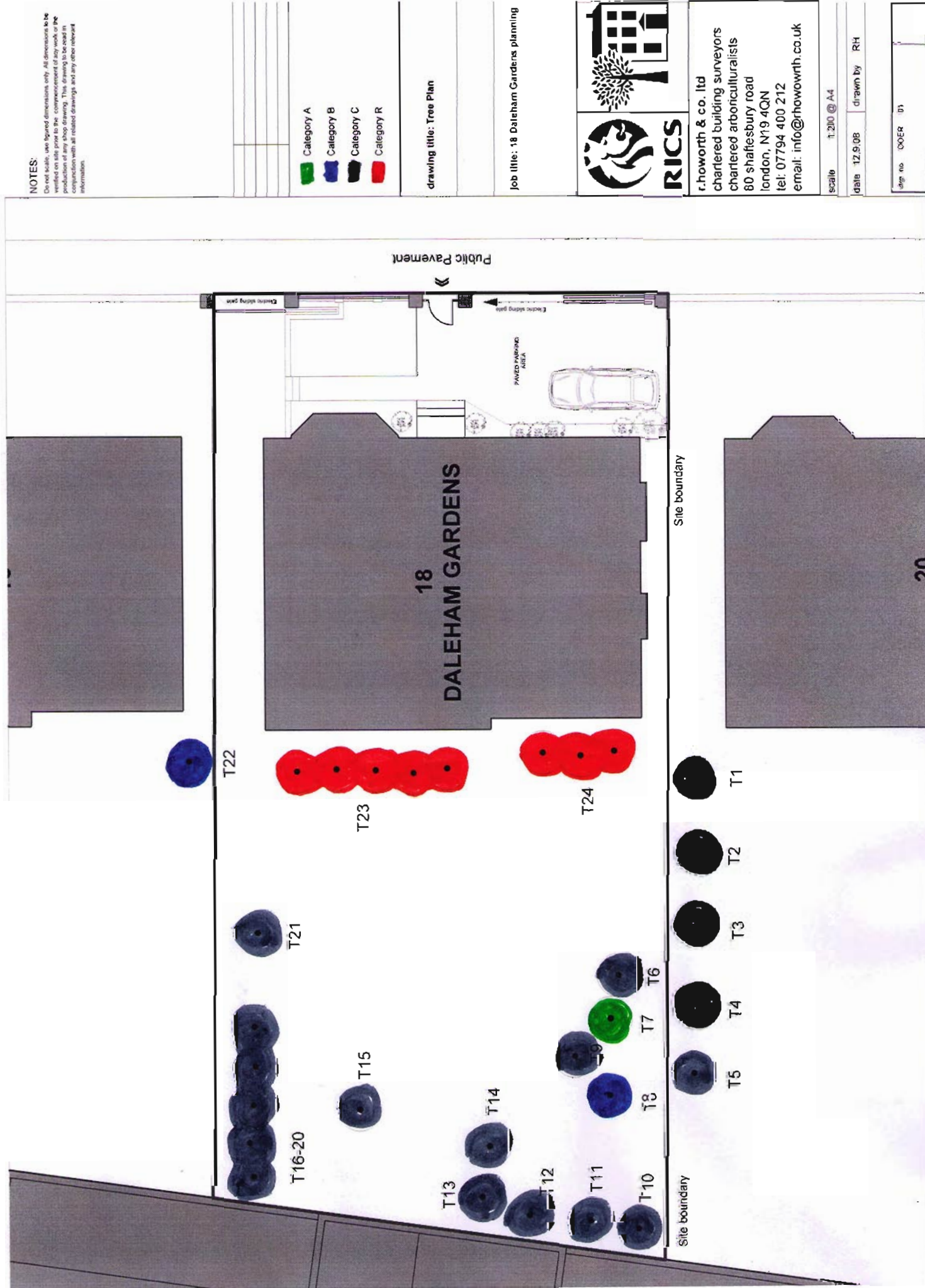

Category A  
Category B  
Category C  
Category R

**drawing title: Tree Plan**

**Job title: 18 Daleham Gardens planning**



# RICS

**J. Howarth & Co. Ltd**  
Chartered building surveyors  
Chartered arboriculturalists  
80 Shaftesbury Road  
London, N19 4QN  
Tel: 07794 400 212  
Email: [info@rhowarth.co.uk](mailto:info@rhowarth.co.uk)

1:200 @ A4

date	12.9.08	drawn by	RH
------	---------	----------	----

Page No. 00000000

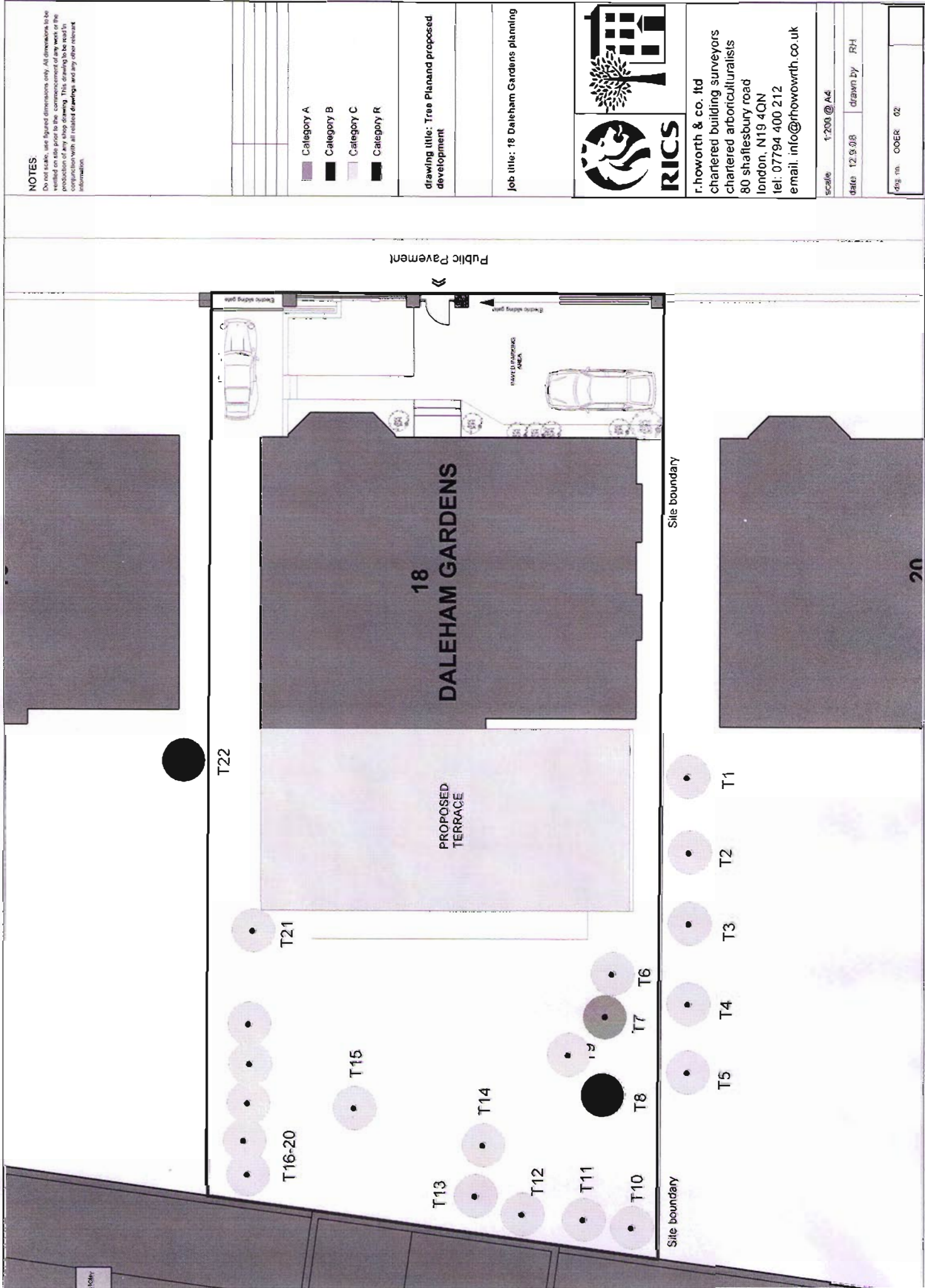

**NOTES**

Do not scale, use figured dimensions only. All dimensions to be given in metres. This drawing is to be used in conjunction with the production of any shop drawing. This drawing to be read in conjunction with all related drawings and any other relevant information.

- Category A
- Category B
- Category C
- Category R

drawing title: Tree Plan and proposed development

Job title: 18 Daleham Gardens planning

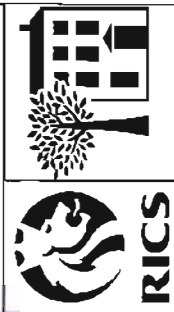

r.howarth & co. ltd  
chartered building surveyors  
chartered arboriculturalists  
80 shafesbury road  
london, N19 4QN  
tel: 07794 400 212  
email: info@rhowarth.co.uk

scale	1:200 @ A4
date	12.9.08
drawn by	RH
drawn by	OOER 02

# TREE SCHEDULE

Tree reference no.	Species	Age class (years)	Height (m)	Stem diameter	Branch spread	Height of crown clearance (m)	Physiological condition	Structural condition	Preliminary management recommendations	Estimated remaining contribution (years)	Category grading
TI –T5	Tilia x europea	40	5	30	N,E,S,W 1m	4.5	fair	poor	Owned by neighbours – no action	10	C
T6	Ilex aquifolium	20	2.5	14	N,E,S,W 1.5m	2	fair	fair	No action	30	C
T7	Araucaria araucana	6	3.5	19	N,E,S,W 2.5m	1	good	good	No action	40+	A
T8	Magnolia species	20			N- 2 E- 2.5 S- 2.5 W- 2.5	0.5	good	good	No action	30+	B
T9	Juniperus species	30		10	N,E,S,W 1m		fair	fair	No action	10	C
T10-T13	Tilia x europea	40	5	30	N,E,S,W 1m	4.5	poor	poor	No action	10	C
T14	Acer saccharum	30	5	18	N,E,S,W 1.5m	1	fair	fair	No action	10	C
T15	Prunus species	15	3	14	N,E,S,W 1.5m	1	fair	fair	No action	20	B
T16-T20	Buddleia, mahonia, sambucus, pyracanthus	10-20	4	10	N,E,S,W 3m approx	0	fair	fair	No action	10	C
T21	Prunus species	20	4	12	N,E,S,W 1.5m	1	fair	fair	No action	10	C
T22	Betula pendula	40	16	32	N- 3.5 E- 2.5 S- 4 W- 3.5	2	fair	fair	Owned by neighbours – no action	20	B
T23-T24	Various decorative shrubs	5	Max 2	5	N,E,S,W 0.5m	0	fair	fair	Remove as part of development, consider re-	0	R

	including fuschia, pyracantha and pittosporum, garrya and dwarf acers								planting where retention is desirable		
--	---	--	--	--	--	--	--	--	---	--	--

Site: 18 Daleham Gardens

Date of Survey: 9.9.08

Weather: Rain

Surveyor: R. Howorth