

Land Registry

Official copy of title plan

Title number **NGL667875**
Ordnance Survey map reference **TQ2685SE**
Scale **1:1250**
Administrative area **Camden**

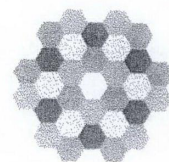

© Crown Copyright. Produced by Land Registry. Reproduction in whole or in part is prohibited without the prior written permission of Ordnance Survey. Licence Number 100026316.

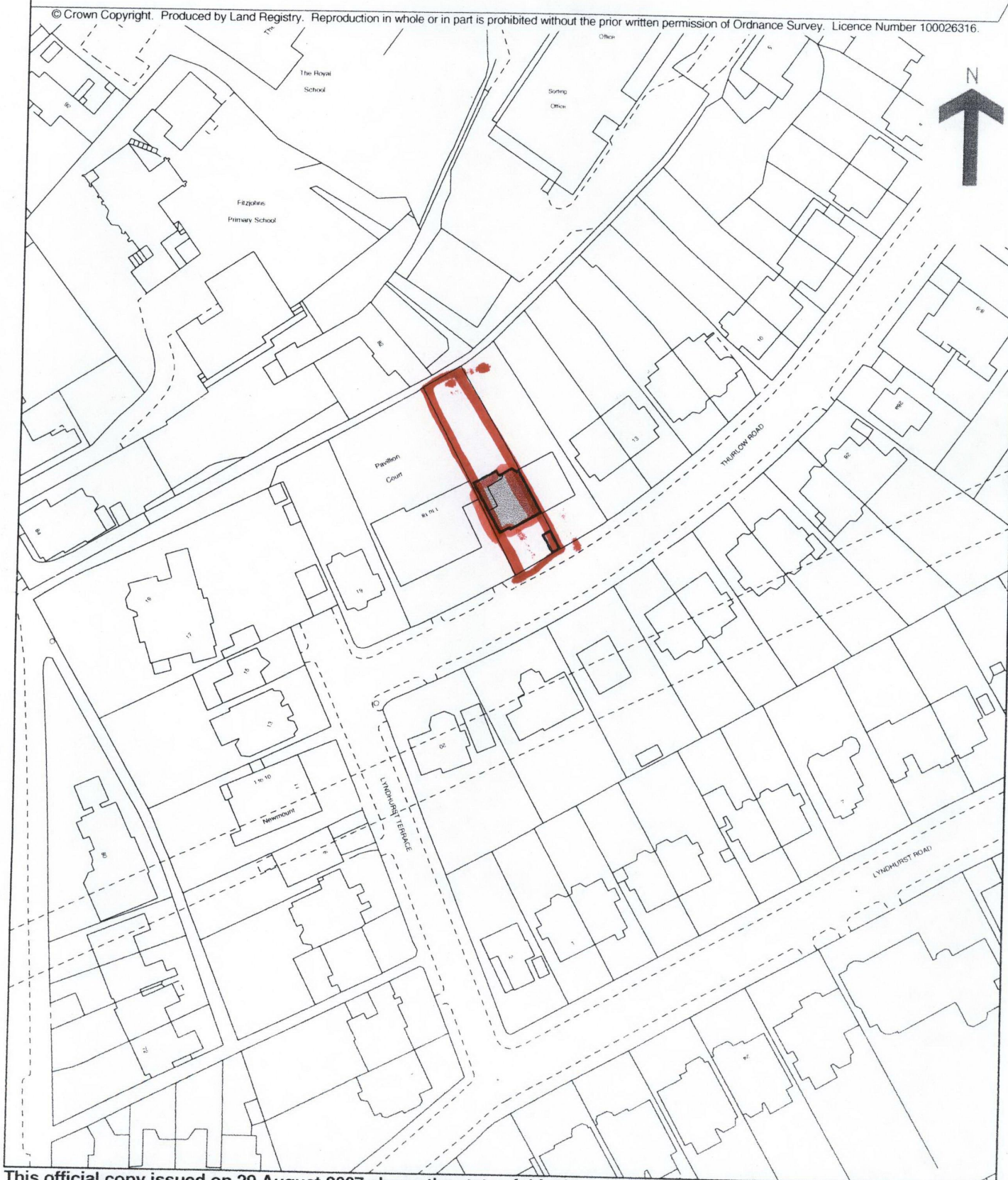

This official copy issued on 29 August 2007 shows the state of this title plan on 29 August 2007 at 14:07:33. It is admissible in evidence to the same extent as the original (s.67 Land Registration Act 2002).
This title plan shows the general position, not the exact line, of the boundaries. It may be subject to distortions in scale. Measurements scaled from this plan may not match measurements between the same points on the ground. See Land Registry Public Guide 7 - Title Plans.
This title is dealt with by Land Registry, Harrow Office.

