

Rev	Date	Description
A	02/03/2009	Note and plant enclosure added.

Legend

- Existing Retained
- - - - - Reused
———— New

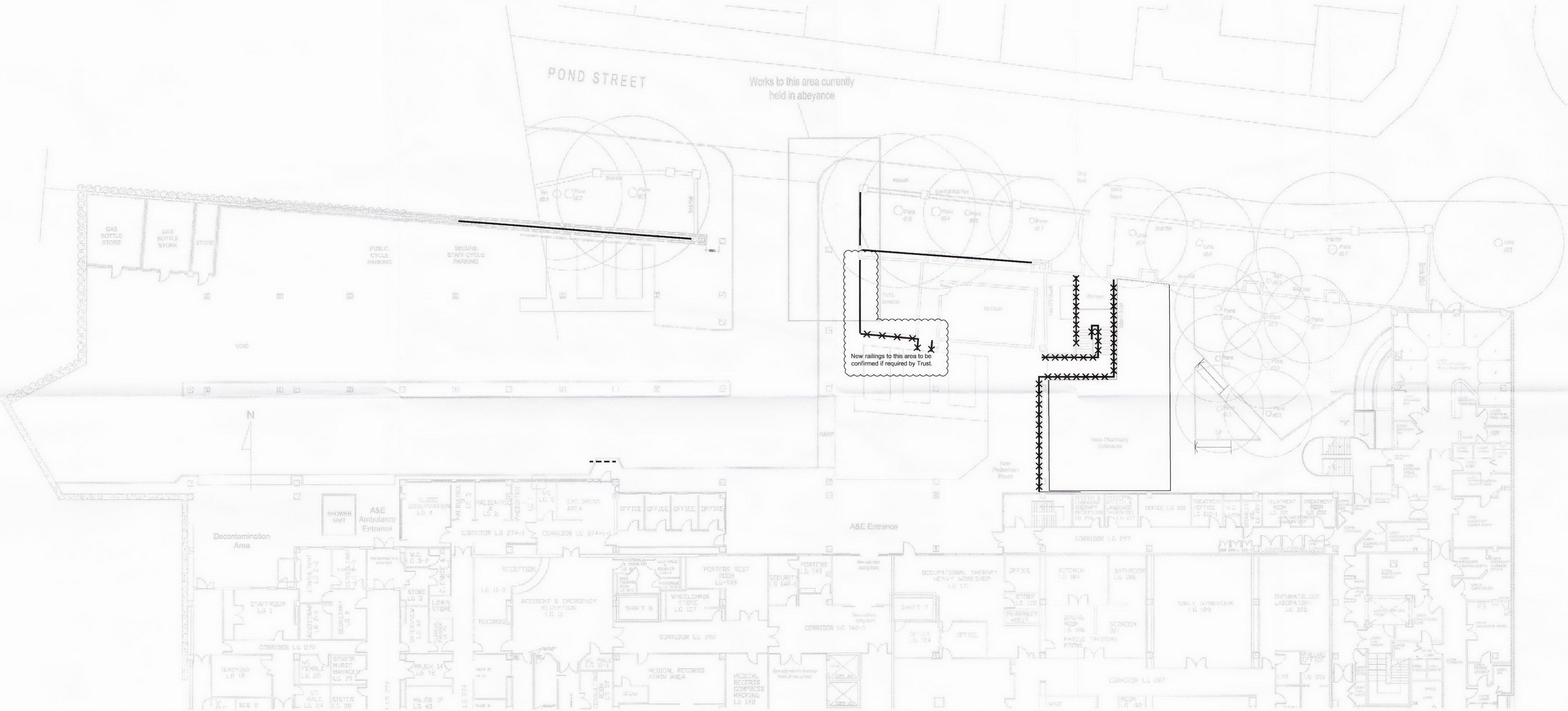

Proposed Lower Ground Floor

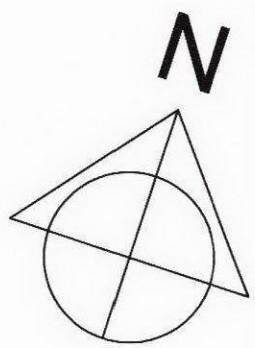

Royal Free Hospital Entrance Remodelling	Proposed Lower Ground Railings
---	--------------------------------

A&B
ANSELL & BAILEY

1:200@A1 SCALE:	03 2008 DATE:	07018 JOB NUMBER:	(01)044 DRAWING NUMBER:	A REV:
Tel 020 7387 0141 CHARTERED ARCHITECTS		Fax 020 7387 7460		architects@ansellandbailey.com 24-32 STEPHENSON WAY LONDON NW1 2HD