

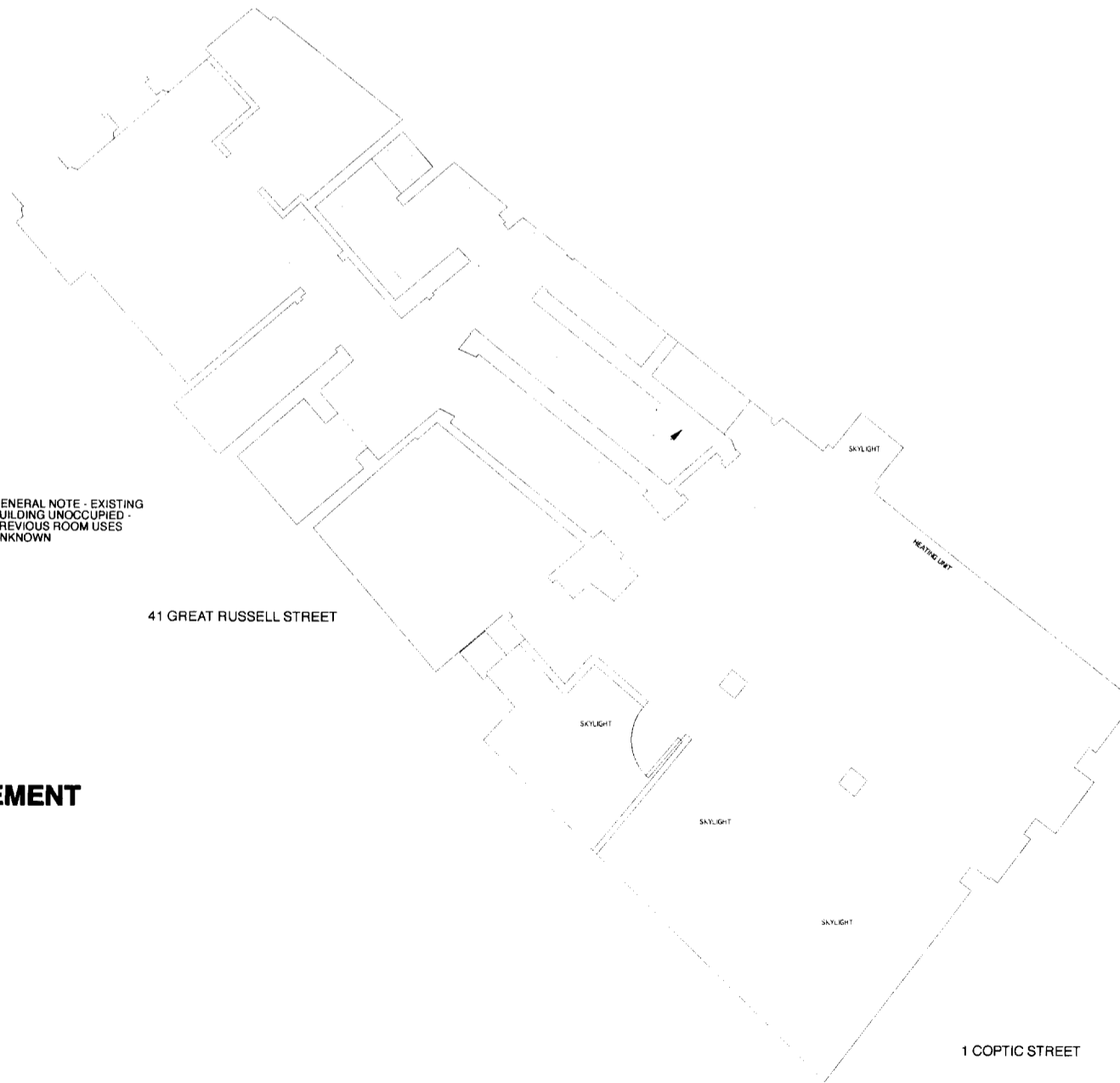

PROPOSED BASEMENT



GENERAL NOTE - EXISTING BUILDING UNOCCUPIED - PREVIOUS ROOM USES UNKNOWN

EXISTING BASEMENT



N

Revisions		Project Title		GUY STANSFELD ARCHITECTS LIMITED	
		42 GREAT RUSSELL STREET / 1A COPTIC STREET		Drawn By	Date
		EXISTING AND PROPOSED BASEMENT PLAN		TS	06.04.09
				Checked By	Scale
					1:100@A3
				Drawing Number	
				GSA500/PL102	
PLEASE NOTE		Do not scale, use figured dimensions only. All dimensions to be verified on site prior to the commencement of any work or the production of any shop drawing. This drawing to be read in conjunction with all related Architect's and Engineer's drawings and any other relevant information.		318 KENSAL ROAD LONDON W10 5BZ www.stansfeld.com T. +44 20 8962 8666 F. +44 20 8962 8777 guy@stansfeld.com	