



VIEW A



VIEW B



VIEW C



VIEW D



VIEW E



VIEW F



VIEW G



VIEW H



VIEW J



VIEW K

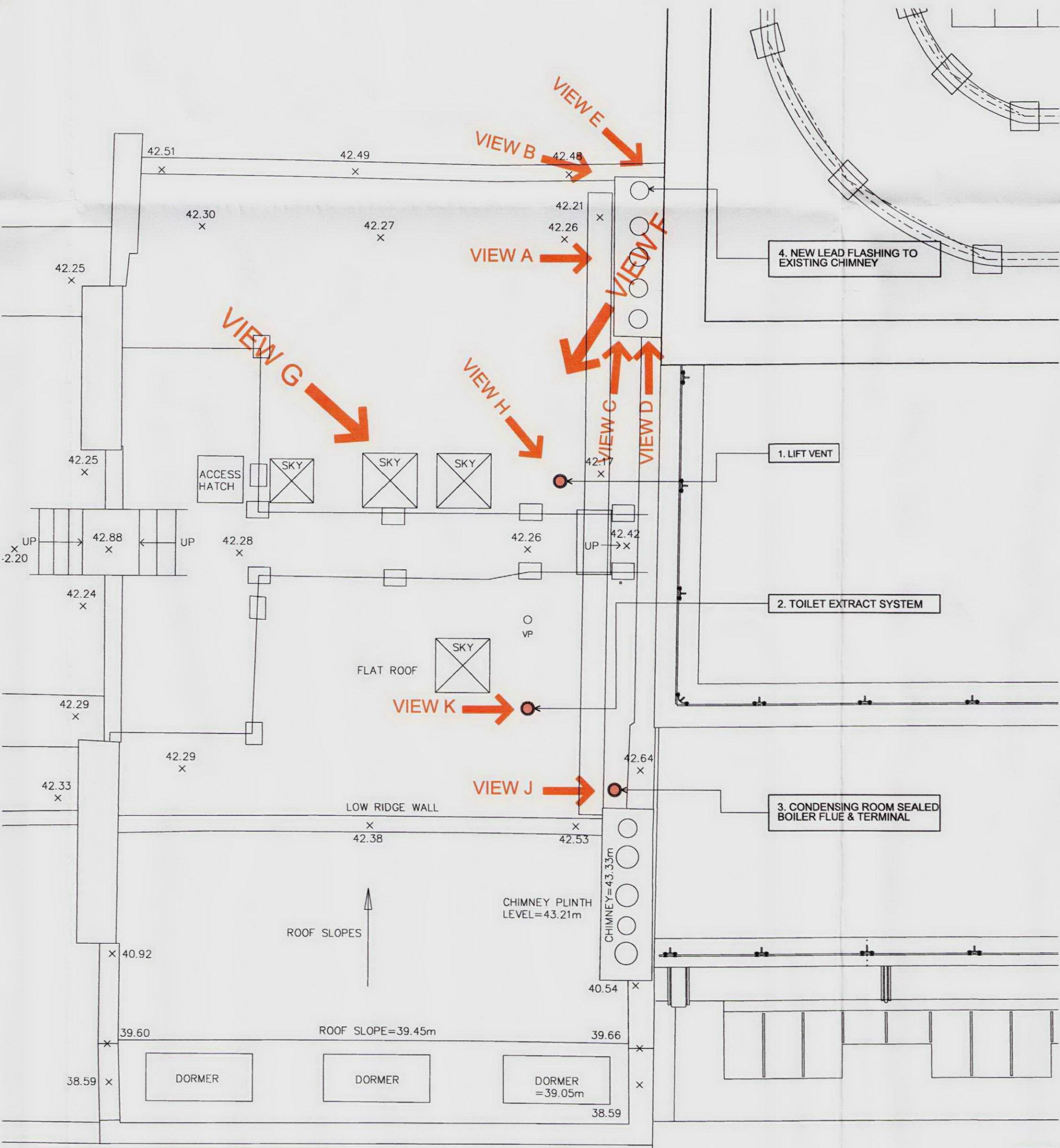

© COPYRIGHT  
The copyright in this drawing is vested in Sheppard Robson and no licence or assignment of any kind has been, or is, granted to any third party whether by provision of copies or originals of the drawings or otherwise unless otherwise agreed in writing.  
DO NOT SCALE FROM THIS DRAWING  
The contractor shall check and verify all dimensions on site and report any discrepancies in writing to Sheppard Robson before proceeding with work.  
FOR ELECTRONIC DATA ISSUE  
Electronic data / drawings are issued as "read only" and should not be interrogated for measurement. All dimensions and levels should be read, only from those values stated in text, on the drawing.  
AREA MEASUREMENT  
The areas are approximate and can only be verified by a detailed dimensional survey of the completed building. Any decisions to be made on the basis of these predictions, whether as to project viability, pre-letting, lease agreements or the like, should include due allowance for the increases and decreases inherent in the design development and building processes. Figures relate to the likely areas of the building at the current state of the design and using the Gross External Area (GEA) / Gross Internal Area (GIA) / Net Internal Area (NIA) method of measurement from the Code of Measuring Practice, 5th Edition (RICS Code of Practice). All areas are subject to Town Planning and Conservation Area Consent, and detailed Rights to Light analysis.

NOTES:

REV	DATE	AMENDMENT

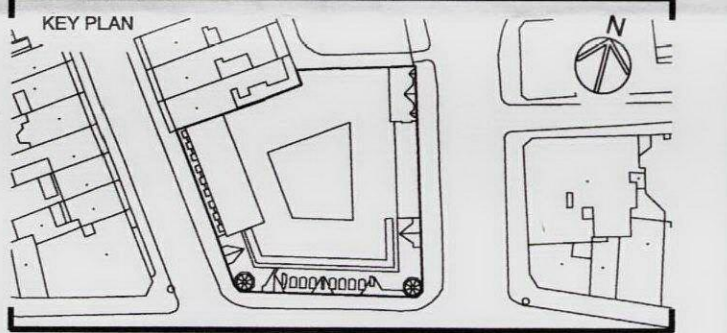

TITLE  
8 Southampton Place  
London  
LOGO

**SHEPPARD ROBSON**  
ARCHITECTURE URBAN DESIGN PLANNING INTERIORS  
LOCATION: 77 PARKWAY · CAMDEN TOWN · LONDON · NW1 7PU  
PHONE: +44 0 20 7504 1700 FAX: +44 0 20 7504 1701  
WEBSITE: www.sheppardrobson.com E-MAIL: sr.mail@sheppardrobson.com

DRAWING  
8 SOUTHAMPTON PLACE  
PHOTOGRAPHS OF AS BUILT WORKS

SCALE @ A1	DATE	ORIGINATOR	CHECKED	AUTHORISED
1: NTS	01.05.2009	CP	BK	BK

STATUS  
INFORMATION

DRAWING NO.  
2047 - SK- 740  
REV