

**Camden**

RECEIVED

08 MAY 2009

Camden Town Hall
Angie Street
LONDON
WC1H 8ND

(6/5)

**TREE WORK
APPLICATION FORM**Town & Country Planning Act 1990
(as amended)**Development Control Team**Please read accompanying guidance notes
before answering any questions. Please
complete all sections in BLOCK CAPITALS.

COMPLETE: (IF KNOWN)

TPO REF: _____

Applicant (in block capitals)

Name _____

Address _____

Post Code _____

Tel. No. _____

Mob. _____

Email: _____

Agent (if any) to whom correspondence will be sent

Name _____

Address _____

LARKHALL LANE, OFF COURLAND GROVE
STOCKWELL Post Code _____

Tel. No. _____

Mob. _____

Email: _____

2. Address of where tree is located.

17 NORTH END,

Is the applicant the owner of the land? (delete as appropriate)

Yes/ No

Post Code NW3 7HR

If not, please specify the applicant's interest in the land (eg occupier, tenant, adjoining neighbour, none):

Is this a council property? (delete as appropriate)

Yes/ No

Is the tree in the (please select): - Front / Rear / SideIf the proposed works are not in the front of the property then please give a daytime telephone number where you
can be contacted so that we can gain access.

Tel No. 077708-78190

Email: 8-458-2125

3. Proposed Works**PLEASE DESCRIBE THE PROPOSED WORKS AS FULLY AS POSSIBLE.** If proposals will not fit in the area below, please
continue on a separate sheet. If the application relates to more than one tree, please ensure that each proposal and
the reasons for it are clearly specified. Example:

Tree	No. on Plan	Description	Reason
Oak	T1, T2 etc	Crown lift to 3 metres above ground & thin by 20%	Low branches are close to greenhouse & the tree's crown casts shade across garden

T01 MONTEREY CYPRESS, REDUCE HEIGHT BY 6m & BALANCE
CROWN - ROUTINE MAINTENANCE OF THE TREE

T02 MONTEREY CYPRESS, FELL TO NEAR GROUND LEVEL - TREE IS DEAD

T03 MONTEREY CYPRESS, REDUCE HEIGHT BY 4m & BALANCE CROWN
ROUTINE MAINTENANCE OF THE TREET04 MONTEREY CYPRESS, REDUCE HEIGHT TO MATCH T03 - ROUTINE
MAINTENANCE OF THE TREE

4. Sketch Plan

In the space below, please provide a sketch or street plan showing the location of the tree(s) in relation to surrounding properties and neighbouring trees.



5. If felling is proposed, is a replacement tree(s) proposed. Yes ☒ No

6. If yes, please specify the height, species and location of replacement tree(s)

7. Additional information

Please list below any documentary evidence to support your proposal ie structural engineer's report, arboricultural report etc and attach it to your application.

8. Sign and Date your application and send it to:

Conservation & Urban Design, Development Control Planning Services,
Environment Department
Camden Town Hall, Argyle Street
LONDON
WC1H 8ND

Signed: 

Date: 06/05/2009

T05, TREE OF HEAVEN - FELL TO 1M STUMP -
OUT GROWN LOCATION

T06 x6, YEW, REDUCE BACK LATERAL BRANCHES GROWING
OVER SECRET GARDEN BY 2M - ROUTINE MAINTENANCE
OF THE TREE

T07, SWEET BAY TREE - REDUCE ALL AROUND 1.5M
ROUTINE MAINTENANCE OF THE TREE

T08, COMMON PEAR, REDUCE DOWN TO 1M ABOVE ORIGINAL
REDUCTION POINTS - ROUTINE MAINTENANCE

T09, COMMON ASH, FELL TO NEAR GROUND LEVEL -
OUT GROWN LOCATION



Secret garden

Access

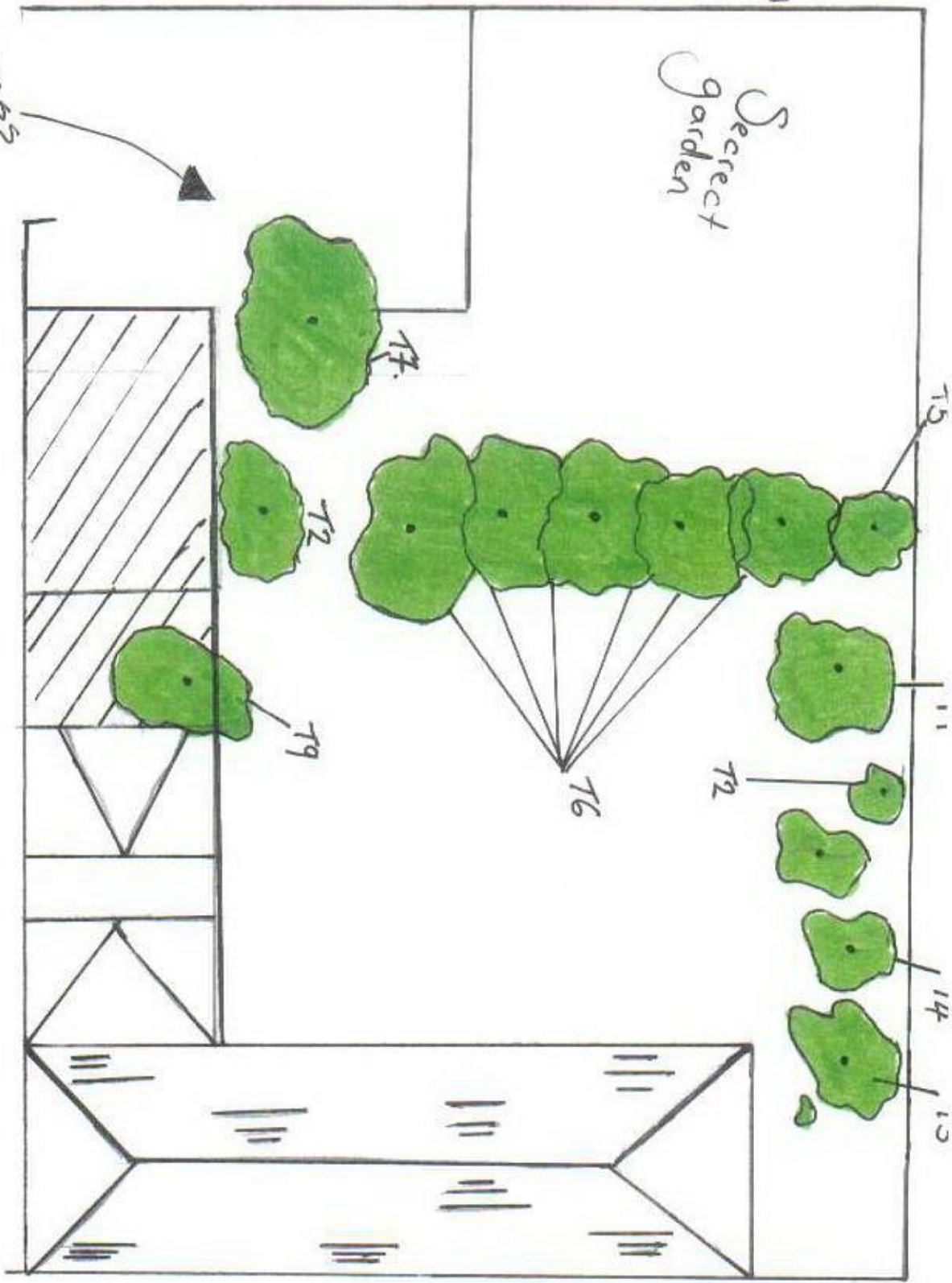

Debi

North End