

Eastman Dental Hospital
 256 Gray's Inn Road
 London WC1X 8LD

1:100 @ A3

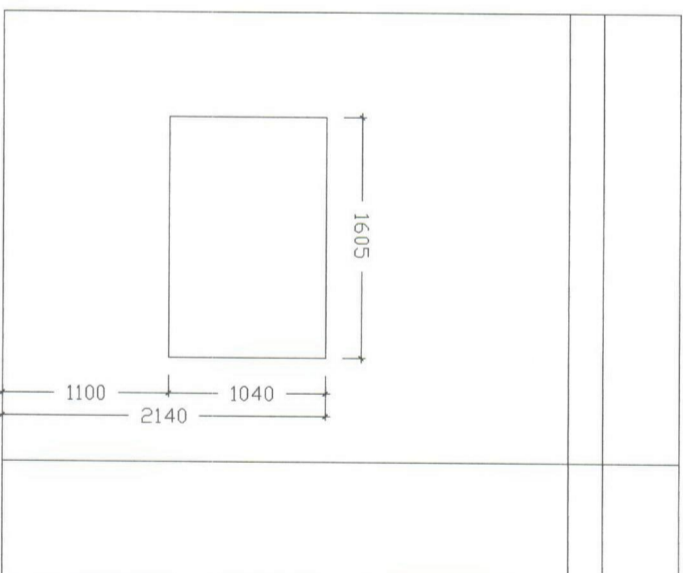

Existing Elevation

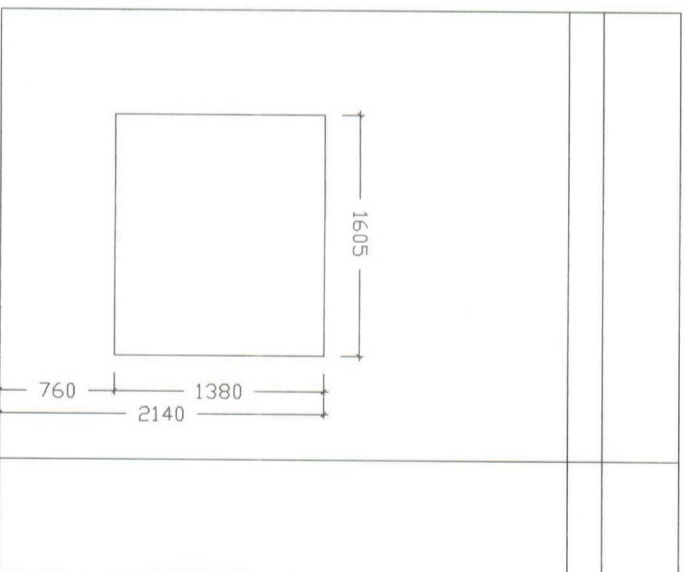

Proposed Elevation

1:50 @ A3

Notes
 Do not scale.
 All dimensions to be checked prior to commencement.



Rev. Date Details

University College
 London Hospitals
 NHS Trust
 Planning Department
 Capital Investment Directorate
 4th Floor Sector B Maple House
 149 Tottenham Court Road
 London W1P 9LL
 Tel: 020 7380 9929
 Fax: 020 7380 9236
 HOSPITALS



Project
 Eastman Dental Hospital
 Reception Desk

Drawing Title
 Plan and Elevation

Date	23.02.2009	Scale	
Drawn	JA	Checked	BH
CAD Ref.		Revision	
Drawing No.	EDH / 2020		