

NOTES

1. Do not scale from drawing, use figured dimensions only after checking. Report any discrepancies or omissions to architect before ordering materials or putting work in hand.
2. Where any drawing is to be read in conjunction with any other drawing, including a specialist's drawing, the two drawings shall be cross-checked and any discrepancies in the work shown, including the dimensions, reported to the architect before the work is put in hand.
3. Where work to an existing building is involved, figured dimensions shown on drawings including those of specialists, shall be verified by measurement of the building and any discrepancy reported to the architect before the work is put in hand.

NOTE: ALL WORK TO WINDOWS & NEW GLAZING DETAILS TO BE AGREED

REV A GENERAL REVISIONS TO NOTES 08/06/09

job

33 CHALCOT SQ
LONDON NW1

drawing

THIRD FLOOR PLAN
AS PROPOSED

scale	drawn	date
1:50@A3	EP/SURV	10/02/09

drawing number	rev
3245/ B/ P14	A

client
MR P. HALL

ANTHONY RICHARDSON AND PARTNERS TEL: 020 7485 0991
ARCHITECTS AND QUANTITY SURVEYORS FAX: 020 7482 4622
31 OVAL ROAD CAMDEN TOWN LONDON NW1 7EA EMAIL: mail@arpartners.co.uk

This drawing is the property of ARP Anthony Richardson & Partners Ltd. Copyright is reserved on them and the drawing is issued on the condition that it is not copied, reproduced, retained or disclosed to any unauthorised person either wholly or in part without the written consent of the Company.

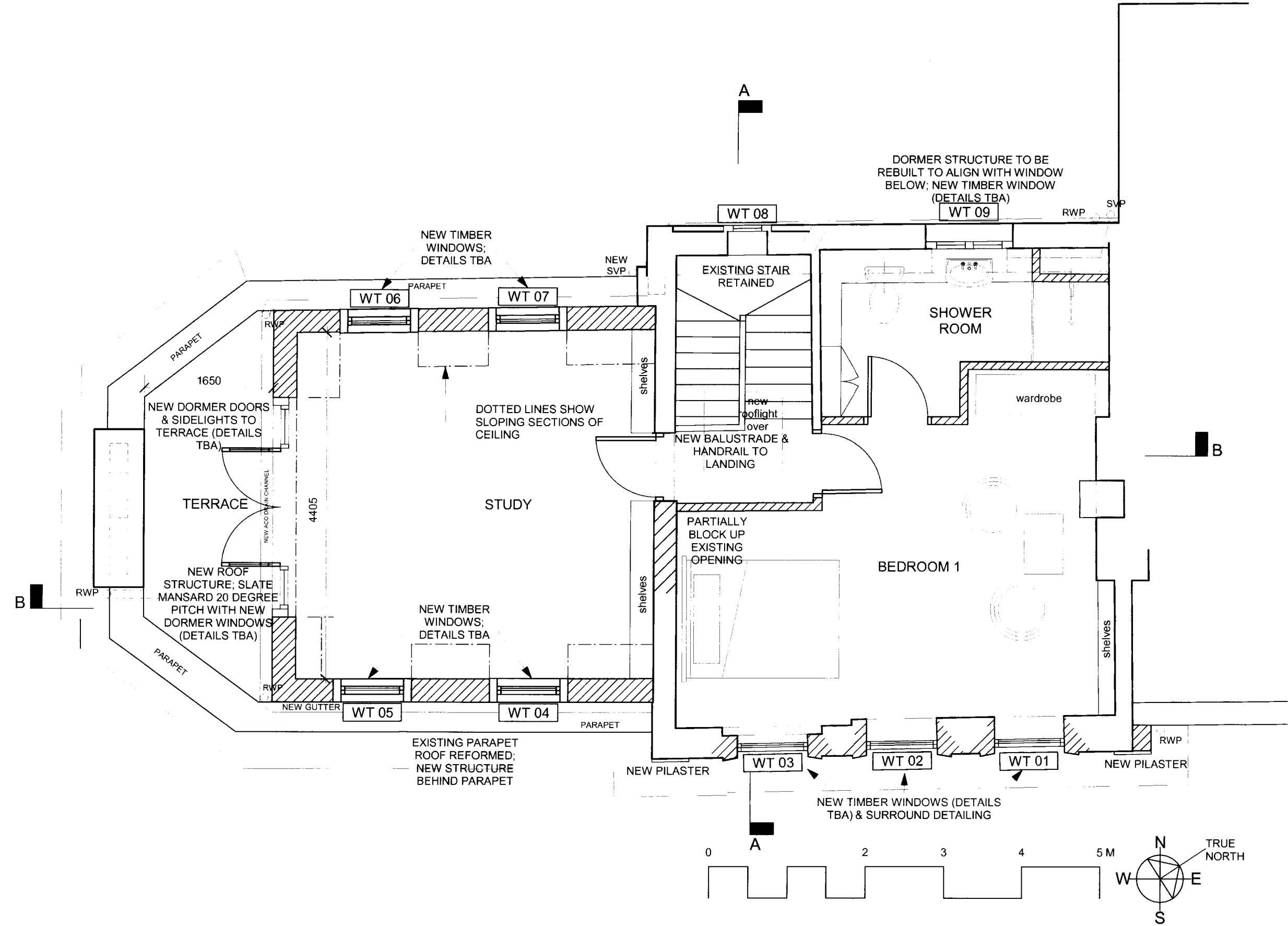

ARP