

DETAIL:
TYPICAL BEAM CLADDING DETAILS.
WALL CLADDING SIMILAR.
SCALE 1:5

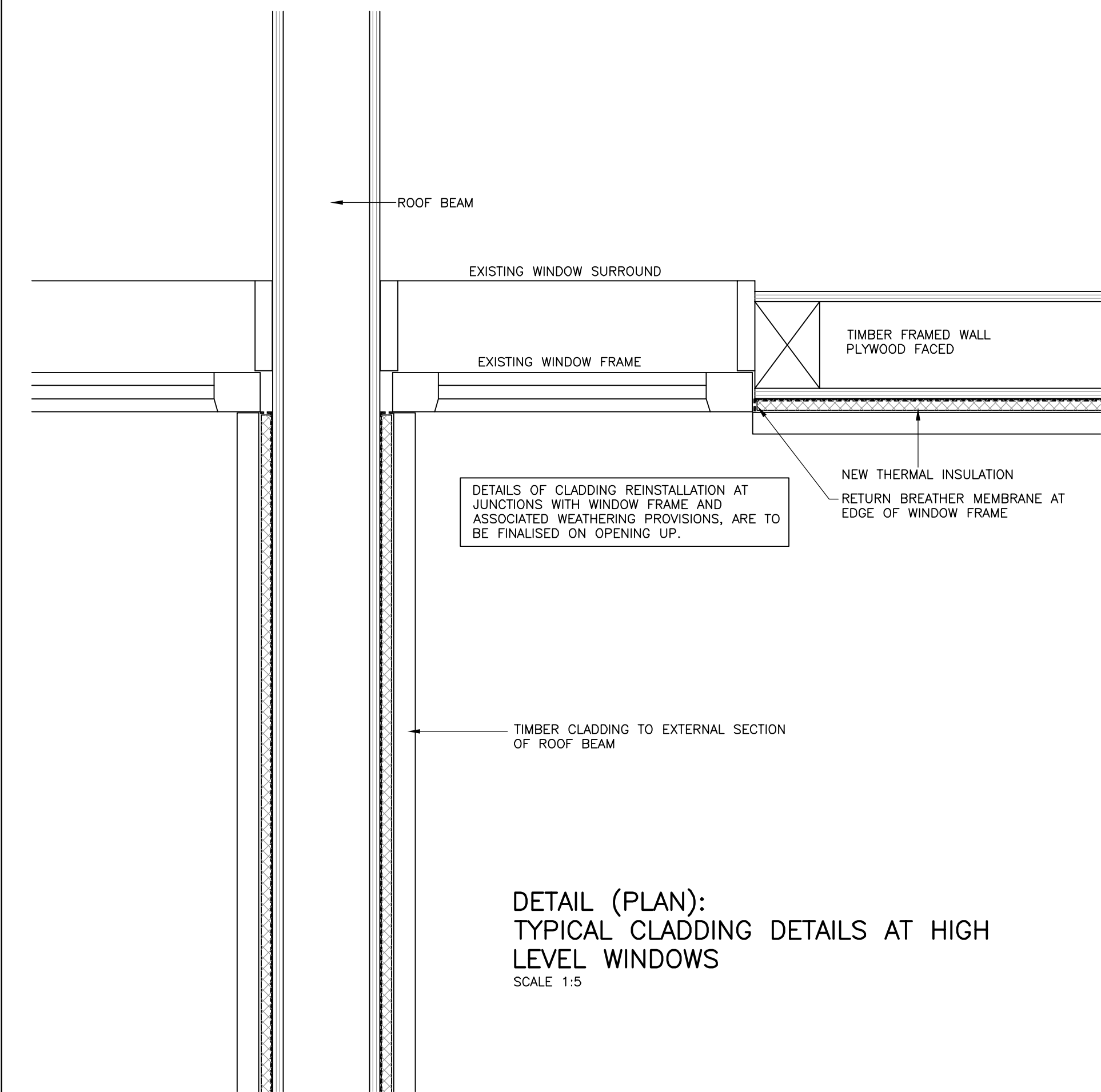

DETAIL (PLAN):
TYPICAL CLADDING DETAILS AT HIGH
LEVEL WINDOWS
SCALE 1:5

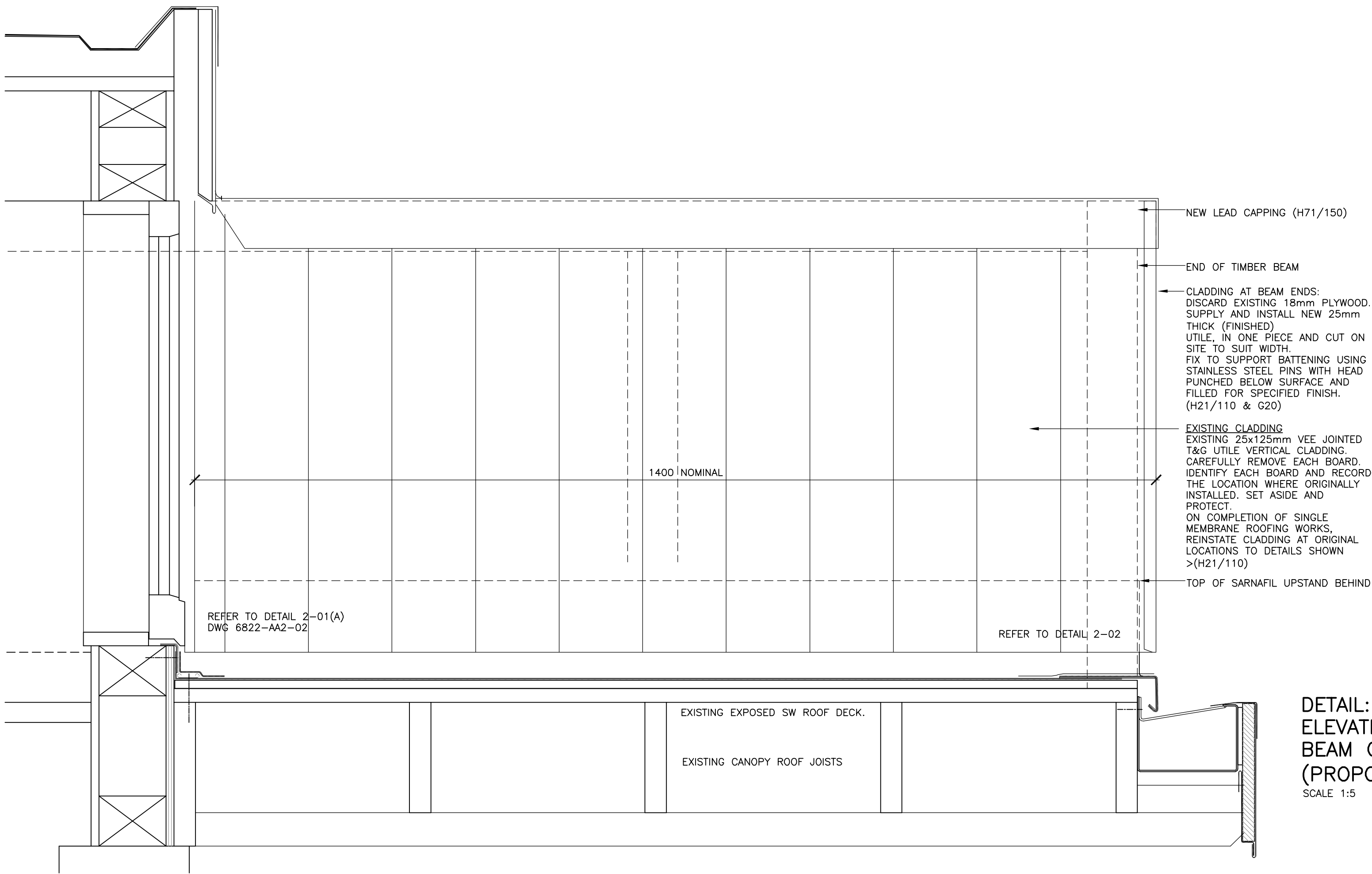

DETAIL:
ELEVATION OF ROOF
BEAM CLADDING
(PROPOSED)
SCALE 1:5

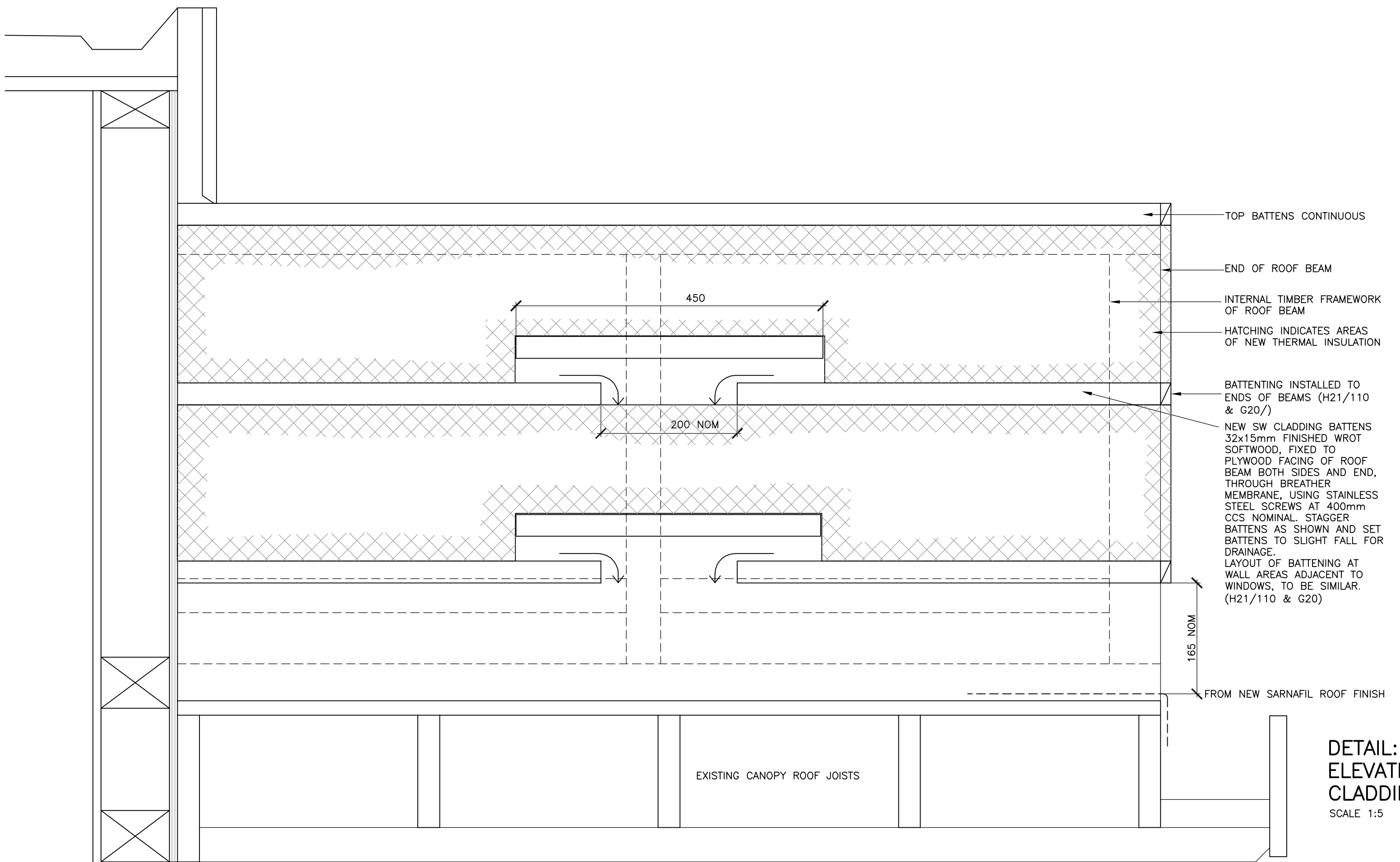

DETAIL:
ELEVATION OF
CLADDING BATTENS
SCALE 1:5

NOTES

FIGURED DIMENSIONS MUST BE TAKEN IN PREFERENCE TO SCALED DIMENSIONS

CONTRACTORS, SUB-CONTRACTORS AND SUPPLIERS MUST VERIFY ALL DIMENSIONS ON SITE BEFORE COMMENCING ANY WORK OR MAKING ANY SHOP DRAWINGS.

THIS DRAWING IS TO BE READ IN CONJUNCTION WITH STRUCTURAL, MECHANICAL AND ELECTRICAL DRAWINGS AND ALL OTHER RELEVANT INFORMATION. ANY DISCREPANCIES ARE TO BE REPORTED TO THE ARCHITECTS.

ALL DIMENSIONS AND DETAILS HAVE BEEN TAKEN FROM EXISTING RECORDS. THE CONTRACTOR IS REQUIRED TO CHECK DIMENSION AND DETAILS ON SITE.

TENDER

Rev	Date	Description	By
-	-	-	-

Bickerdike Allen Partners
121 Salusbury Road London NW6 6RG
Tel: (0207) 625 4411 Fax: (0207) 625 0250
e-mail: mail@bickerdikeallen.com

Project
REMEDIAL WORKS
38 MILLFIELD LANE, LONDON N6 6JB

Title
CANOPY ROOF DETAILS
TIMBER CLADDING DETAILS
SHEET 8 OF 8

Drawn	Checked	Apprvd	Job ref	Pha
GJ			6822	B
Date	Scale	Status	AA2-08	Rev
25/3/09	1:5	T		-