

**1 Arch Type B1**  
1 : 20

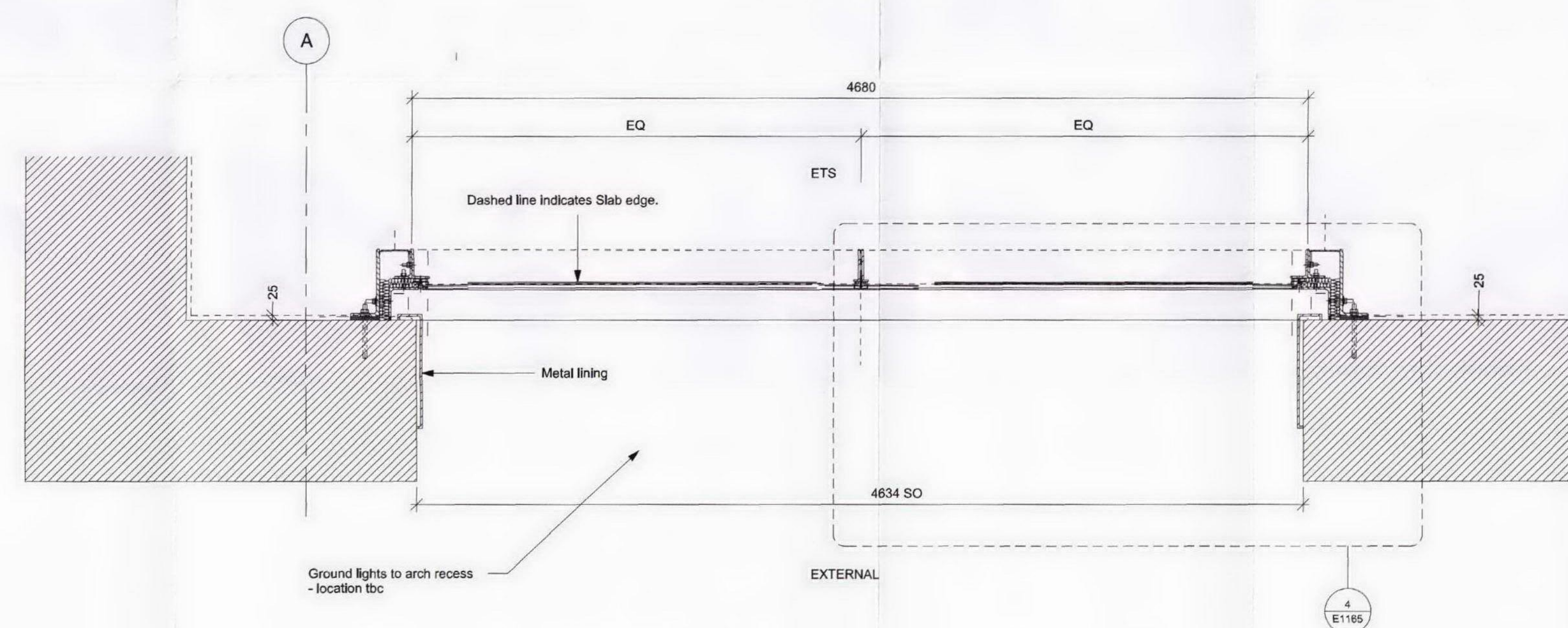

**2 ARCH TYPE B1 GROUND FLOOR**  
1 : 20

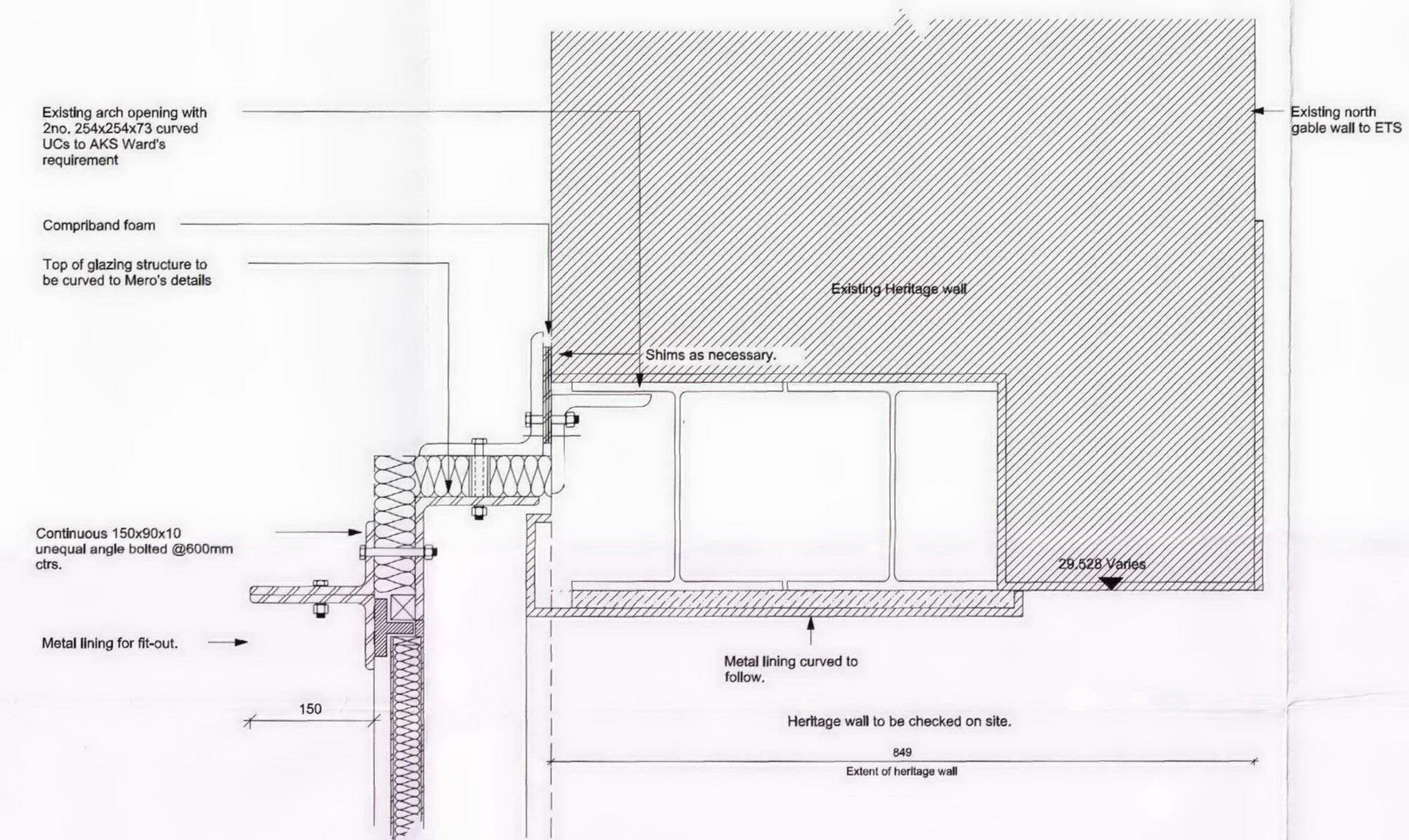

**3 Head Detail Arch Type B1**  
1 : 5

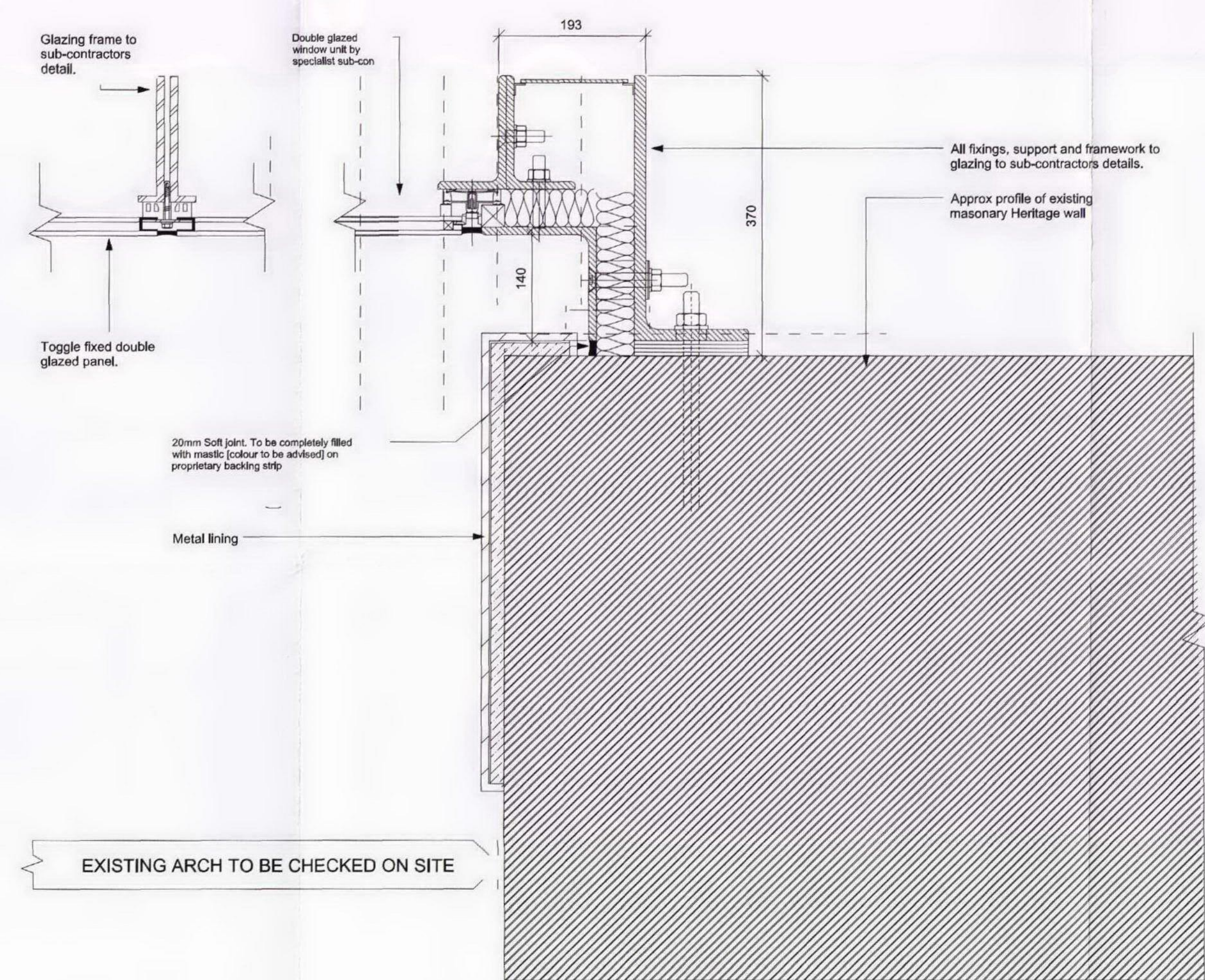

**4 Arch Type B1 Jamb Detail**  
1 : 5

ALL GLAZING & METAL DETAILS SHOWN INDICATIVE & T.B.C. WITH SUB-CONTRACTOR

ALL DIMENSIONS TO EXISTING HERITAGE WALLS TO BE CHECKED ONSITE.

ALL INSULATION TO PROVIDE U-VALUE 0.30/m2K OR BETTER.

ALL GLAZING TO PROVIDE U-VALUE 0.20/m2K OR BETTER.

ALL DETAILS SHOW DESIGN INTENT ONLY. ALL STRUCTURE AND MATERIALS TO BE CONFIRMED WITH SUB-CONTRACTOR.

ALL GLAZING ELEMENTS AND SURROUNDING STRUCTURE TO BE THERMALLY BROKEN AND MADE WATERTIGHT BY SUB-CONTRACTOR.

rev	by	date	chkd	amendments
B	AB	19 08 09	AB	Ground light note added.
A	AB	18 08 09	AB	Metal linings to reveals added.

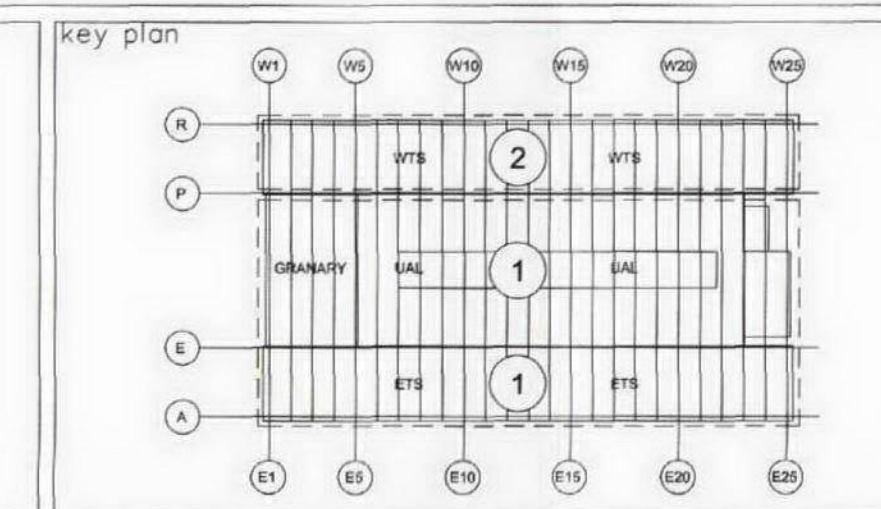

**bam**  
BAM Design Ltd  
An operating company of  
BAM Construction UK Ltd  
Central House  
Dorset, Wey, Dorset, UK  
B2000  
Tel: 01727 816000  
design@bam.co.uk

Architecture  
Structural  
Engineering Services  
Interior Design  
Feasibility  
Studio/animation

**project**  
**ARGENT ESTATES Ltd**  
**EGY - KINGS CROSS CENTRAL**  
**3753**

**title**  
**ETS - 1 to 20 NORTH GABLE ARCH TYPE B1 JUNCTION BETWEEN THE RETAINED HISTORIC FABRIC AND THE NEW BUILD ELEMENTS**

drawing status	AS PROPOSED
contract no.	LN0217
client ref.	ARGENT
drawn by	A.OH
checked by	SR
drawing no.	3753
ARCH	E1165 (PL)
B	

RECEIVED 28 AUG 2009