

This drawing, the work of architecture to which it relates, and any notes relating to them are protected by copyright. To the extent that this is a design document it is, in addition, protected by design right. All rights in them are reserved. They are provided for your information about the application only. No part of them or any design to which they relate may be reproduced in any form or any means without the prior written permission of Fairview New Homes Limited, except as expressly permitted by law. The doing of any unauthorised act in relation to them may result in both a civil claim and criminal prosecution.

© john pardey architects

cad file:

Notes

rev	date	initials	description
-----	------	----------	-------------

drawing:  
**SECTION A-A PROPOSED**

project:  
**0710-BELMONT STREET**

drawing no: 710-351  
revision:

status:

**PLANNING**

scale @ A1/A3: 1:100 / 1:200  
date: JUNE 09

**JOHN PARDEY ARCHITECTS**

beck farm studio  
st leonards road  
east end  
lymington  
hamshire  
SO41 5SR

t 01590 626465  
f 01590 626547

mail@johnpardeyarchitects.com  
www.johnpardeyarchitects.com

JPA Support Ltd. reg in england 449 6655. vat 656 588 581.

KEY PLAN

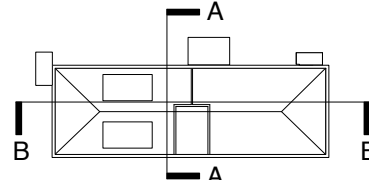

**PLANNING**