

EXISTING

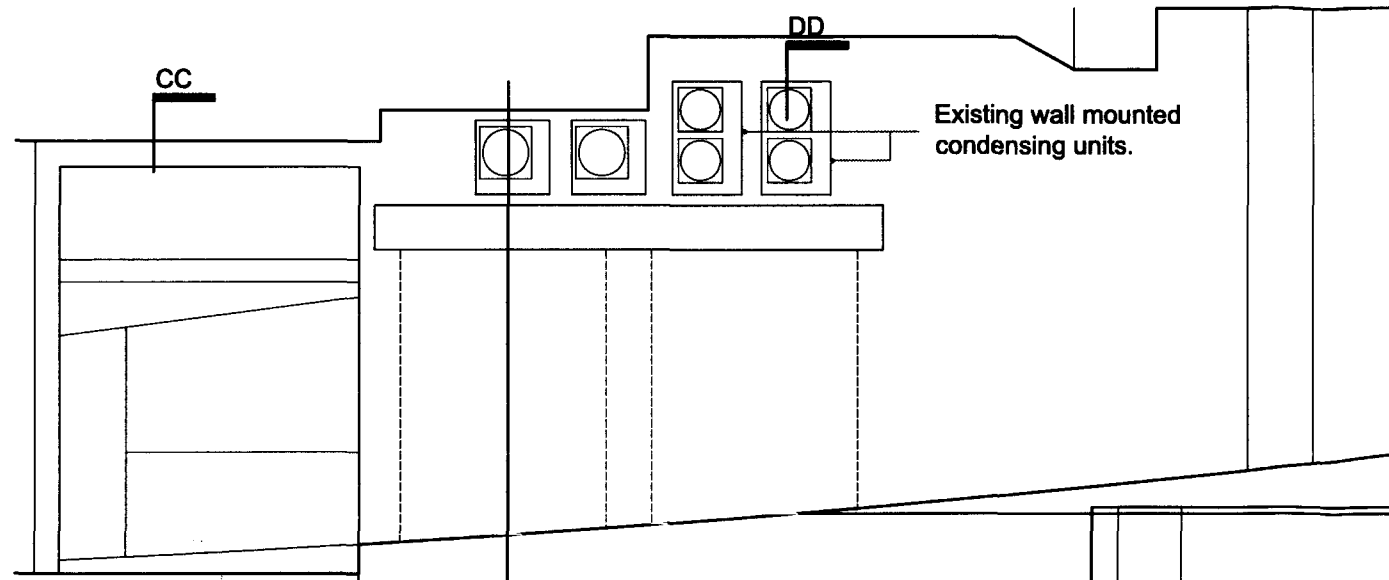

Existing Elevation AA - Scale 1:50

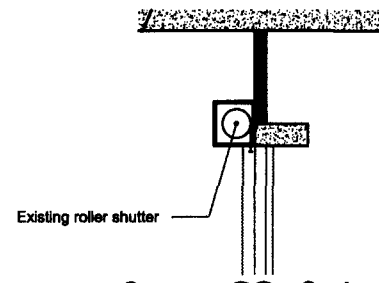

Section CC - Scale 1:50

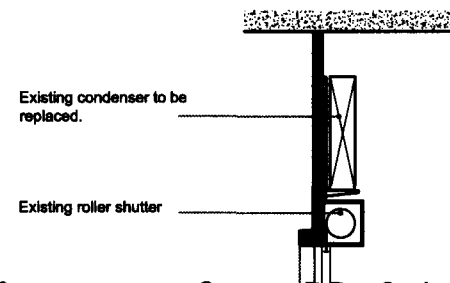

Section DD - Scale 1:50

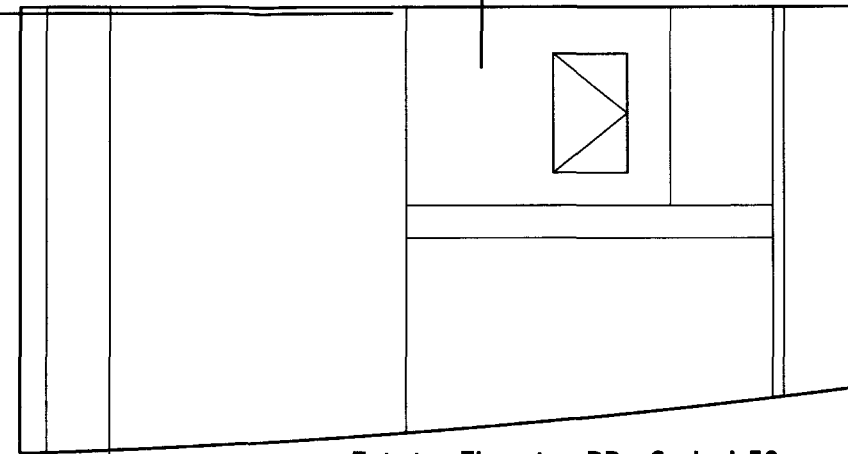

Existing Elevation BB - Scale 1:50

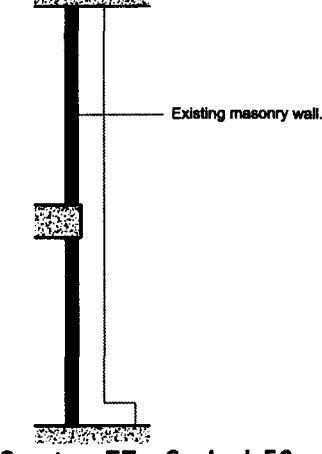

Section EE - Scale 1:50

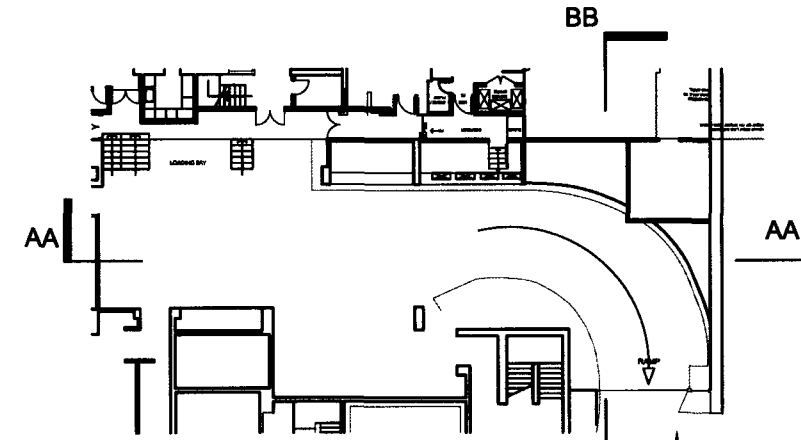

Location Plan - Scale 1:200

Access from Parker street.

FWP UK Ltd

Copyright Notice:
This drawing and any design thereon is the copyright of FWP UK Ltd and must not be reproduced without written consent.

RECEIVED
30 SEP 2009

PROPOSED

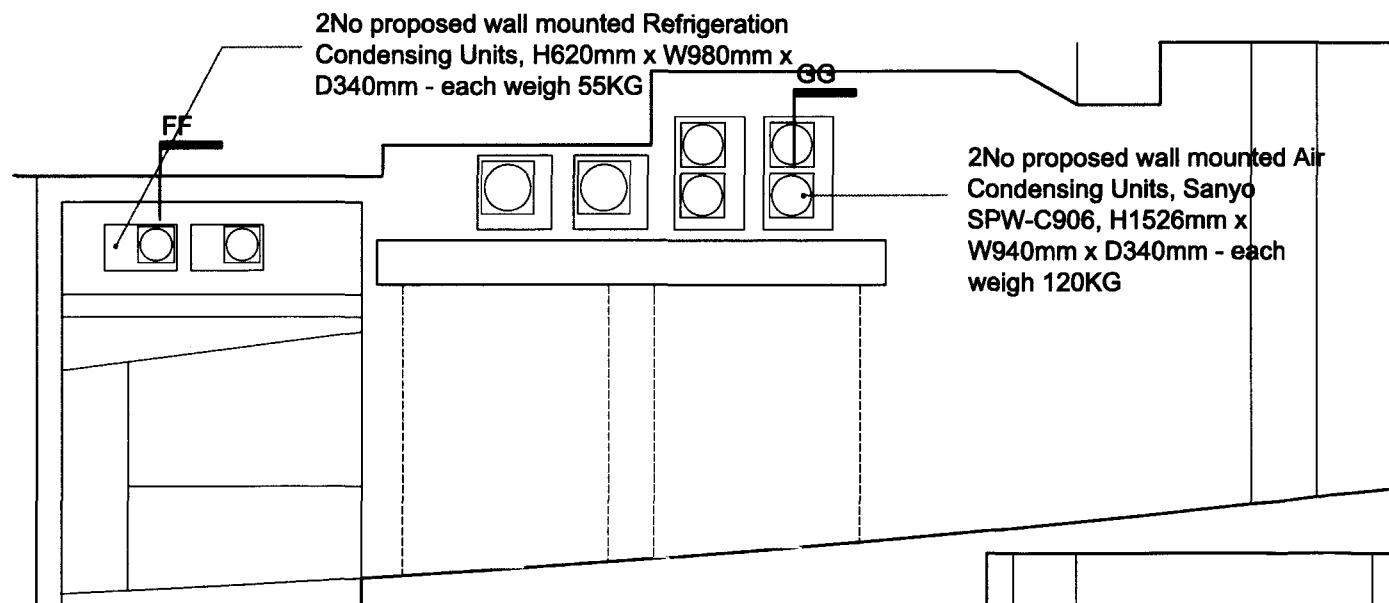

Proposed Elevation AA - Scale 1:50

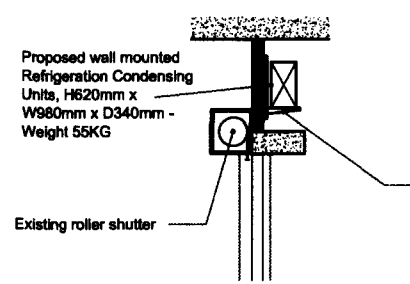

Section FF - Scale 1:50

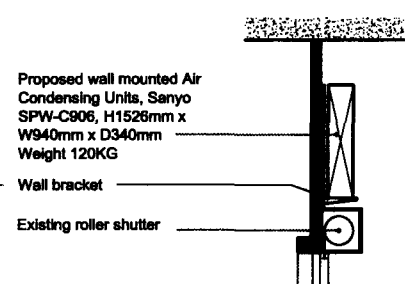

Section GG - Scale 1:50

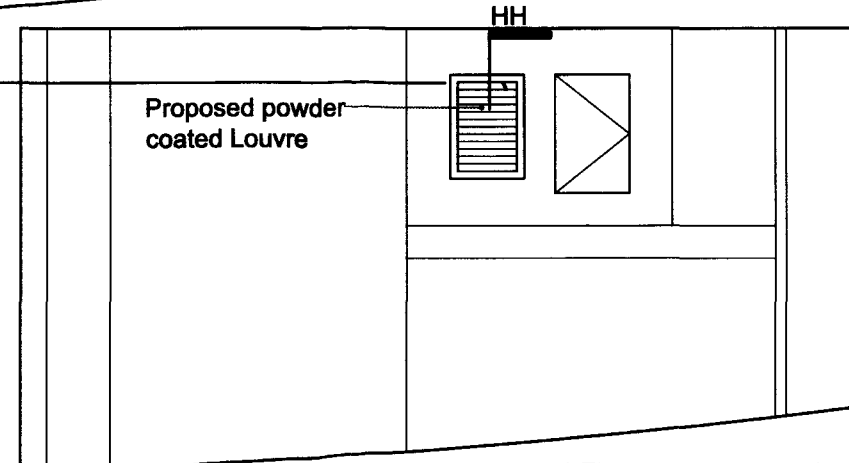

Proposed Elevation BB - Scale 1:50

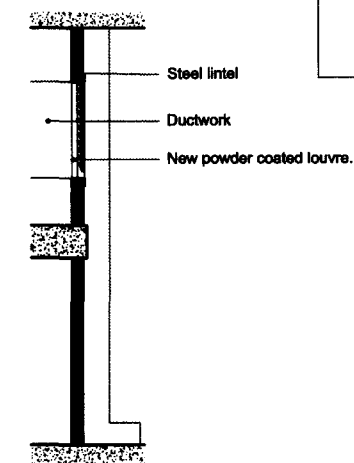

Section HH - Scale 1:50

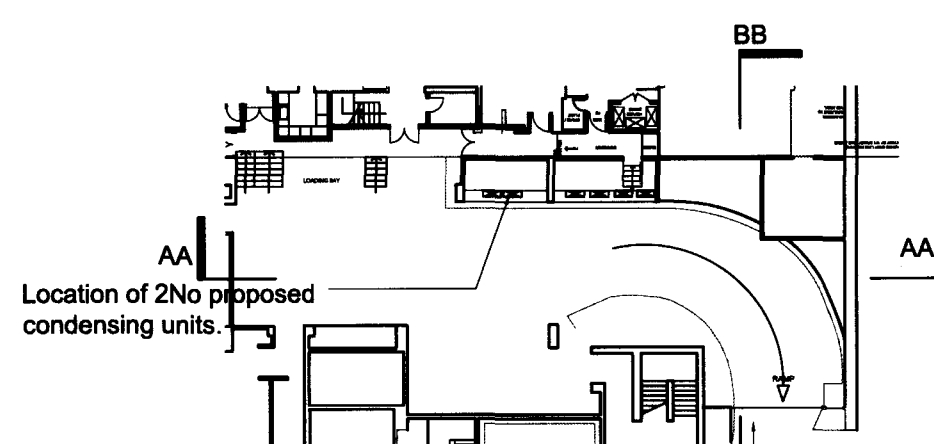

Location Plan - Scale 1:200

Access from Parker street.

T3 retaildesign

The Shorthorns,
Criffin Enterprise Centre,
Ocken Road,
Eppersham,
Nottinghamshire NG14 6AT

LOOKING GOOD IS AS EASY AS 1,2,3

FWP UK Ltd

4 Grantham Road
Radcliffe-on-Trent
Nottingham NG12 2DR
0115 933 3268
www.fwp-air-conditioning.co.uk

Drawn: JR checked: Date: 24.09.09

Issue: Provisional ☒ Approved ☐ As Built ☐ Current ☐

Project: 170A - 171 Drury Lane

Drawing Title: Existing & Proposed Rear Area Services Layout

Drawing Number: Drury Lane/FWP/003

Rev: A Paper Size: A1 Scale: 1:50