

**KEY**

Existing wall

New partition- formed from 2 layers of 12.5mm Gyproc Wallboard on either side

Existing wall removed

Ceiling height

+ 32.32 Level from benchmark

Line of 30 minutes fire resistance

Gas supply pipe run in ceiling above

Soil pipe drainage run in ceiling above

**ELECTRICAL**

Smoke detector

Heat detector

Pendant light fitting

Downlighter

E suffix denotes emergency fitting

Extract fan

NOTE: Lights in wet rooms/ bathrooms to have appropriate IP rating

All wiring and electrical work to be designed, installed, inspected and tested in accordance with the requirements of BS7671, the current edition of the IEE Wiring Guidance and Building Regulation (Part P)

All switches to be mounted at a level between 450mm and 1200mm floor level, see drawing 122.300.

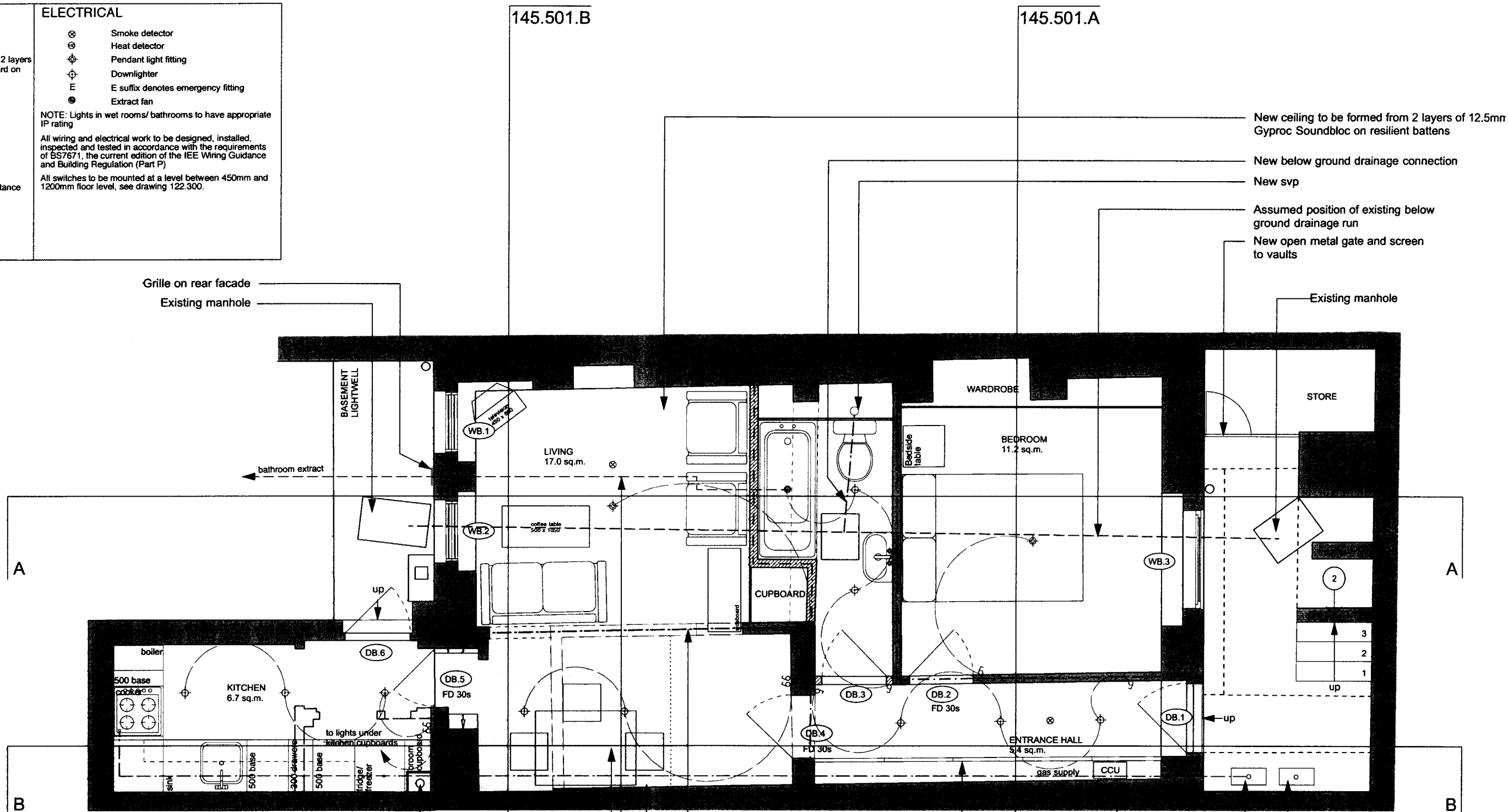

**DOORS AND WINDOWS**

(WB.1) Existing window to be retained, refurbished and redecorated

(WB.2) Existing window to be retained, refurbished and redecorated

(WB.3) Existing window to be retained, refurbished and redecorated

(DB.1) Existing external entrance door to be replaced with new glazed door

(DB.2) New timber flush fire door (FD30S), with new architraves

(DB.3) New timber flush fire door, with new architraves

(DB.4) New timber flush fire door (FD30S), with new architraves

(DB.5) New timber flush fire door (FD30S), with new architraves

(DB.6) Existing external door to be replaced with new glazed door

FD30S - fire door and frame to achieve a minimum of 30 minutes period of fire resistance when tested to BS 476: Part 22. Hung to open in one direction only, on metal hinges, no part of which has a melting point less than 800 degrees celsius. Frames to be in accordance with door manufacturer's instructions. S Suffix denotes requirement smoke seals. Note entrance doors to flats are required to be self closing. Self closing door to be effectively self closing by means of a spring device which will ensure that the doors are held firmly in the closed position and are free from any means of holding them in an open.

Existing svp

Shaded area indicates area of lowered ceiling under steps above. Anticipated ceiling height 2.00 m. Extract from bathroom

Existing kitchen to be removed

New transfer beam above (beneath stair partition) see Structural engineer drawing 4037/ 301

© 2008 syte architects limited

check all dimensions on site prior to commencement of the work

if the drawing exceeds the quantities in any way the architects are to be informed before work is commenced

do not scale dimensions from drawing. drawing is copyright

drawing to be read in conjunction with structural engineer's drawings and specification

**syte**

ARCHITECTS

83-84 Berwick Street London W1F 8TS T 020 7734 8310 F 020 7734 8301

revisions

REV A- 20-01-09 General ammendments, furniture added.

REV B- 17-07-09 Layout ammendments, alterations to rear addition removed

REV C- 04-08-09 General ammendments (for listed building officer comment)

REV D- 10-09-09 Listed Building application

client

Resolution Ltd.

project

93 Judd Street  
London  
WC1H 9NE

drawing title

Basement Plan  
as Proposed

date	drawn by	revision
Jan 09	BM	D
scale	checked by	drawing
1:50@A3	RW	145.210

**FOR INFORMATION**