

NOTES

1. This drawing shall be read in conjunction with all Mechanical and Electrical drawings, Schedules and Specification.
2. Pipework routes through floor joists to be confirmed with structural engineer prior to any notching on site.
3. All pipework penetrations through any structure to be sleeved with oversized tube of same material.
4. Domestic Water Services shall be installed in accordance with Water Supply (Water Fittings) Regulations 1999
5. All draw offs to be fitted with balloff valve.
6. All high points to be provided with air vents & all low points to be provided with drain cocks.
7. All pipework to be thermally insulated in accordance with BS 5422 except for final connections to appliances where it shall be painted by others to Architect's detail.
8. Contractor to site measure locations of plant prior to ordering.
9. Contractor to allow for on site co-ordination with the structure and other services and the production of fully dimensioned working drawings prior to installation.
10. For valving arrangements refer to schematic drawings.

Legend

R.T.A: Rise To Above
 D.T.L.L: Drop To Low Level
 C.V: Ceiling Void
 F&R: Flow & Return
 T.A: To Above
 F.B: From Below
 L.L: Low Level

- Pipework at low level.
- - - Pipework in floor.
- Pipework at high level.
- - - Pipework in ceiling void.

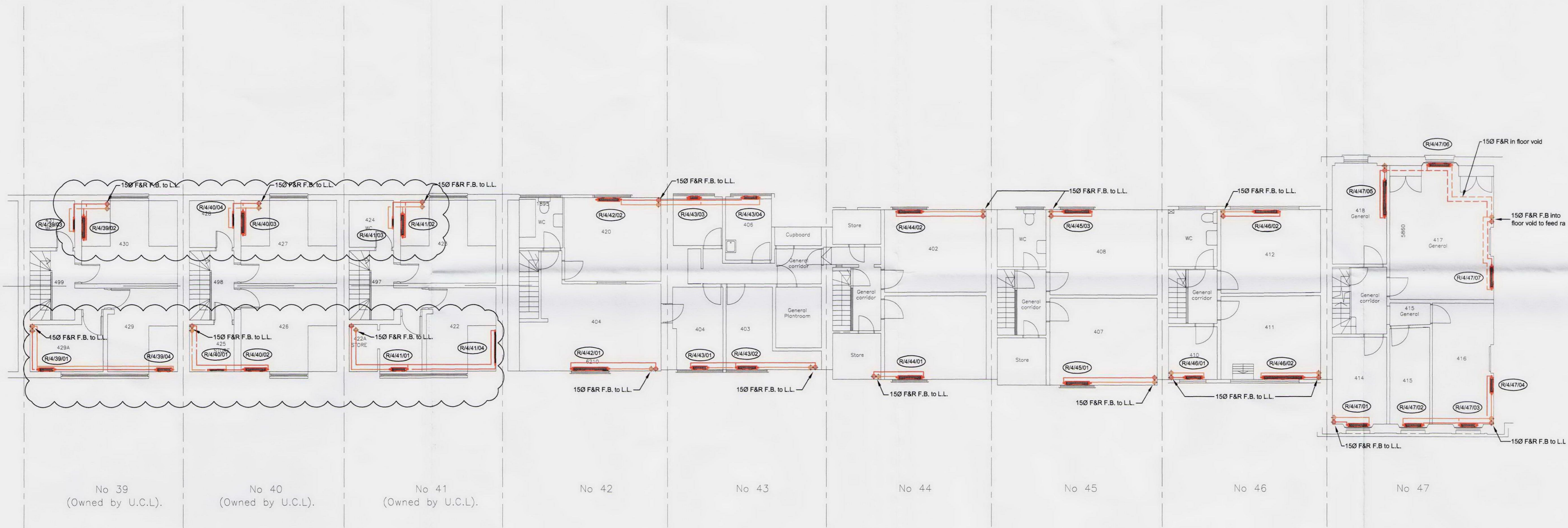

P1	12.05.09	Preliminary Issue
rev	date	description



mkp consultants ltd
 Building Services Consultants
 Units 2&3, Burcot Farm
 East Stratton, Winchester
 Hants, SO21 3DZ
 Tel: 01962 774665 Fax: 01962 774724 E-mail: info@mkpg.com

Client **Birkbeck College**
 University of London
 Department of Estates and Facilities
 Malet Street
 London WC1E 7HX
 Tel: 0171 631 6015
 Fax: 0171 631 6019

Project Title
**39-47 GORDON SQUARE
 BIRKBECK COLLEGE
 LPHW HEATING SYSTEM**

Drawing Title
**FOURTH FLOOR
 PROPOSED HEATING
 LAYOUT**

Drawn	Date	Checked	Approved
SJL	OCT' 08		

Scale	Size	Issue
1:100	<input type="radio"/> A4 <input type="radio"/> A3 <input checked="" type="radio"/> A1 <input type="radio"/> A0	<input checked="" type="radio"/> Preliminary <input type="radio"/> Tend <input type="radio"/> Construction

Drg. No. **2188-M-030** Rev **P1**