

NOTES

- This drawing shall be read in conjunction with all Mechanical and Electrical drawings, Schedules and Specification.
- Pipework routes through floor joists to be confirmed with structural engineer prior to any notching on site.
- All pipework penetrations through any structure to be sleeved with oversized tube of same material.
- Domestic Water Services shall be installed in accordance with Water Supply (Water Fittings) Regulations 1999
- All draw offs to be fitted with ballcock valve.
- All high points to be provided with air vents & all low points to be provided with drain cocks.
- All pipework to be thermally insulated in accordance with BS 5422 except for final connections to appliances where it shall be painted by others to Architect's detail.
- Contractor to site measure locations of plant prior to ordering.
- Contractor to allow for on site co-ordination with the structure and other services and the production of fully dimensioned working drawings prior to installation.
- For valving arrangements refer to schematic drawings.

Legend

R.T.A. Rise To Above
 D.T.L.L. Drop To Low Level
 C.V. Ceiling Void
 F&R: Flow & Return
 T.A. To Above
 F.B. From Below
 L.L. Low Level

- Pipework at low level.
- - - Pipework in floor.
- - - Pipework at high level.
- - - Pipework in ceiling void.

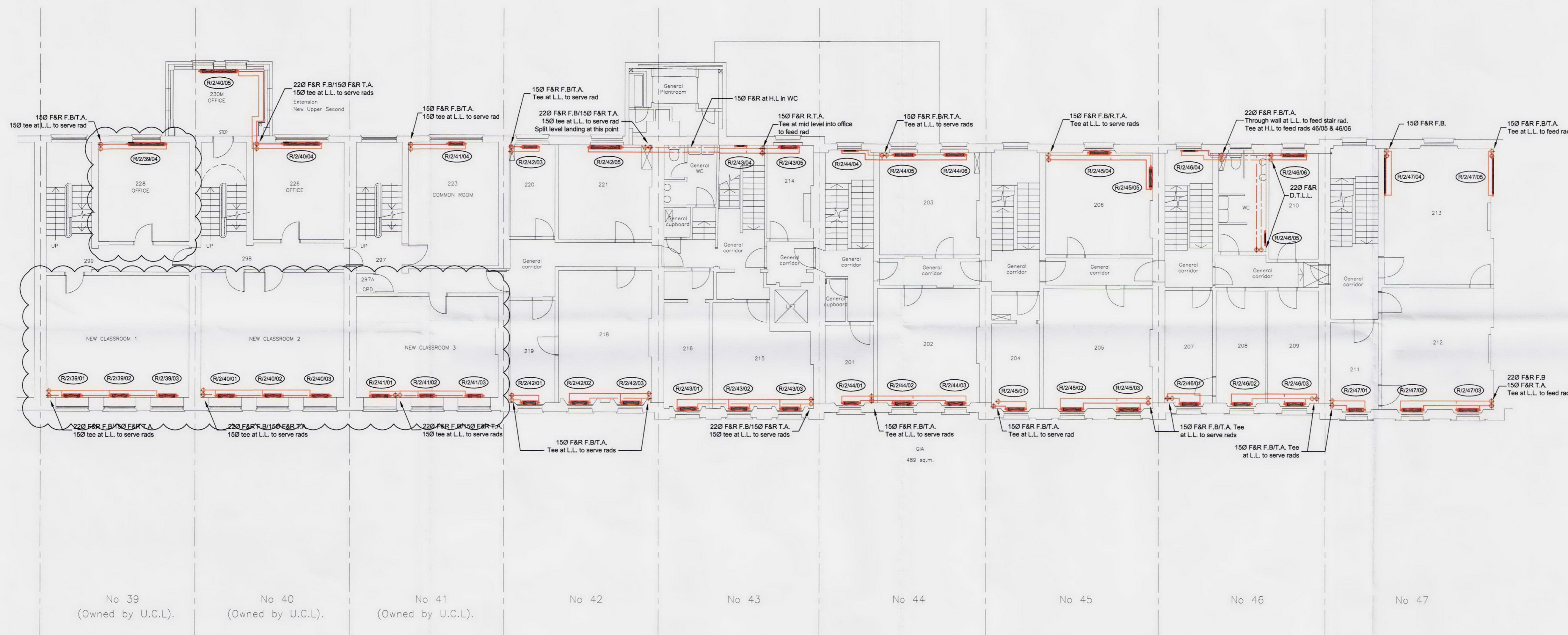

P2	25.08.09	New rooms incorporated
P1	12.05.09	Preliminary Issue
rev	date	description



Units 2&3, Burcot Farm
 East Stratton, Winchester
 Hants, SO21 3DZ
 Tel: 01962 774665 Fax: 01962 774724 E-mail: info@mkpg.com

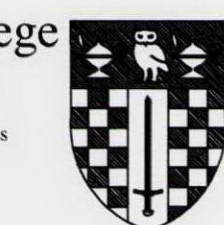

Client
Birkbeck College
 University of London
 Department of Estates and Facilities
 Malet Street
 London WC1E 7HX
 Tel: 0171 631 6015
 Fax: 0171 631 6019

Project Title
**39-47 GORDON SQUARE
 BIRKBECK COLLEGE
 LPHW HEATING SYSTEM**

Drawing Title
**SECOND FLOOR
 PROPOSED HEATING
 LAYOUT**

Drawn	Date	Checked	Approved
SJL	OCT '08		

Scale	Size	Issue
1:100	<input type="radio"/> A4 <input type="radio"/> A3 <input checked="" type="radio"/> A1 <input type="radio"/> A0	<input checked="" type="radio"/> Preliminary <input type="radio"/> Tend <input type="radio"/> Construction

Drg. No. **2188-M-028** Rev **P**