

KEY

- Denotes existing walls to be removed.
- ===== Denotes existing walls to be retained.
- //// Denotes new blockwork wall

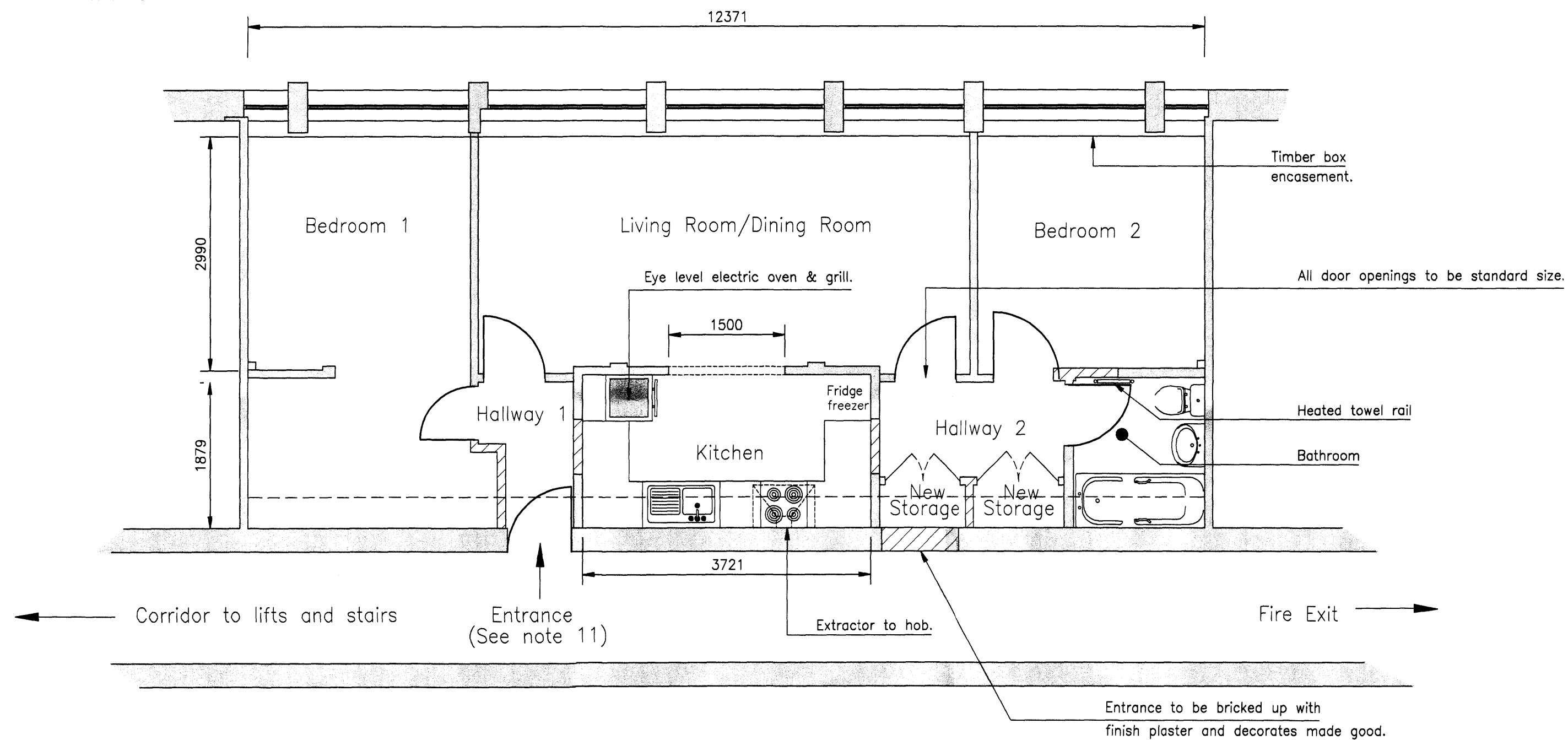

Proposed Re-design layout

Scale 1:50 at A2

NOTES

1. ALL ERRORS AND OMISSIONS ARE TO BE REPORTED TO THE ENGINEER.
2. THIS DRAWING IS THE COPYRIGHT OF 'WYATT CARRUTHERS JEBB LTD.'
3. THIS DRAWING SHOULD NOT BE SCALED.

THIS DRAWING IS TO BE READ IN CONJUNCTION WITH SECTION 2 - SCHEDULE OF WORKS WITHIN THE TENDER DOCUMENTS.

BY PRIOR ARRANGEMENT WITH WCJ THE TENANT IS TO BE ALLOWED SUPERVISED ACCESS TO THE PROPERTY DURING THE REFURBISHMENT. THESE VISITS ARE TO AGREE THE FOLLOWING:

a) FINAL POSITIONS OF LIGHT SOCKETS AND POWER SWITCHES

b) FINAL COLOUR SCHEMES

c) DETAILS OF STORAGE TO BE AGREED ie. SHELVING, CUPBOARDS ETC.

KITCHEN TO BE SUPPLIED BY HOWDENS OR SIMILAR AND PROVISION FOR THE FOLLOWING IS TO BE MADE:

- a) FULL HEIGHT FRIDGE FREEZER
- b) SEPARATE EYE LEVEL OVEN AND GRILL (ELECTRIC FAN ASSISTED)
- c) SEPARATE WORKTOP GAS HOB
- d) WASHING MACHINE (PLUMBED IN)
- e) COOKER HOOD OVER HOB.
- f) BASE UNITS OF KITCHEN TO HAVE DRAWER LINE
- g) TENANT TO BE CONSULTED ON FINAL CHOICE OF DOOR FRONTS AND HANDLES.

FLOORS IN KITCHEN AND BATHROOMS TO HAVE NON-SLIP VINYL, ALTRO OR SIMILAR AND COLOUR TO BE AGREED WITH TENANT.

LOUNGE AND BEDROOM CARPETS TO BE AGREED WITH TENANT.

DOOR OPENINGS TO ALL ROOMS TO REMAIN AS STANDARD.

CONTRACTOR TO INSTALL COAT HOOKS AND CURTAIN RAILS TO AREAS SPECIFIED BY TENANT.

CONTRACTOR TO INSTALL NEW 5 LEVER CHUBB LOCK TO FRONT DOOR WITH "SPY" HOLE AND SECURITY CHAIN.

TELEPHONE SOCKETS TO BE FITTED TO EACH BEDROOM AND TO LOUNGE.

Issue	Date	Notes	By	Review
-------	------	-------	----	--------

Client

Project
Proposed Refurbishment for disabled use at 12a & 12b Maple House. 30/40 Grafton Way

Drawing
Proposed Floor Plan

Date Drawn	Drawn by	Initiator	Scale
Jul/08	PC	KE	AS STATED

Drawing status
TENDER



THAMES MEWS
PORTSMOUTH ROAD
ESHER SURREY KT10 9AD
TEL 01372 466118
FAX 01372 466476
E-MAIL hq@wcjeng.co.uk

Dwg. No.	14358/04	Issue	A
----------	----------	-------	---