

CAMDEN HIGH STREET
(BELOW)

A1

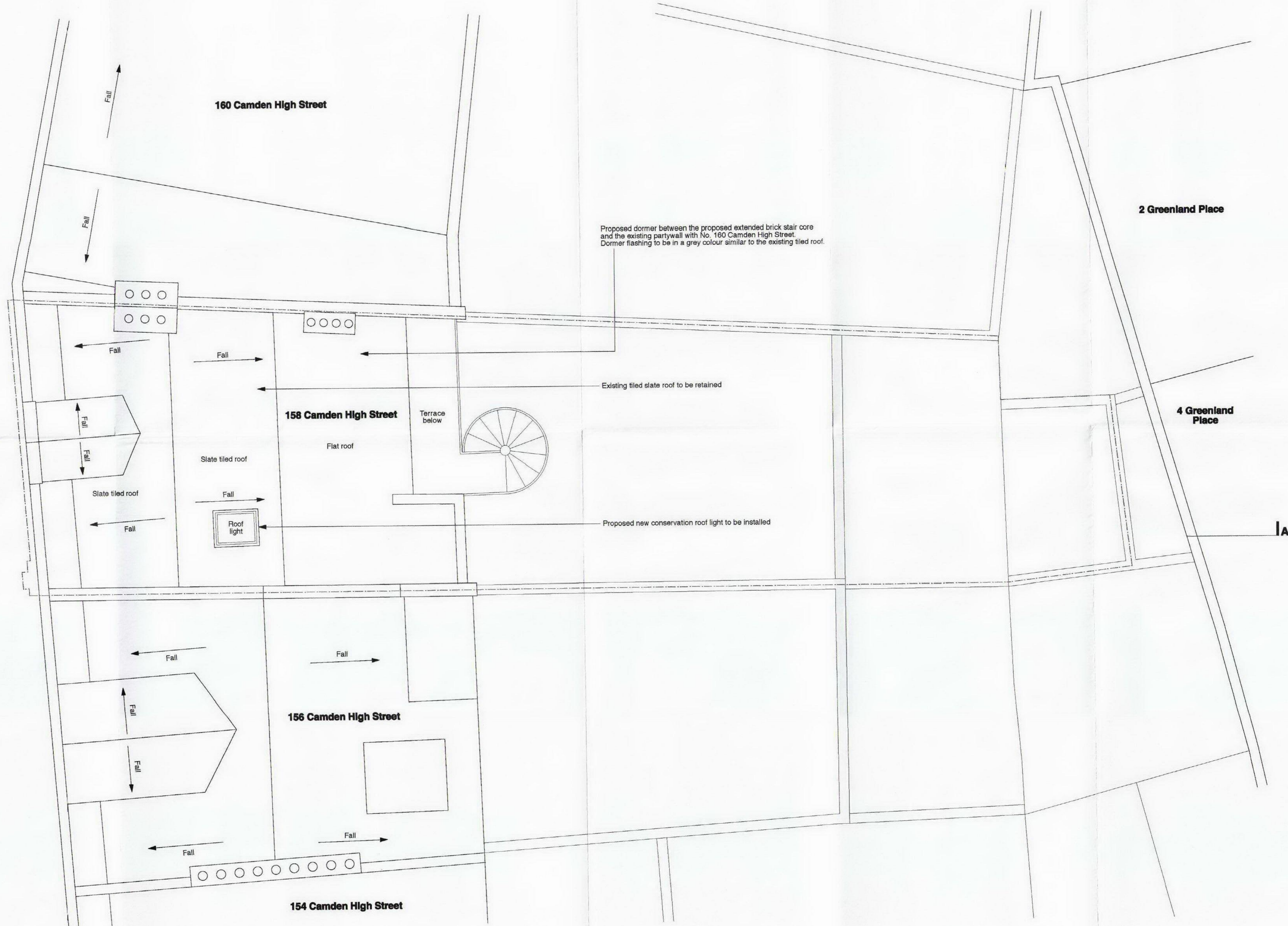

Proposed dormer between the proposed extended brick stair core and the existing partywall with No. 160 Camden High Street. Dormer flashing to be in a grey colour similar to the existing tiled roof.

Existing tiled slate roof to be retained

Proposed new conservation roof light to be installed

RECEIVED
17 NOV 2009

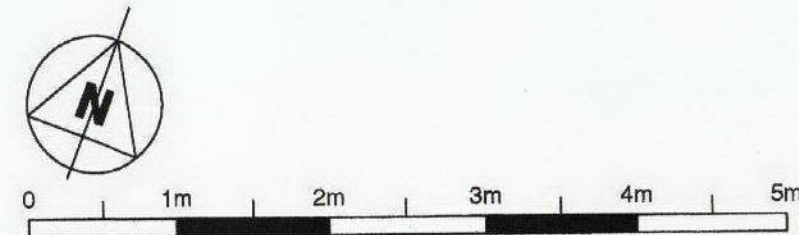

PROPOSED ROOF PLAN

A	16/11/09	Scale increased to 1:50
rev.	date	notes
© gpad ltd.		
gpad		
CLIENT	FOCUSSED UK LTD	
PROJECT	158 CAMDEN HIGH STREET LONDON, NW1 ONE	
TITLE	PROPOSED ROOF PLAN	
DWG NO	234A(PA)105	REV A
DRAWN BY	J.W	SCALE 1:50@A1 1:100@A3
CHECKED BY		DATE Oct 09
general practice architects & designers gpad ltd, 8 acon st, london, wc1x 8ng t: 020 7833 0222 f: 020 7833 2200 e-mail: info@gpadltd.com web: www.gpadltd.com		
<small>This drawing is the copyright of gpad ltd. Figures dimensions to be taken in preference to those printed. All dimensions to be checked on site before any work proceeds. Drawing not to be used for land transfer purposes. Drawings to be read in conjunction with relevant drawings and specification. Not to be reproduced, retained or disclosed to any unauthorised person either wholly or in part without written permission.</small>		
FILE NAME	PRINT SIZE	A1