

CAMDEN HIGH STREET

A1

IA

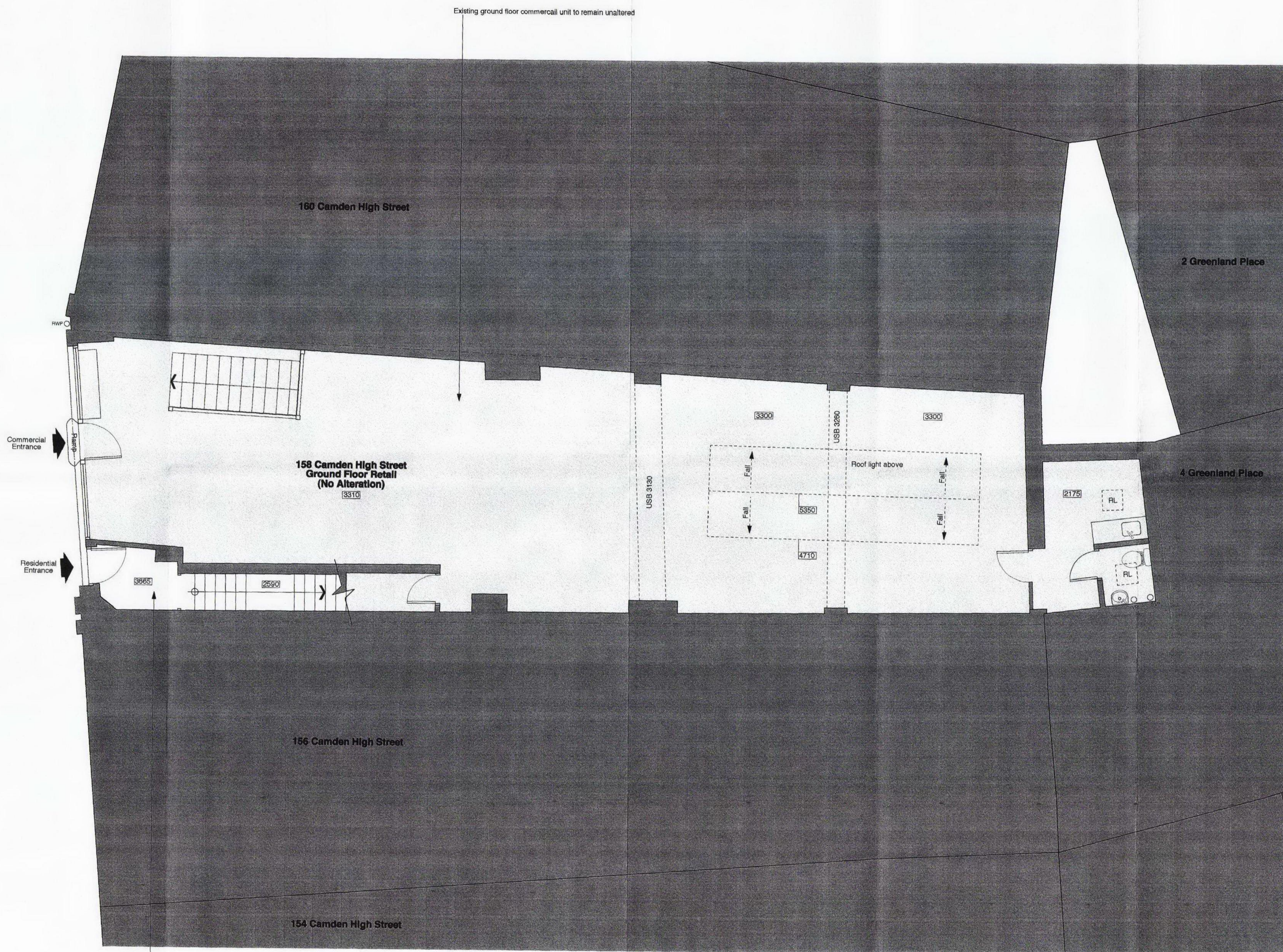

RECEIVED
17 NOV 2009

A	16/11/09	Scale increased to 1:50
REV.	date	notes
		© gpad ltd.
gpad		
CLIENT FOCUSSED UK LTD		
PROJECT 158 CAMDEN HIGH STREET LONDON, NW1 ONE		
TITLE PROPOSED GROUND FLOOR PLAN		
DWG NO	234A(PA)100	REV A
DRAWN BY	J.W	SCALE 1:50@A1 1:100@A3
CHECKED BY		DATE Oct 09
<small>general practice architects & designers gpad ltd, 6 action st, london, w6 1z 8ng t: 020 7833 0222 f: 020 7833 2220 e-mail: info@gpadltd.com web: www.gpadltd.com</small>		
<small>This drawing is the copyright of gpad ltd. Figured dimensions to be taken in preference to those scaled. All dimensions to be checked on site before any work proceeds. Drawing not to be used for tender purposes. Drawings to be read in conjunction with relevant drawings and specification. Not to be reproduced, retained or disclosed to any unauthorised person either wholly or in part without written permission.</small>		
FILE NAME		PRINT SIZE A1

