

CAMDEN HIGH STREET
(BELOW)

A1

Line of pavement (below)

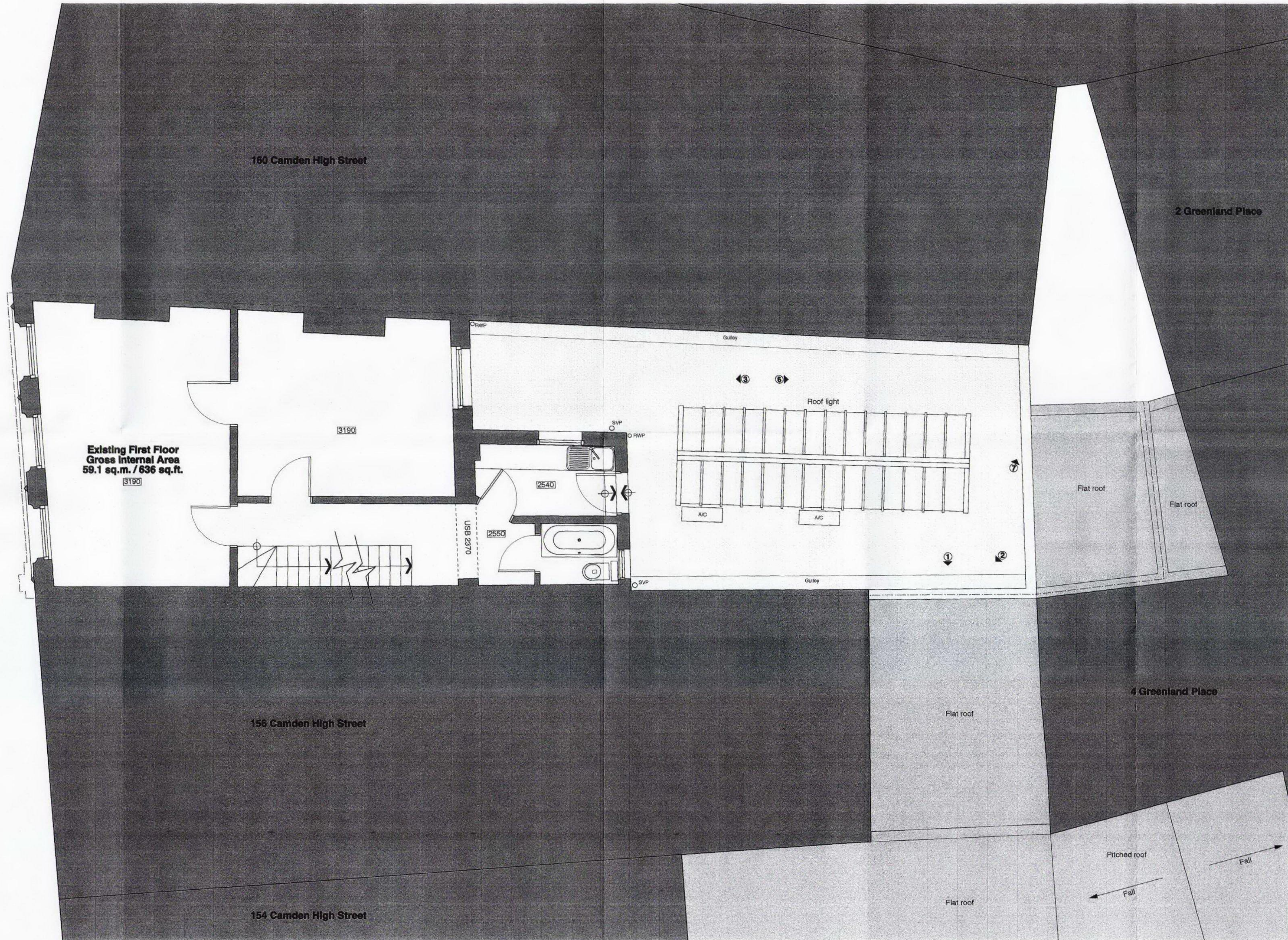

RECEIVED
17 NOV 2009

1A

KEY:
Ⓜ Refer to drawings 234A-(EX)98 for photos from these positions.

| | | | |
|------|----------|-------------------------|-------------|
| A | 16/11/09 | Scale Increased to 1:50 | |
| rev. | date | notes | © gpad ltd. |



CLIENT
FOCUSED UK LTD

PROJECT
**158 CAMDEN HIGH STREET
LONDON, NW1 ONE**

TITLE
EXISTING FIRST FLOOR PLAN

DWG NO
234A(EX)101

REV
A

DRAWN BY
J.W

SCALE
**1:50@A1
1:100@A3**

CHECKED BY
Oct 09

general practice architects & designers
gpad ltd, 8 action st, london, w1x 3sq
t: 020 7833 0222 f: 020 7833 2228
e-mail: info@gpadltd.com
web: www.gpadltd.com

FILE NAME
A1

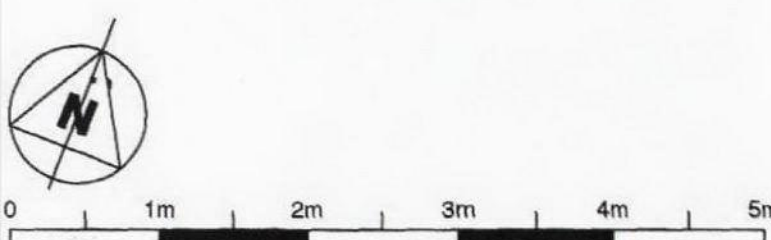

EXISTING FIRST FLOOR PLAN