

This drawing, the work of architecture to which it relates, and any notes relating to them are protected by copyright. To the extent that this is a design document it is, in addition, protected by design right. All rights in them are reserved. They are provided for your information about the application only. No part of them or any design to which they relate may be reproduced in any form or any means without the prior written permission of John Pardey Architects Limited, except as expressly permitted by law. The doing of any unauthorized act in relation to them may result in both a civil claim and criminal prosecution.

© John Pardey Architects  
 cad file

Notes

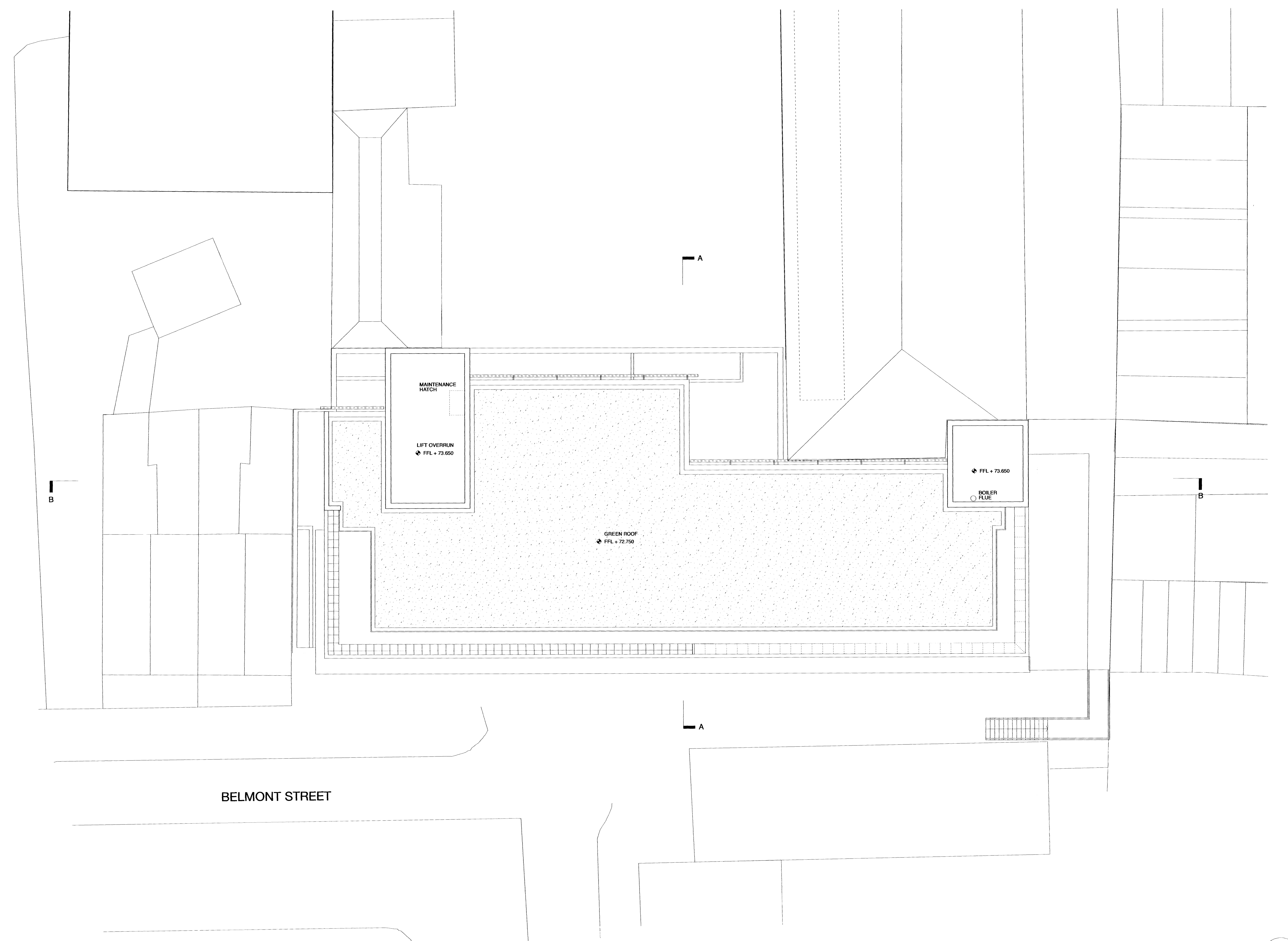

rev	date	initials	description

drawing: **ROOF PLAN PROPOSED**  
 project: **0710-BELMONT STREET**  
 drawing no: **710-258** revision: **A**  
 status: **PLANNING**  
 scale @ A1/A3: **1:100 / 1:200** date: **NOV 09**

**JOHN PARDEY ARCHITECTS**  
 Beck Farm Studio  
 31 Leards Road  
 Lynton, Devon  
 Somerset  
 SA41 5SR  
 t 01590 626665  
 f 01590 626667  
 m +447794049494  
 www.johnpardeyarchitects.com  
 JPA Regd No: 141489666, Ltd No: 507511

