

Basement Plan

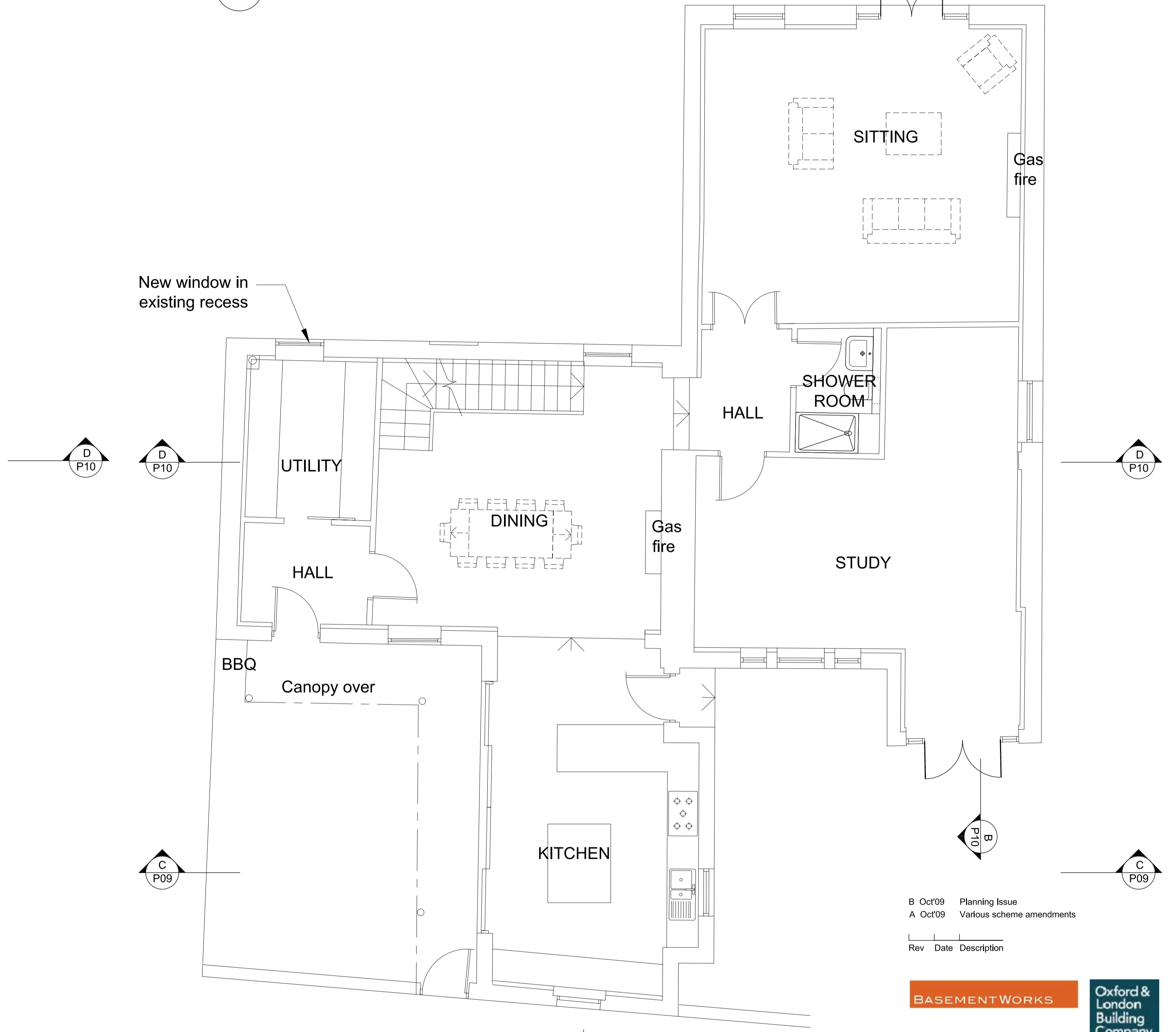

Ground Floor Plan

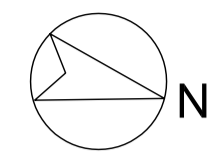
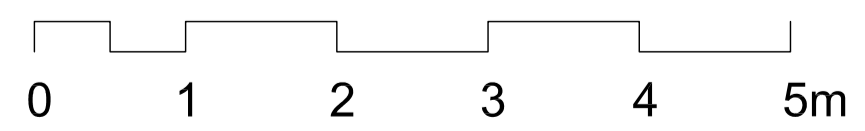
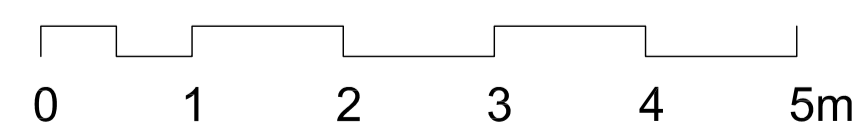

B	Oct'09	Planning Issue
A	Oct'09	Various scheme amendments
Rev	Date	Description

BASEMENTWORKS



88 Merton Road
London SW18 5SR

0870 240 1297
info@olbc.co.uk
www.olbc.co.uk

site
Hollow Point, Kings College Road,
London NW3 3ES

title
Proposed Basement and Ground Floor Plan

date	scale
Aug'09	1:50
job	drawing no
378 / P07	B

