

- General Notes
1. Dimensions are in millimetres unless stated otherwise
 2. All levels are in metres above AOD unless stated otherwise
 3. Dimensions given. Do not scale off of drawing
 4. All dimensions to be verified on site before proceeding
 5. All discrepancies to be notified in writing to Schmidt-Hess Architects

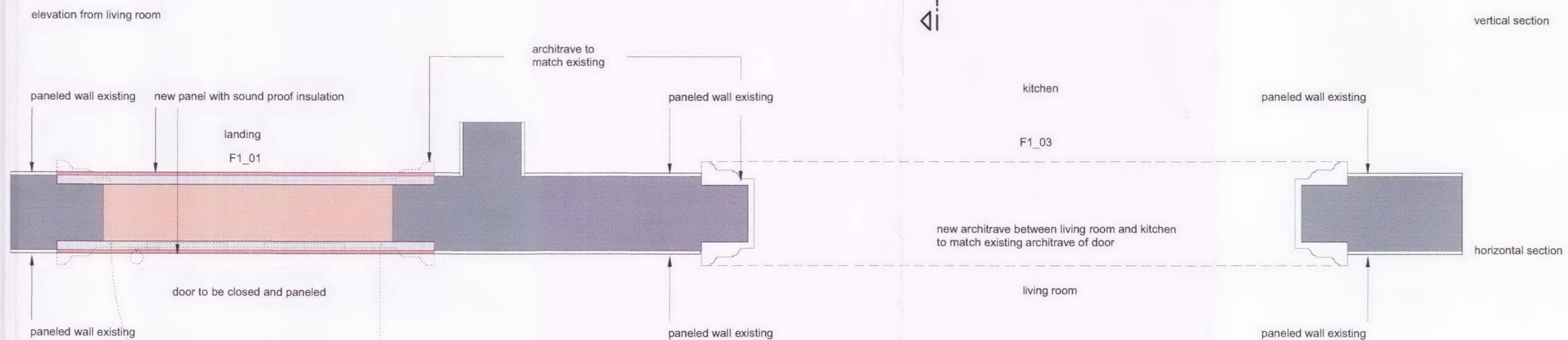

Client
Albert Hay

Project
19 Hampstead High Street
London NW3

Project No
009

Drawing No
A4051

Rev.
00

Drawing Title
Architrave / Living Room
First Floor
Proposed

Scale
1:10

Paper Size
@A2

Date
27.11.2009

SCHMIDT-HESS ARCHITECTS

Unit 4.3
2-6 Northburgh Street
London EC1V 0AY

+44 (0)20 3093 4170
www.sh-a.co.uk
info@sh-a.co.uk