

Elevation Inside

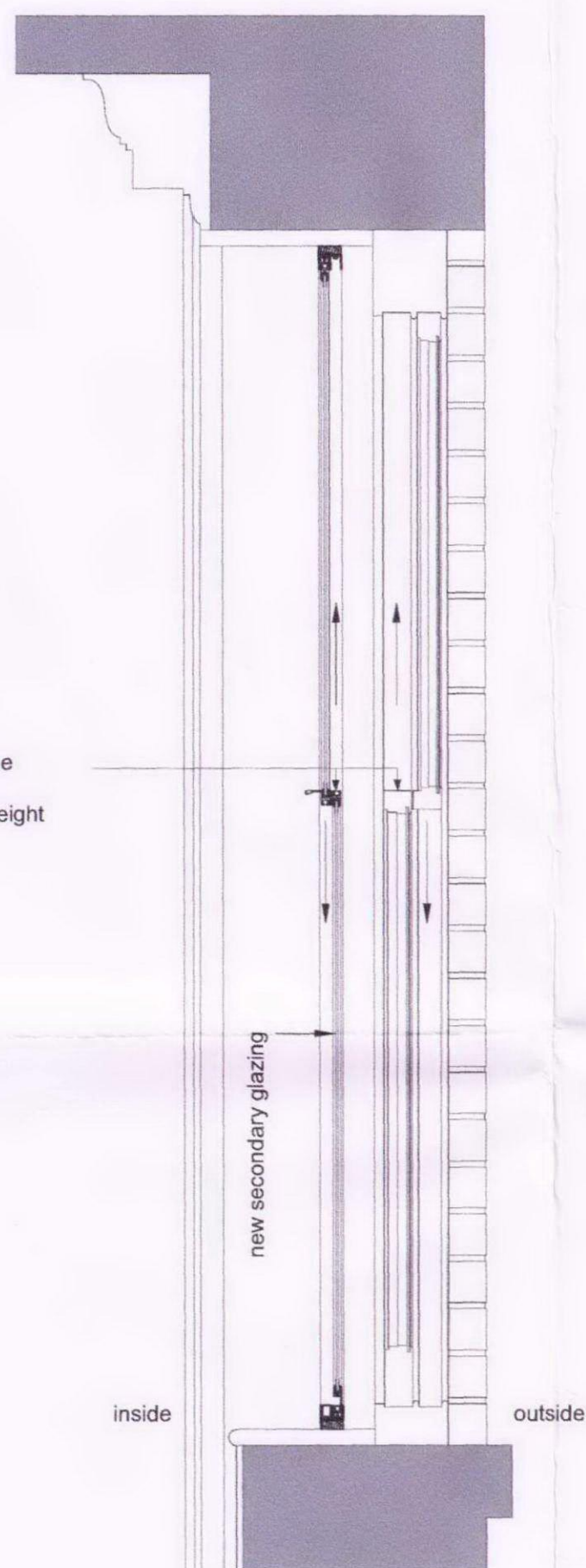

Vertical Section

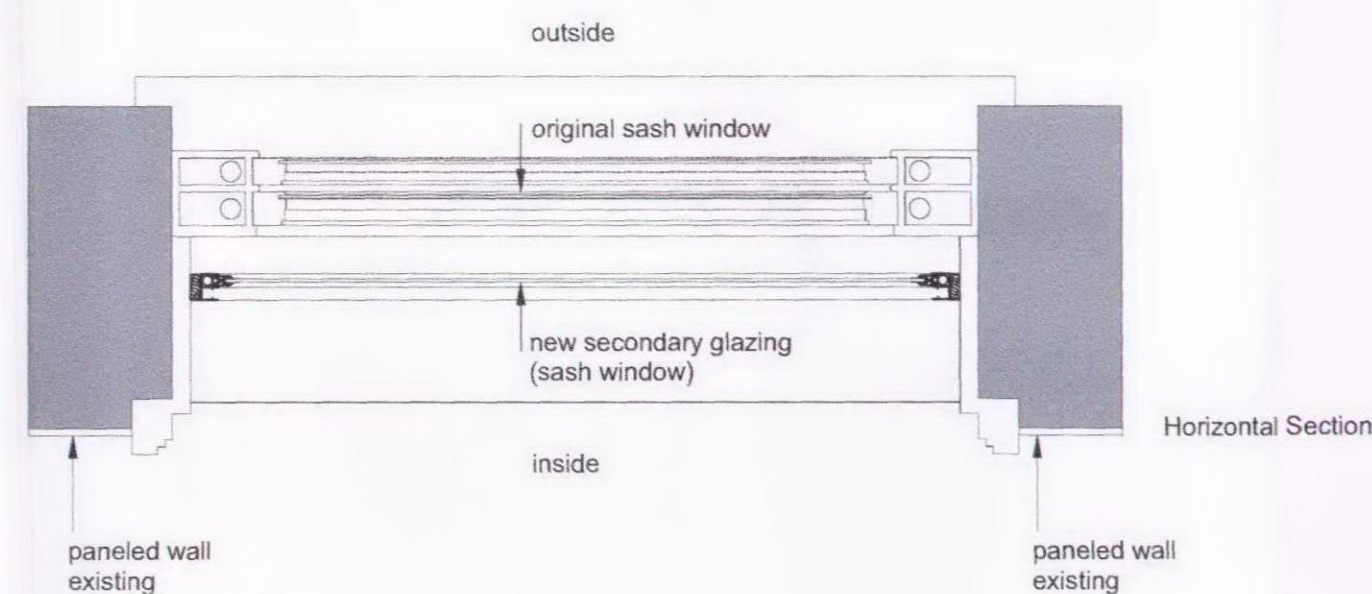

Horizontal Section

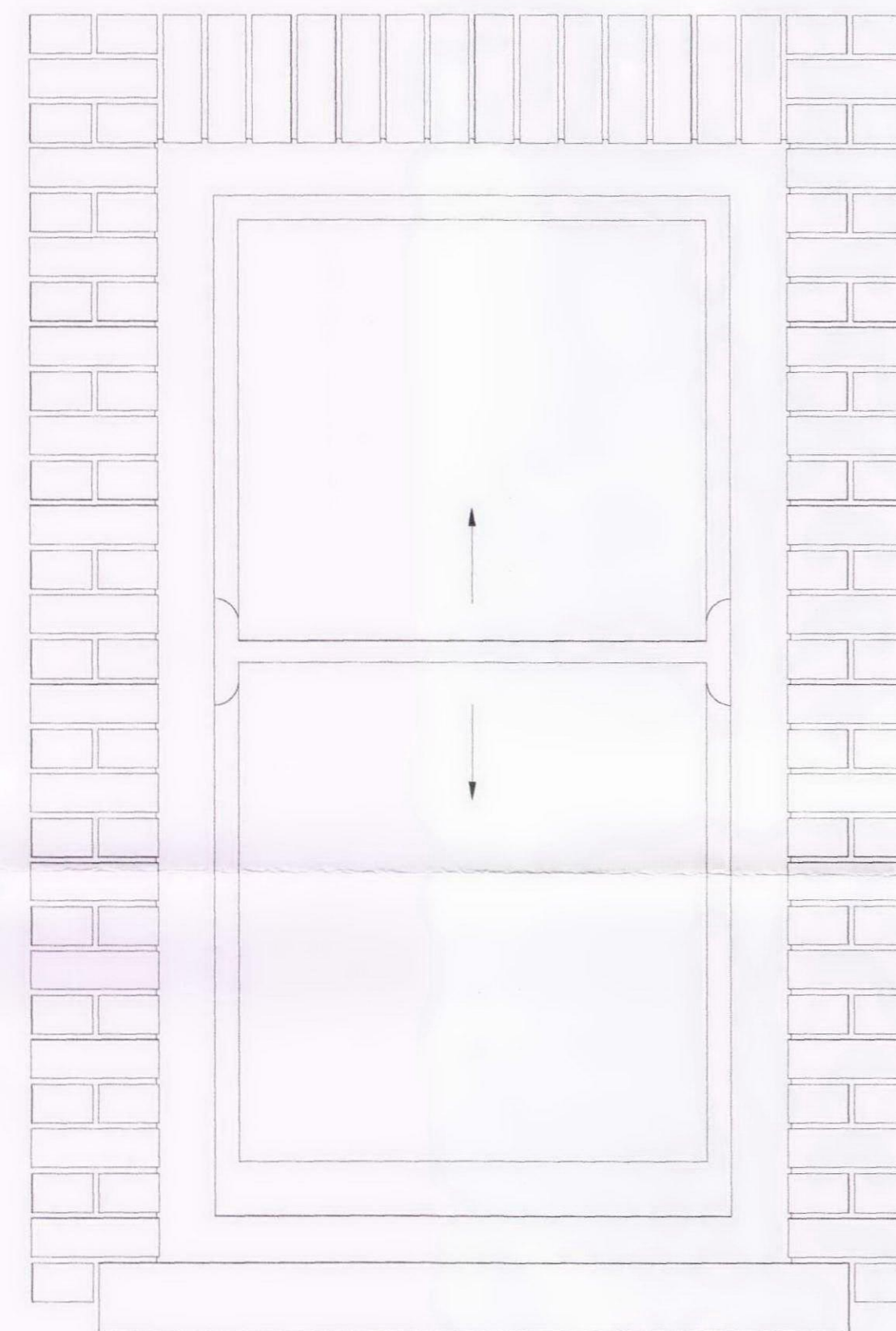

Elevation Outside
(no visual impact from outside elevation)

Secondary Glazing

Performance	Acoustic- Rated in accordance with BS EN ISO 717-1
Frames	Aluminium extruded from 6063T6 alloy
Finish	HIPCA White 9910 semi-gloss Polyester Powder Paint to BS 6496:1984 RAL colour Polyester Powder Paint / Anodised silver AA10 / Anodised bronze AA25
Glazing	4mm to 8mm
Acoustic lining	Mineral fibreboard / pvc faced acoustic foam / Rockwool filled perforated metal trays
Fixing	zinc plated steel
Sealants	grounds and frames bedded in acrylic compound

- General Notes
1. Dimensions are in millimetres unless stated otherwise
 2. All levels are in metres above AOD unless stated otherwise
 3. Dimensions govern. Do not scale off of drawing
 4. All dimensions to be verified on site before proceeding
 5. All discrepancies to be notified in writing to Schmidt-Hess Architects

00 27.11.09 For Planning

Rev Date Reason For Issue

Key Plan

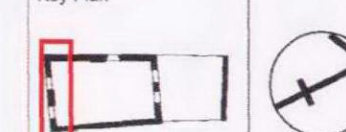

Client

Albert Hay

Project

19 Hampstead High Street
London NW3

Project No Drawing No Rev.

009 A4010 00

Drawing Title
Secondary Glazing
Windows facing
Hampstead High Street
First & Second Floor

Scale 1:10

Paper Size @A2

Date 27.11.2009

SCHMIDT-HESS ARCHITECTS

24 Newburgh Street
London EC1V 1JY
t: +44 (0)20 3883 4170
www.sh-a.co.uk
info@sh-a.co.uk