

- ① ATM to be fitted through new glass panel
- ② Ambient lighting around ATM to be at least 200 lux
- ③ Illuminated signage
- ④ Standard 'bisel' surround
- ⑤ New ATM type Triton RT2000 to be installed through new opening in position shown

Note:
All dimensions are approx

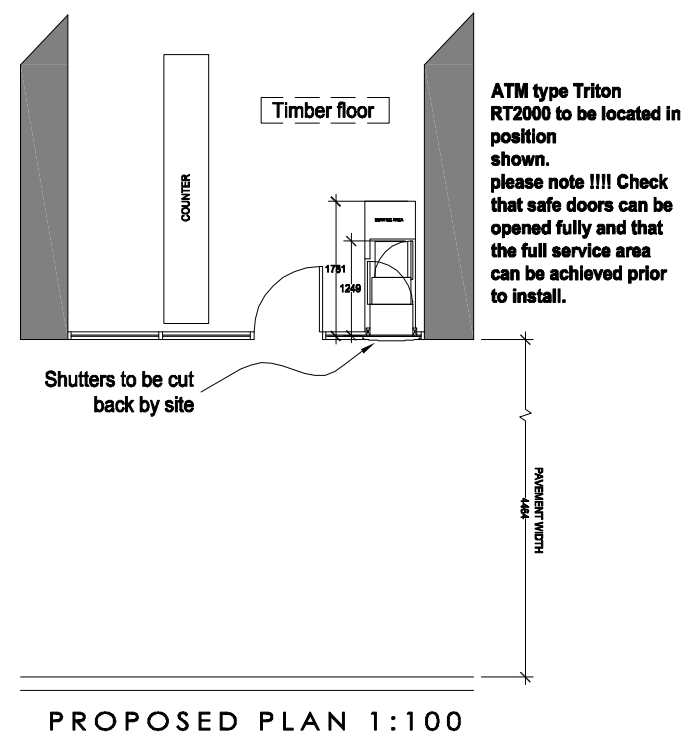
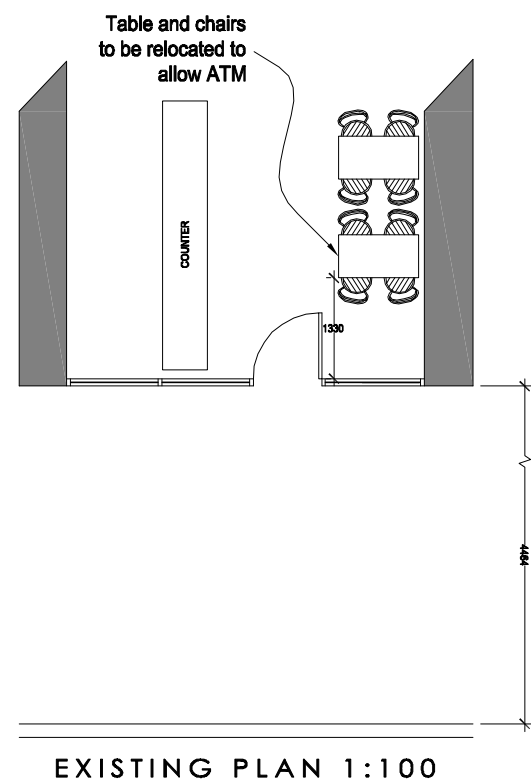

Site Name: Marathon Kebab House

Site Ref: CP0902

Drawn: Martin Burton

Date: 27/11/2009

Site Address: Marathon Kebab House

87 Chalic Farm Road

Camden

NW1 8AR

Client:



KINGS SECURITY SYSTEMS
FIRE DIVISION
Unit 4, St Dunstons Technology Par
Off Ripley Street,
Bradford, BD4 7HH
01274 377575
martin.burton@kingsltd.co.uk