

Cutback Analysis

N  
Indicative

NO DIMENSIONS TO BE SCALED  
FROM THIS DRAWING:

Existing    Surrounding  
Proposed      
Buildings Highlighted

**SOURCE DATA**

Drawings Used:  
Surrounding buildings:  
On Centre Surveys:  
Dwg No's: Elevation 15876A-2, Land Survey 15876A-1.

Proposed Scheme:  
Harper Downie:  
Sketch Up model used.

Photos taken by Delva Patman Associates.

**NOTES**

Floor levels assumed.

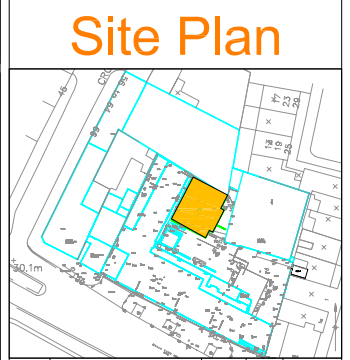

REV	Description	Drawn	Chkd	Date

**Delva Patman Associates**  
2 Henrietta Street London WC2E 8PS  
Tel: 020 7240 6004 Fax: 020 7240 7658  
E-mail: info@delvapatman.co.uk  
Chartered Surveyors Design Consultants

**TITLE:**  
NORDIC MEWS  
LONDON  
-  
-  
DAYLIGHT / SUNLIGHT ANALYSIS

**DRAWING:**  
Fitness First  
Cutback Analysis  
Key Building Heights  
Existing & Proposed Schemes  
-  
-  
-

DRAWN: KS	JOB NO:
SCALE: NTS	09225
DATE: 02/11/2009	REV:
DWG NO: SPT/800	-