

- NOTES
- 1 - COPYRIGHT OF THIS DRAWING IS THE PROPERTY OF THE ARCHITECTS AND MAY NOT BE REPRODUCED WITHOUT THEIR PERMISSION
 - 2 - WRITTEN DIMENSIONS TO BE USED IN PREFERENCE TO SCALED DIMENSIONS AT ALL TIMES
 - 3 - ALL DIMENSIONS AND LEVELS TO BE VERIFIED BY THE CONTRACTOR ON SITE AND ANY DISCREPANCIES REPORTED TO THE ARCHITECTS
 - 4 - DRAWINGS ARE BASED ON THE ASSUMPTION THAT ADEQUATE LOAD BEARING CAPACITY STRUTUM WILL BE ENCOUNTERED AT THE DEPTHS INDICATED. IF THIS IS FOUND NOT TO BE THE CASE, THE DEPTHS MUST BE INCREASED TO THE SATISFACTION OF THE LOCAL AUTHORITY BUILDING INSPECTOR AND BUILDING REGULATION REQUIREMENTS
 - 5 - ALL STRUCTURAL TIMBER IS TO BE TANAISED OR SIMILARLY TREATED
 - 6 - D.P.C TO BE PLACED AT ALL CAVITY CLOSURES AND TO BE APPROVED BY THIS OFFICE PRIOR TO INSTALLATION
 - 7 - ALL DIMENSIONS INDICATED ON THIS DRAWING ARE STRUCTURAL DIMENSIONS AND DO NOT ALLOW FOR THICKNESS OF FINISHES

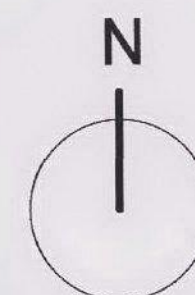
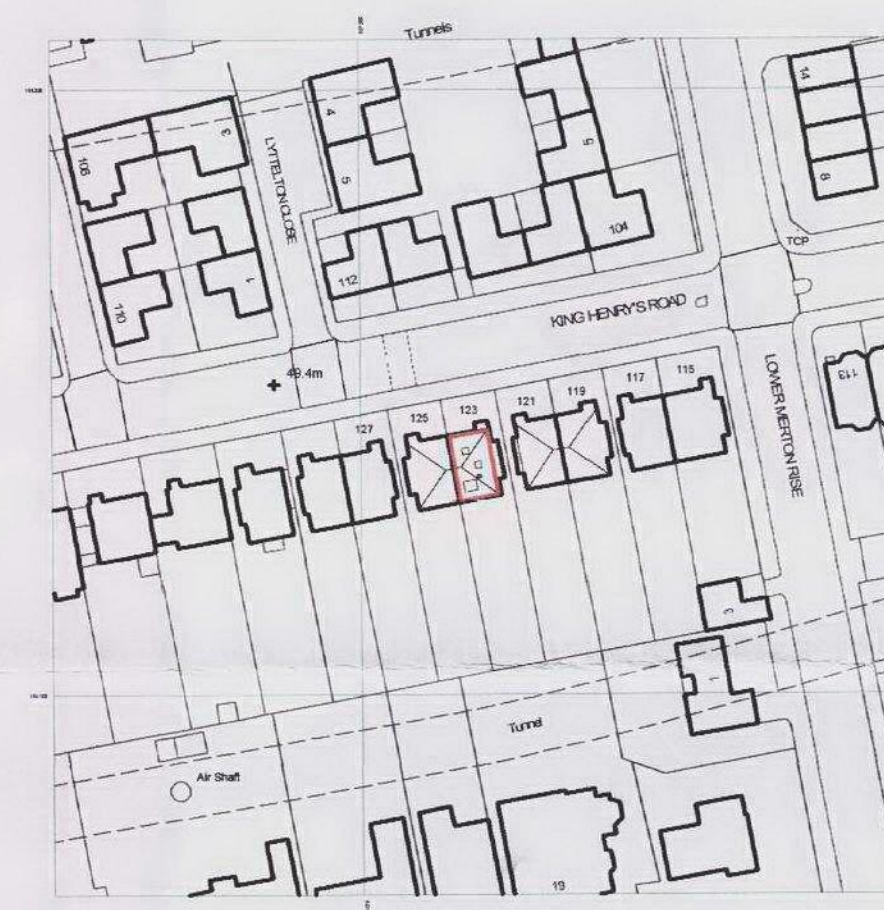

REV	DESCRIPTION	DATE

bellis | architects

Clerkenwell House, 67 Clerkenwell Road, London EC1R 5BL
t: 020 7831 2333 f: 020 7117 3183 www.bellisarchitects.com

CONTRACT

Flat 6
123 King Henrys Road
London NW3 3RB

DRAWING TITLE			
Site & Location Plan			
DRAWN BY	DATE	CHECKED	
DB	Nov '09		
SCALE			SHEET SIZE
1:500 & 1:1250			A2
DRAWING No			REV
0311/00			