

scales 1:50 @ A1
1:100 @ A3

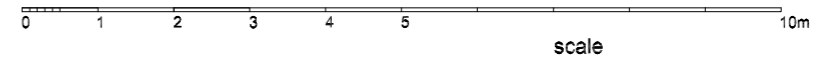
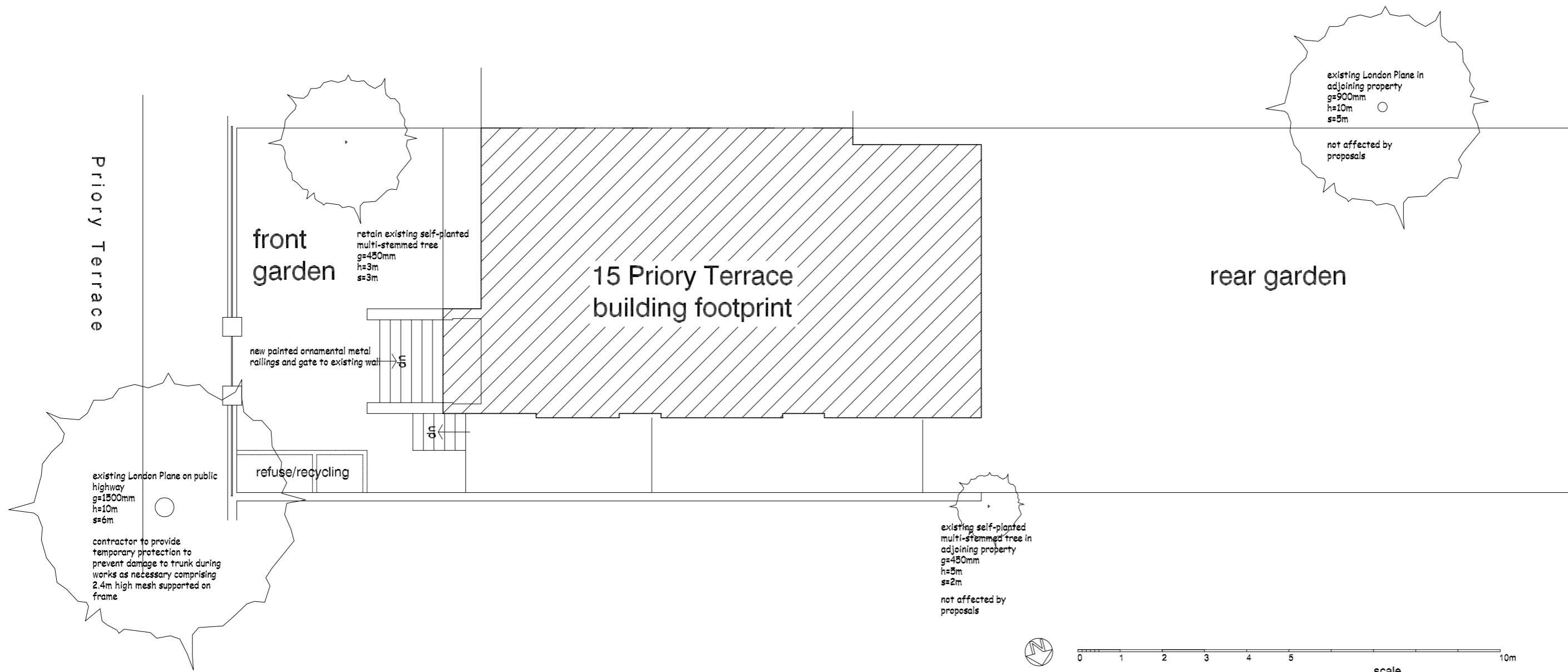

DVM
ARCHITECTS

4a Murray Street . London . NW1 9RE
Telephone 0207 485 2121 . Facsimile 0207 267 2527
e-mail: studio@dvmarch.com

Client
Mr and Mrs Rigg

Project
15 Priory Terrace
London NW6

Title
Site Plan
AS EXISTING

Scale 1: 50	Date 26.12.09	Job No. 1731
Drawing No. 1731/02		Rev.

All dimensions are to be checked on site.
© This drawing is copyright and remains the property of David & Victoria Macece
at all times and may not be reproduced in part or whole without written consent.